



City of Sanibel

**ADDENDUM NO. 4
May 7, 2026**

RE: Fishing Pier Temporary Repairs Project (ITB-BP-0-2026/JH) Proposal due date: May 28, 2026 @ 2:30PM

FROM: City of Sanibel
800 Dunlop Road
Sanibel, FL 33957

TO: Prospective Bidders and Others Concerned

This addendum is hereby incorporated into the bid documents of the project referenced above. The following items are clarifications, corrections, additions, deletions, and/or revisions to and shall take precedence over the original document.

A. Questions and Answers

Question No. 1: " To achieve 16" O.C spacing with the top rail fasteners, will hardware be fastened to the existing aluminum railing? If so, will the 4" Strong-Drive SDWS TIMBER SS HEAVY-DUTY STRUCTURAL FASTENER be used to make those connections? These are not typical for wood to metal connections "

Response No. 1: Please see updated Plans and Bid Tabulation below

Question No. 2: After reviewing the documents for the above mentioned project we are having trouble finding Pages SPE-1 through SPE-6 as assuming these pages contain forms to be filled out and submitted showing our company's similar jobs and evidence of experience.

Response No.2: Pages SPE-1 to SPE-6 are not included, please use your own reference form. Revised table below for clarification.

A. ACKNOWLEDGEMENT OF ADDENDA

- a. The Bidder shall acknowledge receipt of this addendum by completing the applicable section in the solicitation or by completion of the acknowledgement information on the addendum. Either form of acknowledgement must be completed and returned not later than the date and time for receipt of bid.
- b. All other terms, conditions and specifications of ITB-BP-0-2026/JH remain the same.
- c. Receipt acknowledged by:

Authorized Signature & Date Signed

Title

Name of Firm

STRUCTURAL INFORMATION:

1. **DESIGN CODE DATA:**
 - A. 2020-2021 INTERNATIONAL BUILDING CODE
 - B. 2023 FLORIDA BUILDING CODE, BUILDING
 - C. ASCE 7.22: MINIMUM DESIGN LOADS FOR BUILDINGS AND OTHER STRUCTURES
 - D. ANSI/APA NDS 2005: NATIONAL DESIGN SPECIFICATION FOR WOOD STRUCTURES
2. **DESIGN LOADS:**
 - A. **DEAD LOADS:**
 - DOCK: 20 PSF
 - LIVELOADS:**
 - DOCK: 100 PSF
 - B. **WIND DESIGN CRITERIA:**
 - WIND SPEED: 170 MPH (ULT)
 - WIND SPEED: 132 MPH (NOMINAL)
 - EXPOSURE: D
 - RISK CATEGORY: II
 - ENCLOSURE CLASSIFICATION: OPEN
 - INTERNAL PRESSURE COEFFICIENT: 0.00
3. **MAXIMUM ALLOWABLE DEFLECTION CRITERIA:**
 - DECK: L/360 LIVE LOAD; L/240 TOTAL LOAD

144 PERIWINKLE WAY

FISHING PIER TEMPORARY REPAIRS PENDING FULL REPLACEMENT

LEE COUNTY

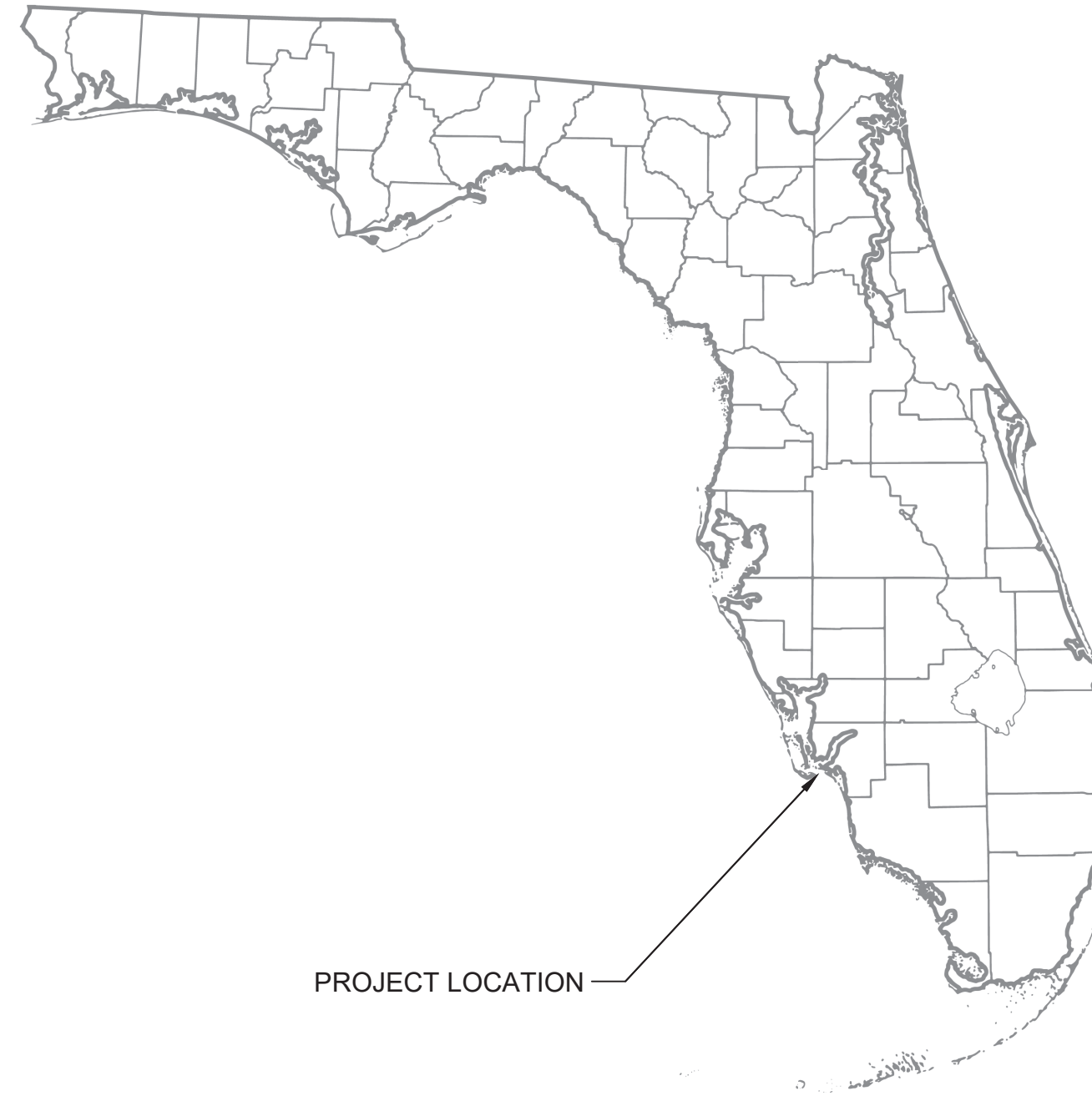

SUBJECT PROPERTY:

CITY OF SANIBEL
144 PERIWINKLE WAY
SANIBEL, FL 33957

PARCEL NUMBER: 1-46-23-T2-00038.0000
LAT/LONG: 26°27'17.01"N 82° 0'55.88"W
WATERWAY: SAN CARLOS BAY

DESIGN INFORMATION:

MEAN HIGH WATER (MHW) NAVD88: +0.18'
MEAN LOW WATER (MLW) NAVD88: -1.5'

SHEET INDEX

- S-1 COVER SHEET
- S-2 PLAN & PROFILE
- S-3 DETAILS 1
- S-4 DETAILS 2

REVISION DATES:

R1 5/7/2026
ADDENDUM NO. 4

THIS ITEM HAS BEEN DIGITALLY SIGNED AND SEALED BY CLAY MCCOY P.E., ON THE DATE ADJACENT TO THE SEAL.

SIGNATURE MUST BE VERIFIED ON ANY ELECTRONIC COPIES.
CLAYTON T MCCOY
Digitally signed by CLAYTON T MCCOY
Date: 2026.05.07 10:13:14 -05'00'
5/7/2026

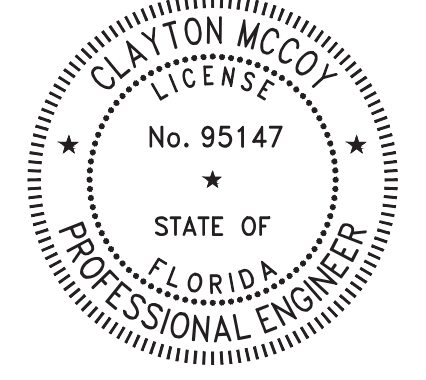

FISHING PIER TEMPORARY REPAIRS PENDING FULL REPLACEMENT

COVER SHEET

DRAWN BY:
CLAYTON MCCOY, PE

CHECKED BY:
ASA HUNT, PE

EOR:
CLAYTON MCCOY, PE

NO.	DESCRIPTION	DATE
-----	-------------	------



CLAYTON MCCOY, PE
PE LICENSE NO 95147
25 W CEDAR ST, SUITE 140
PENSACOLA, FL 32502

SUBJECT PROPERTY:
CITY OF SANIBEL
144 PERIWINKLE WAY
SANIBEL, FL 33957

PROJECT NO.
FL-2026-090

DATE
5/7/2026

SCALE
N/A

SHEET
S-1

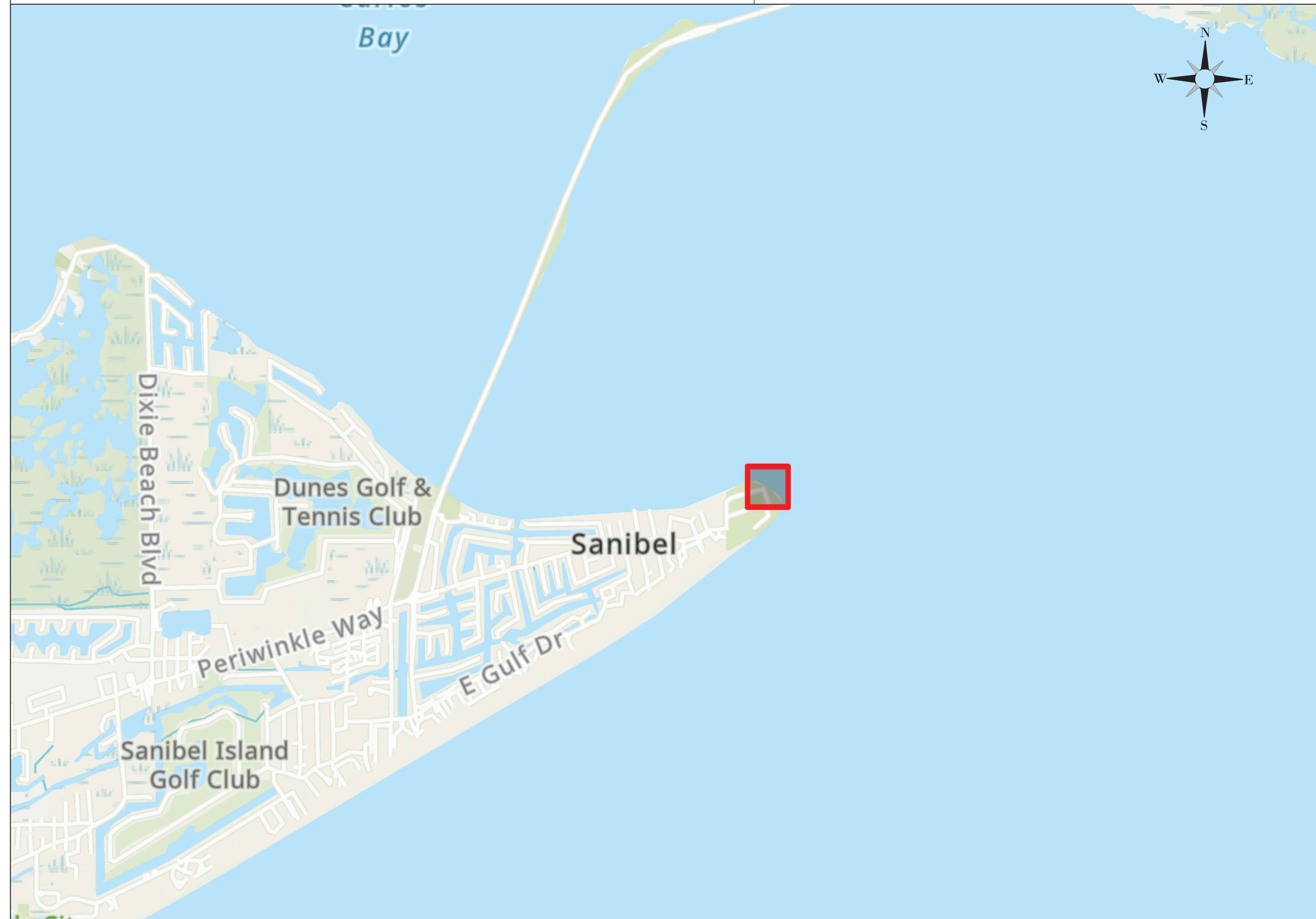

FISHING PIER TEMPORARY REPAIRS PENDING FULL REPLACEMENT

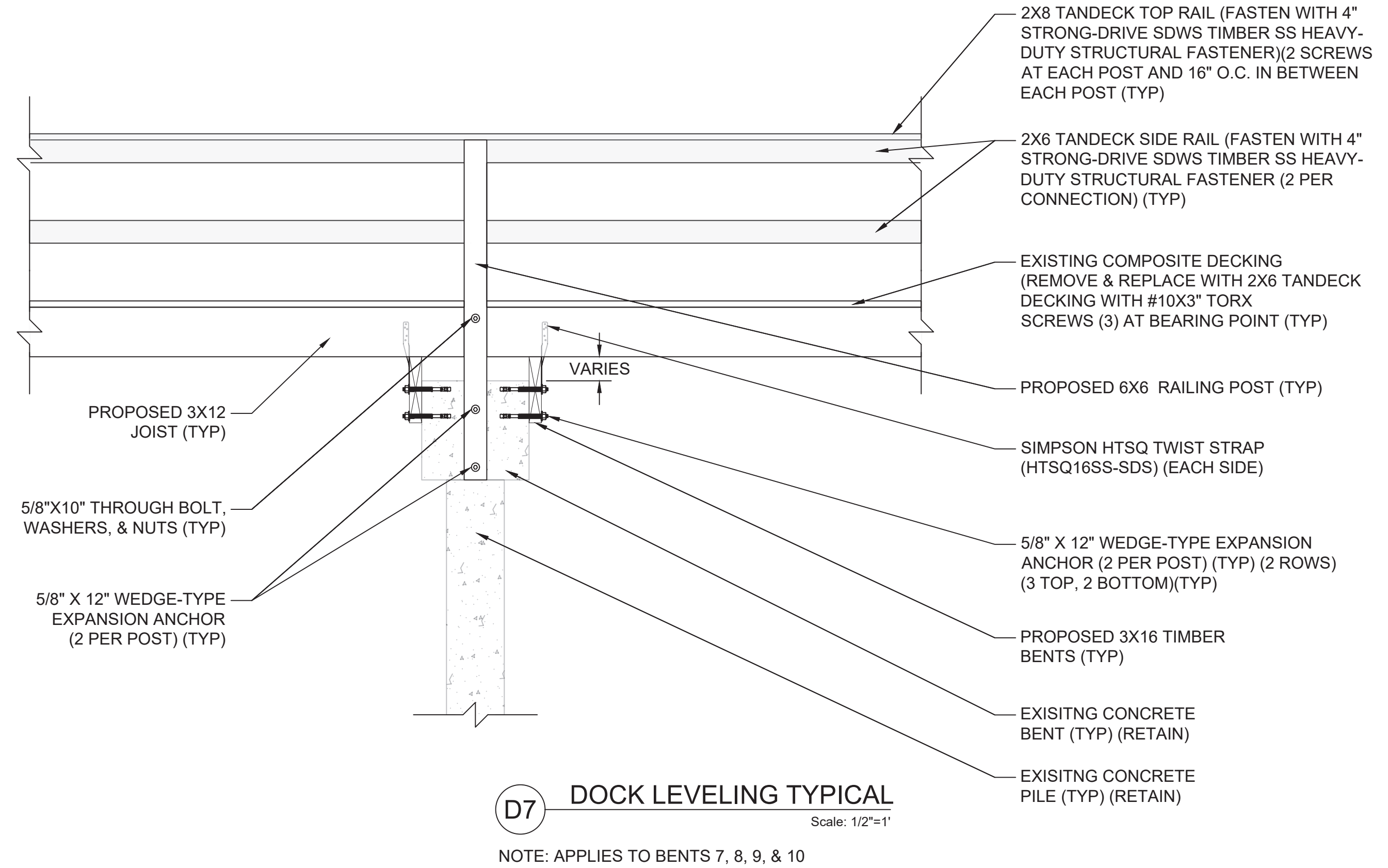
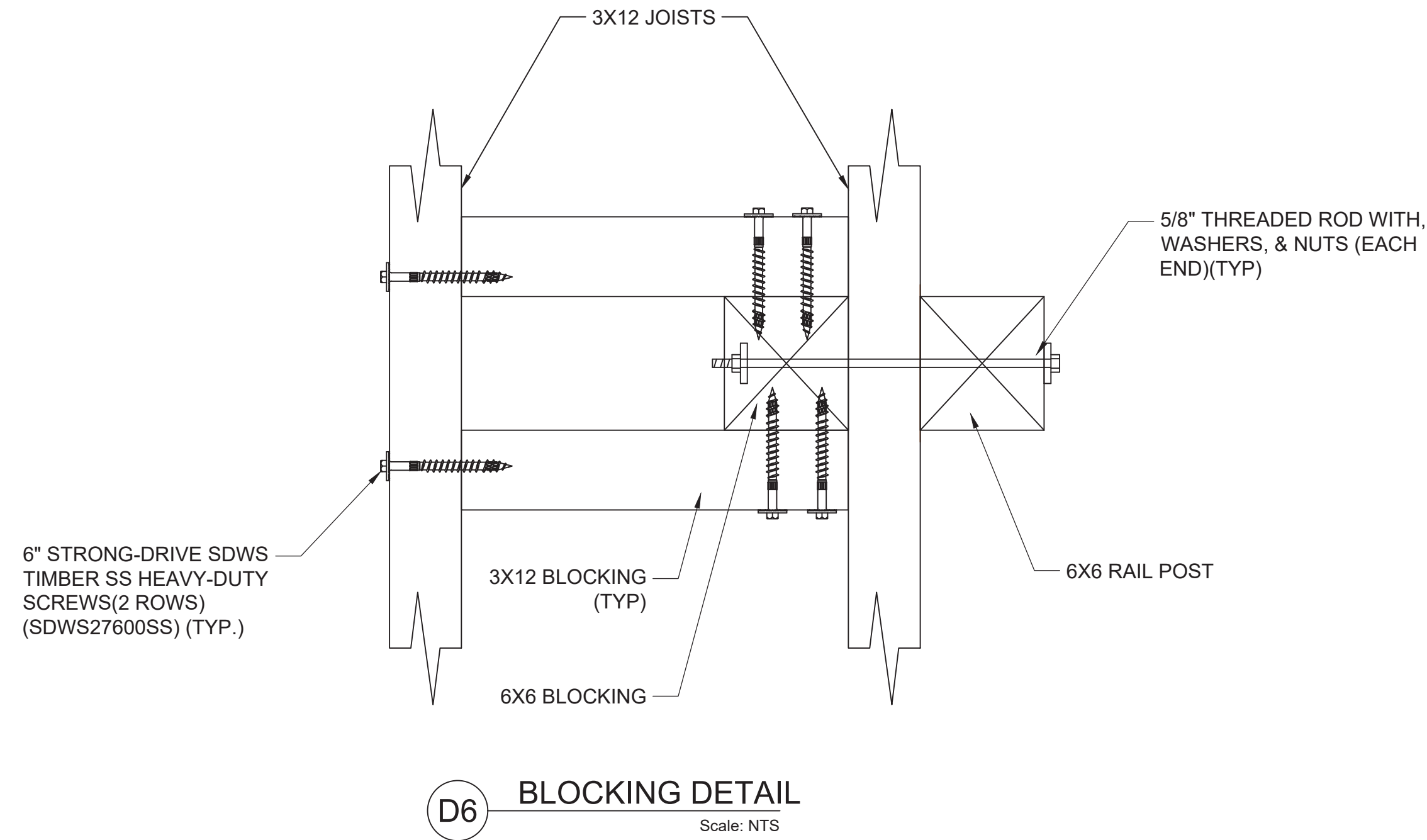

PROJECT DESCRIPTION:

THE PROJECT CONSISTS OF REMOVING THE DAMAGED ALUMINUM RAILING AND REPLACING IT WITH A NEW WOOD RAILING SYSTEM. THE EXISTING WOOD SUBSTRUCTURE AND DECKING BETWEEN BENTS 6 THROUGH 11 WILL BE REMOVED AND REPLACED. ALL EXISTING 6X6 POSTS WITHIN THE PROJECT LIMITS SHALL BE REMOVED AND REPLACED WITH NEW TREATED TIMBER POSTS. A NEW ADA-COMPLIANT WOOD ACCESS RAMP WILL BE CONSTRUCTED TO PROVIDE ACCESS TO THE ELEVATION OF THE EXISTING PIER. IN ADDITION, DAMAGED DECKING ON THE TERMINAL PLATFORM WILL BE REPLACED. THE PROJECT ALSO INCLUDES A COMPREHENSIVE INSPECTION OF ALL EXISTING HARDWARE, WITH TIGHTENING OR ADJUSTMENT PERFORMED AS NECESSARY TO ENSURE OVERALL STRUCTURAL INTEGRITY.

PROJECT NOTES:

1. THE CONTRACTOR SHALL PROMPTLY NOTIFY THE ENGINEER OF ANY DISCREPANCIES BETWEEN THE DRAWINGS AND SITE CONDITIONS. NO WORK SHOULD PROCEED IF DISCREPANCIES OR OMISSIONS ARE DISCOVERED WITHOUT CONSULTING THE ENGINEER.
2. THE CONTRACTOR IS RESPONSIBLE FOR PROTECTING ADJACENT PROPERTIES, SURFACES, AND PUBLIC AREAS FROM DAMAGE DURING CONSTRUCTION. APPROPRIATE SEDIMENT AND EROSION CONTROL MEASURES MUST BE IMPLEMENTED TO SAFEGUARD THE SURROUNDING ENVIRONMENT, AS REQUIRED BY LOCAL AND STATE REGULATIONS.
3. TURBIDITY BARRIERS SHALL BE PLACED BEFORE CONSTRUCTION BEGINS AND SHALL ONLY BE REMOVED UNTIL AFTER CONSTRUCTION HAS BEEN COMPLETED AND SEDIMENT LOADS RETURN TO AMBIENT LEVELS.
4. NO REVISIONS OR ALTERATIONS MAY BE MADE TO THESE PLANS WITHOUT WRITTEN AUTHORIZATION FROM THE ENGINEER OF RECORD.
5. THE CONTRACTOR SHALL VERIFY ALL DIMENSIONS, DETAILS AND JOB SITE CONDITIONS PRIOR TO COMMENCING WORK AND NOTIFY THE ENGINEER OF RECORD FOR ANY DISCREPANCIES.
6. THE CONTRACTOR SHALL PROVIDE ALL MEASURES NECESSARY TO PROTECT THE STRUCTURE, WORKMEN, AND ALL OTHER PERSONS DURING CONSTRUCTION.
7. THE ENGINEER IS RESPONSIBLE FOR THE STRUCTURAL ITEMS IN THESE PLANS ONLY. SHOULD ANY CHANGES BE MADE FROM THE DESIGN AS SPECIFIED IN THE CALCULATIONS WITHOUT APPROVAL FROM THE ENGINEER (I.E. ALTERATIONS TO THE STRUCTURAL SYSTEM OR ADDITION OF CONSTRUCTION MATERIALS OR LOADS), THE ENGINEER WILL ASSUME NO RESPONSIBILITY FOR ANY ELEMENT OR SYSTEM OF THE STRUCTURE.
8. THE ENGINEER IS RESPONSIBLE FOR THE STRUCTURAL ITEMS IN THESE PLANS ONLY. SHOULD ANY CHANGES BE MADE FROM THE DESIGN AS SPECIFIED IN THE CALCULATIONS WITHOUT APPROVAL FROM THE ENGINEER (I.E. ALTERATIONS TO THE STRUCTURAL SYSTEM OR ADDITION OF CONSTRUCTION MATERIALS OR LOADS), THE ENGINEER WILL ASSUME NO RESPONSIBILITY FOR ANY ELEMENT OR SYSTEM OF THE STRUCTURE.

SPECIFICATIONS:

HARDWARE:

5/6/2026 R1

1. ALL HARDWARE SHALL BE 316 STAINLESS STEEL UNLESS OTHERWISE NOTED.
2. ALTERNATE BRANDS MAY BE USED IN PLACE OF THOSE LISTED WITHIN THE PLANS, PROVIDED THEY MEET OR EXCEED THE SPECIFIED MINIMUM REQUIREMENTS/SPECIFICATIONS.
3. CONTRACTOR TO INSPECT ALL EXISTING HARDWARE AND TIGHTEN ALL NUTS AND BOLTS ON EXISTING RAILING.
4. ALL METAL CONNECTIONS SHALL COMPLY WITH AISC SPECIFICATIONS AND SHALL BE INSTALLED IN STRICT ACCORDANCE WITH MANUFACTURER'S SPECIFICATIONS AND RECOMMENDATIONS AND THESE DRAWINGS.
5. EXISTING HARDWARE SHALL NOT BE REUSED.
6. ALL ABANDONED OR UNUSED DRILLED HOLES IN EXISTING CONCRETE SHALL BE THOROUGHLY CLEANED OF DUST, DEBRIS, AND LOOSE MATERIAL USING COMPRESSED AIR AND/OR BRUSHING. HOLES SHALL BE FILLED FLUSH WITH THE SURROUNDING SURFACE USING A STRUCTURAL EPOXY ADHESIVE OR EPOXY PATCHING COMPOUND SUITABLE FOR MARINE ENVIRONMENTS. SURFACE PREPARATION SHALL ACHIEVE A MINIMUM ICR CONCRETE SURFACE PROFILE (CSP) OF 3 TO 5, OR AS REQUIRED BY THE EPOXY MANUFACTURER. EPOXY SHALL BE INSTALLED IN STRICT ACCORDANCE WITH THE MANUFACTURER'S RECOMMENDATIONS TO ENSURE A WATER-TIGHT SEAL AND ADEQUATE BOND TO THE EXISTING CONCRETE.
7. ALL ABANDONED OR UNUSED DRILLED HOLES IN EXISTING CONCRETE SHALL BE THOROUGHLY CLEANED OF DUST, DEBRIS, AND LOOSE MATERIAL USING COMPRESSED AIR AND/OR BRUSHING. HOLES SHALL BE FILLED FLUSH WITH THE SURROUNDING SURFACE USING A STRUCTURAL EPOXY ADHESIVE OR EPOXY PATCHING COMPOUND SUITABLE FOR MARINE ENVIRONMENTS. SURFACE PREPARATION SHALL ACHIEVE A MINIMUM ICR CONCRETE SURFACE PROFILE (CSP) OF 3 TO 5, OR AS REQUIRED BY THE EPOXY MANUFACTURER. EPOXY SHALL BE INSTALLED IN STRICT ACCORDANCE WITH THE MANUFACTURER'S RECOMMENDATIONS TO ENSURE A WATER-TIGHT SEAL AND ADEQUATE BOND TO THE EXISTING CONCRETE.

WOOD TREATMENT LEVEL:

1. ALL LUMBER SHALL BE PRESSURE TREATED SOUTHERN YELLOW PINE.
2. PILE BENTS & STRINGERS SHALL BE TREATED TO 2.5 CHROMATED COPPER ARSENATE (CCA)
3. RAILING SHALL BE TREATED TO 0.60 COPPER QUAT (ACQ).

LUMBER SPECIFICATIONS:

1. ALL PILE BENTS AND STRINGERS SHALL BE ROUGH CUT.
2. RAILING POSTS SHALL BE DIMENSIONAL.
3. RAILING POSTS (6X6) SHALL BE CENTERED ON EACH CONCRETE BENT WITH INTERMEDIATE POSTS (6X6) CENTERED BETWEEN EACH PILE BENT.
4. SPLICES IN BEAMS AND JOISTS ARE NOT ALLOWED BETWEEN SUPPORTS.
5. ALL STRUCTURAL LUMBER SHALL BE #1 GRADE

DECKING:

1. DECKING TO BE 2X6 (1-1/2" X 5-1/2") TANDECK COMPOSITE MANUFACTURED BY TANGENT TECHNOLOGIES, LLC. COLOR TO BE SELECTED BY THE CITY.

UTILITIES:

1. THE CONTRACTOR MUST VERIFY THE LOCATION OF EXISTING UTILITIES BEFORE BEGINNING ANY EXCAVATION OR CONSTRUCTION ACTIVITIES.
2. ELECTRICAL AND PLUMBING IF REQUIRED TO BE DESIGNED BY OTHERS.

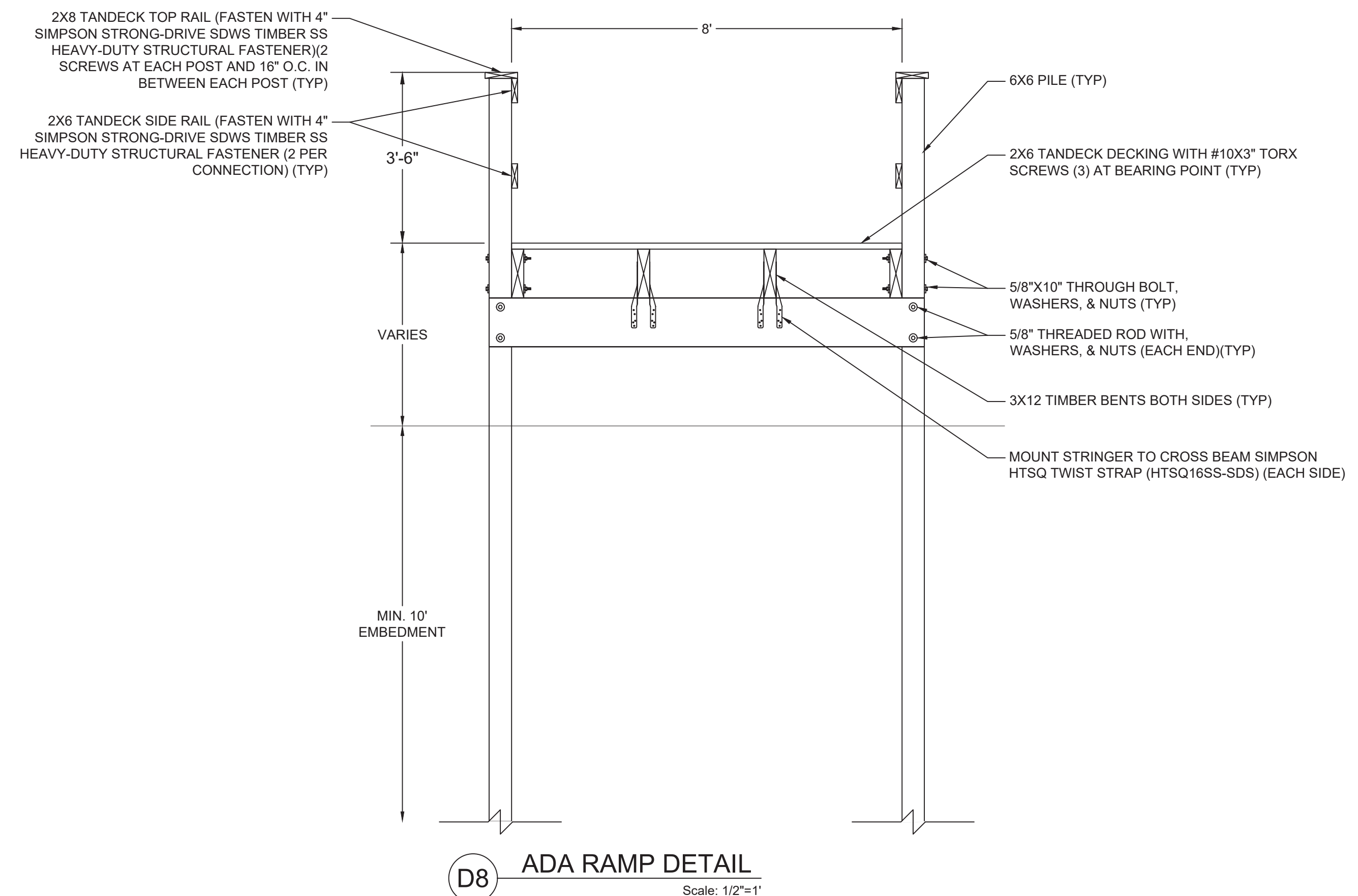

REVISIONS:

R1 - 5/7/2026 - CHANGED NOTE

ADDENDUM NO. 4

THIS ITEM HAS BEEN DIGITALLY SIGNED AND SEALED BY CLAYTON MCCOY P.E., ON THE DATE ADJACENT TO THE SEAL.

SIGNATURE MUST BE VERIFIED ON ANY ELECTRONIC COPIES.

5/7/2026

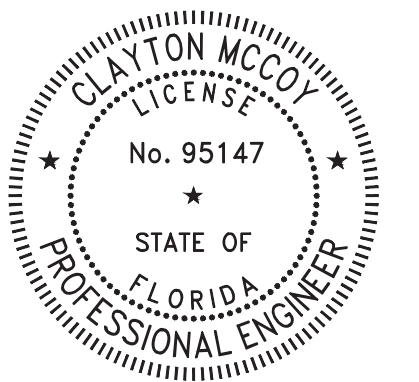

FISHING PIER TEMPORARY REPAIRS PENDING FULL REPLACEMENT

DETAILS 2

DRAWN BY:
CLAYTON MCCOY, PE

CHECKED BY:
ASA HUNT, PE

EOR:
CLAYTON MCCOY, PE

NO.	DESCRIPTION	DATE



CLAYTON MCCOY, PE
PE LICENSE NO 95147
25 W CEDAR ST, SUITE 140
PENSACOLA, FL 32502

SUBJECT PROPERTY:
CITY OF SANIBEL
144 PERIWINKLE WAY
SANIBEL, FL 33957

PROJECT NO.
FL-2026-090

DATE
5/7/2026

SCALE
SEE SHEET

SHEET

S-4



CITY OF SANIBEL
FISHING PIER TEMPORARY REPAIRS
PENDING FULL REPLACEMENT

BID OPENING
 May 28, 2026 @ 2:30 P.M.

PAY ITEMS						
Item No.	Quantity	Unit	Description	Unit Price (Words)	Unit Price \$ (Figures)	Extended Price \$ (Figures)
1	1	LS	Mobilization/Demobilization (Max 5%)		\$	\$
2	664	SF	Deck Demolition		\$	\$
3	398	LF	Pressure Treated Lumber 3" x 12" 2.5 PCF CCA (Rough Cut)		\$	\$
4	104	LF	Pressure Treated Lumber 3" x 16" 2.5 PCF CCA (Rough Cut)		\$	\$
5	427	LF	6" X 6" Posts/Piles 0.60 PCF ACQ (Dimensional)		\$	\$
6	872	SF	Tandeck 2x6 Decking		\$	\$
7	465	LF	Tandeck 2X8 Top Rail		\$	\$
8	612	LF	Tandeck 2X6 Side Railing		\$	\$
9	1	LS	Existing Railing Hardware Inspection & Tighten All Hardware		\$	\$
10	1	LS	Existing Hardware Replacement		\$	\$
11	1	LS	Materials (Fasteners, Straps, Bolts, Screws, etc.. - 316 Stainless Steel)		\$	\$
12	1	LS	Owner's Contingency		\$ 25,000.00	\$ 25,000.00
13	32	LF	Pressure Treated Lumber "2x8" 2.5 PCF		\$	\$
PROJECT TOTAL						\$

City of Sanibel
Required Bid Items

**Fishing Pier Temporary Repairs
Pending Full Replacement**

May 28, 2026 @ 2:30p.m.

No.	Name	Page Reference
1	Bid Package in sealed envelope marked with Title of Bid, Bid Number, Name & Address of Bidder	Cover page Invitation to Bid
2	Complete Proposal on form provided	Pages A-1 and P-1 through P-4
3	Complete Unit Price Proposal	Pages P-1 through P-4
4	Complete Similar Project Experience	Pages SPE 1 through SPE 6
5	Include Certified Check or Bid Bond 5% or more of total bid price	Pages A-1 and IB-4
6	Acknowledge issued addenda on page 2 of Proposal Form	Pages IB-2, P-2, GC-1
7	Letter or statement from Bidder's surety company it will execute and deliver a 100% Performance and Payment Bond	Page IB-3
8	Furnish evidence they have ability & experience, have sufficient capital and plant, and minimum 5-years of experience	Page IB-4, Pages SPE 1 through SPE 6