

QUALIFICATIONS TO PROVIDE

City of Sanibel

ENGINEERING SERVICES FOR SANIBEL ROADS
RECONSTRUCTION PROJECT

NOVEMBER 13, 2025 | CCNA-PW-1-2026/BS



JOHNSON
ENGINEERING
— An Apex Company —

I. Cover Letter

2. Qualifications & Experience of Person(s) Assigned to Project |

3. Experience of Firm 30

4. Capacity of Firm 32

5. Required Forms





November 13, 2025

Office of the City Engineer
City of Sanibel, Public Works Bldg
800 Dunlop Road
Sanibel, FL 33957

Re: Engineering Services for Sanibel Roads Reconstruction Project, CCNA-PW-I-2026/BS

Dear Selection Committee:

Johnson Engineering is honored to submit our proposal for the City of Sanibel's roadway reconstruction project funded through the CDBG-DR program. As a local firm with deep roots in Southwest Florida and decades of service to Sanibel, we understand the urgency and complexity of restoring approximately 60 miles of roadway following Hurricane Ian. Our team is committed to delivering a design that meets federal compliance standards, stays within budget, and accelerates recovery for the community.

Our Approach

We have developed a strategy tailored to the City's goals and grant requirements. Leveraging advanced technologies such as Unmanned Aircraft Systems (UAS) for high-resolution surveying and mapping, we will minimize traffic disruptions during data collection and expedite design within the six-month timeframe outlined in the grant agreement. We will implement a prioritization process for categorizing improvements and use of deductive bid alternates to ensure flexibility and cost control throughout procurement.

Experience & Qualifications

Johnson Engineering brings extensive experience in federally funded roadway projects, including recent large scale rehabilitation projects for Hendry County and the Lee County Port Authority. These projects required strict adherence to grant standards, demonstrating our ability to manage similar scale projects in an effective manner. Our team includes specialists in roadway design, drainage, environmental, Construction Engineering and Inspection (CEI) surveying, and grant administration.

Capacity & Resources

With a staff of seasoned professionals and the financial strength to manage concurrent municipal workloads, we are fully prepared to prioritize Sanibel's needs without delay. Our recent merger with Apex Companies expands our resources to nearly 1,800 professionals, including Weiler Engineering, whose CDBG and roadway experience will provide additional support for the accelerated schedule if needed.

We value our long-standing partnership with the City and look forward to contributing to its recovery and future resiliency. Thank you for considering Johnson Engineering for this important project.

Sincerely,
JOHNSON ENGINEERING, LLC.

John Glenn, PE, Project Manager
(239) 334-0046

jglenn@johnsoneng.com

Special Considerations

1. **Conflict of Interest & Business Relationship Disclosure**
 - Johnson Engineering has no conflicts of interest or business relationships to disclose in accordance with F.S. 112.313.
2. **Public Records Compliance Statement (Florida Statute 119.0701)**
 - Johnson Engineering will:
 - Maintain records as required.
 - Provide access when requested.
 - Transfer records to City upon contract completion.
3. **Federal Grant Compliance Certifications (2 CFR Part 200, FEMA/FDEP rules)**
 - Johnson Engineering will maintain:
 - 2 CFR Part 200 (Uniform Guidance)
 - FEMA/FDEP requirements
 - Any procurement, cost allowability, and record-keeping provisions.
4. **Lobbying, EEO, and Civil Rights Act Certifications**
 - Johnson Engineering certifies compliance with the Byrd Anti-Lobbying Amendment, Equal Employment Opportunity requirements, and the Florida Civil Rights Act, as applicable.
5. **Suspension/Debarment Certification**
 - The principals and affiliates of Johnson Engineering are not suspended, debarred, or otherwise excluded from federal contracts.
6. **Cone of Silence / No Lobbying Statement**
 - Johnson Engineering acknowledges and will comply with the City's prohibition on lobbying staff or council during the RFQ process.

2. Qualifications and Experience of Person(s) Assigned to the Project





COMPANY OVERVIEW

Depth of Experience

Centuries of combined experience has immersed our team of licensed professionals into Florida's geography, giving us a rare perspective into development of the area and an appreciation of the changes.

Full Range of Services

Specialized teams of licensed engineers, land planners, landscape architects, surveyors, ecologists, water resources experts, transportation, and utility designers provide numerous aspects needed to complete your projects.

Long Term Commitment

Our team's average tenure with Johnson Engineering is 13 years. More than half of our employees have been with us for more than 10 years, 20% have been with us for more than 20 years, and an unprecedented 11% have been with us for more than 30 years, showing our team's commitment and dedication.

Local Knowledge

We can provide invaluable historical data and our conveniently located offices allow us to provide prompt service and communication through every step of your project.

Just as Florida has transformed dramatically over the years, so has Johnson Engineering. What started in 1946 as one man surveying Southwest Florida, has developed into a large cohesive team of more than 130 local professional civil engineers, ecologists, scientists, geologists, surveyors and mappers, certified land planners, and landscape architects, offering their expertise in a broad spectrum of engineering disciplines.

Johnson Engineering has been helping guide private companies, and city, county, and state governmental institutions through these changes and the challenges they create. Our extensive list of well-known roads, airports, schools, hospitals, resorts, residential communities, shopping centers, and commercial developments show our experience and continued responsibility in developing Florida's communities.

Headquartered in Fort Myers, Florida, the company also has local offices in Naples, Port Charlotte, LaBelle, and Clewiston.

In 2024, Johnson Engineering, along with Weiler Engineering Corporation (WEC), were acquired by Apex Companies, LLC. Our resources and capabilities have expanded while our core team and values have remained the same. This has only strengthened our ability to serve our clients with the same level of dedication and responsiveness that you have come to expect from us.



IN-HOUSE CAPABILITIES SUMMARY

Our experienced team of professionals include civil engineers, ecologists, scientists, geologists, surveyors and mappers, certified planners, and landscape architects, offering their expertise in a broad spectrum of engineering disciplines. As a multi-discipline consulting firm, permitting with local, state, and federal agencies is something our team excels at. It is a vital component to helping our clients' projects come to fruition.

Land Development



Project Management / Coordination • Due Diligence
Site Design • Cost Estimation • Permitting
Construction Observation & Administration
Single Family Communities • Multi-Family Residential
Assisted Living • Commercial • Industrial • Medical
Institutional • Educational • Recreational

Planning



Feasibility & Assessment Studies • Master Planning &
Urban Design • Neighborhood & Sector Planning
Comprehensive Planning & Zoning • Facility Planning
Corridor Planning • Local Government Planning
Public Engagement • GIS Services
Code Writing Redevelopment Planning

Surveying & Mapping

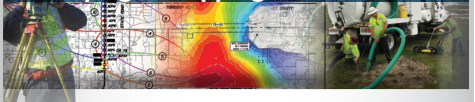

Subsurface Utility Engineering & Mapping (SUE)
Hydrographic Surveying • Transportation Surveying
Bathymetric Surveying • ALTA Surveys
Boundary Surveys • Construction Layout
Platting • Record Surveys
Sketches and Legal Descriptions

Ecological/Environmental Consulting

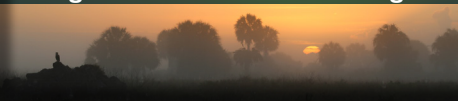

Wetland Delineation, Assessments & Permitting
Protected Species Surveys, Permitting & Relocations
Mitigation Design & Monitoring
Marine & Coastal Environmental Services
Airport Wildlife Hazard Services
Drone Services
Geographic Information Systems

Stormwater Management



Surface Water Master Planning • Surface Water
Retrofit • BMP Selection and Design
Hydrologic, Hydraulic & Water Quality Modeling
Federal, State and Local Surface Water Permitting
Flow & Stage Monitoring • Water Quality Treatment
Special Governments • Filter Marsh Design

Water Quality Studies



Stormwater/Surface Water Quality Studies
Groundwater Quality Studies • Estuarine/Coastal
Water Quality Studies • Subaqueous Sediment
Characterization • TMDL Pollutant Loading
Determination • EPA Section 319 and FDEP SWAG
Assistance • Microbial Source Tracking • Quality
Assurance Project Plan • Non-point Source Evaluation

Water Supply



Hydrogeological Investigations
Water Resource Assessments • Water Use, Water
Supply System Permitting • Well & Wellfield Design
Regional Water Supply Planning
Groundwater Modeling • Deep Injection Wells
Alternative Water Supplies Studies

Environmental Assessment



Phase I Environmental Site Assessments (ESAs)
Phase II Environmental Site Assessments (ESAs)
NPDES Compliance Monitoring
Permit Compliance Monitoring and Reporting
Filter Marsh Efficiency Evaluation
Water Use Accounting Method Calibration
BMAP Nutrient Removal Project Assessment

Geographical Information Systems

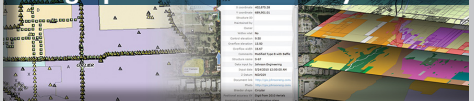

ESRI-based GIS Services • Mobile Online Map
(ArcGIS Online) • Custom Client Online Map Services
Geodatabase Development and Implementation
CAD-GIS-DGN Conversions • High Accuracy GNSS
(GPS) Data Collection • Advanced Modelbuilder
& Python Scripting • LiDAR Derivative Products
Cartographic Visualization • Aerial Photo Processing

Transportation Design



Roadway Design • Signalization Design
Resurfacing, Rehabilitation and Restoration
Street Lighting Design • Traffic Analyses
Roundabout Design • Signalization Design
Corridor Planning • Bicycle, Transit,
and Pedestrian Facilities

Construction Engineering & Inspection



Roadway Construction
Bridge Construction
Roadway Resurfacing Rehabilitation Restoration
Major Drainage Structures Construction
Private Development Construction Assistance
Grant Funded Construction Oversight / Compliance

Landscape Architecture

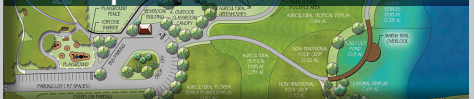

Landscape/Hardscape/Irrigation Design • Conceptual
Design • Commercial Design • Community
Revitalization & Amenity Design • Streetscape Design
Park Design • Visualization & Graphic Design
Construction Documents & Observation
Arboricultural Consulting Services • Plan Review
Services • Community/Institutional/Hospitality Design

Utilities



Utility Planning • Subsurface Utility Engineering (SUE)
Data Collection & Analysis • Hydraulic Modeling
Pipeline Design • Pump Station Design,
Evaluation, and Operational Controls
Utility Permitting • Project Management CEI

Electrical Engineering (EI&C)



Switchgear, Motor Control Centers, and Generators
Power Distribution Equipment • Lighting
Process & Industrial Control
Systems Integration and Commissioning
Electrical Systems Analysis (Short Circuit and
Protective Coordination)
SCADA Architecture, Networking & Telemetry

Special District Assistance



Stormwater Management • Water Use
Environmental • Planning
Landscape Architecture
Surveying & Mapping • Utilities
Roadway/Traffic Studies
Geographic Information Systems (GIS)
Construction Engineering & Inspection (CEI)

PROJECT UNDERSTANDING



The City of Sanibel has accepted \$12,460,000 from the US Department of Housing and Urban Development (HUD) through the Community Development Block Grant (CDBG) Disaster Relief (DR) program. The City is seeking qualified and experienced consultants to provide engineering design for approximately 60 miles of roadway resurfacing improvements throughout the island.

As a local firm whose employees witnessed firsthand the destruction caused by Hurricane Ian, Johnson Engineering is committed to helping bring the island one step closer to recovery.

To deliver such a large project within a tight timeframe, the selected consultant must have experience with large-scale roadway rehabilitation projects, a comprehensive understanding of grant procedures and requirements, access to appropriate technologies and resources, and a long-standing local presence. Johnson Engineering meets all these criteria.

Our team has reviewed the grant agreement, visited the project site, and developed a strategy to leverage our qualifications and experience to successfully complete this project.

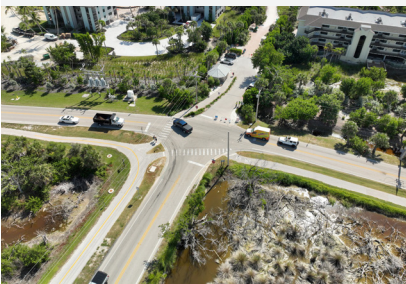
**Challenge #1: Efficient Data Collection and Minimizing Traffic Impacts**

The grant agreement outlines a 6-month design phase. Given the scope of improvements, rapid and efficient data collection is essential. Johnson Engineering utilizes Unmanned Aircraft Systems (UAS) mapping to acquire high-resolution aerial imagery, processed in-house to produce survey-controlled topographic data. This imagery supports identification of pavement conditions, surface cracking, and mapping of visible utilities and infrastructure.

Using UAS minimizes traffic disruptions by reducing the need for traditional survey crews in active roadways, thereby eliminating lane closures and traffic control during data collection.

**Challenge #2: Designing Improvements Within a Fixed Budget**

Our team has designed hundreds of lane miles of roadway improvements and understands how to deliver projects within grant funding limits. We implement a prioritization program following initial data collection and site visits. We will meet with the City to rank improvement needs and include alternative bids during procurement. Lower-ranked segments can be removed from the scope via deductive bid alternates, allowing flexibility in the final financial commitment.

Challenge #3: Navigating Federal Grant Compliance

This project requires adherence to federal requirements under the CDBG-DR program. Johnson Engineering has a proven track record of delivering grant-funded projects on time and under budget while maintaining compliance. Charles Reed, with over two decades of grant management experience including oversight for FDOT District I, joins our team to ensure seamless navigation of Davis-Bacon wage rate verification and other federal processes.

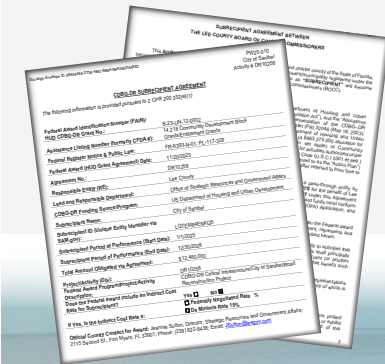



Challenge #4: Selecting a Pavement Rehabilitation Scheme to Achieve Desired Resiliency Improvements Within Grant Funding

With approximately \$12 million in funding and 60 miles of roadway improvements targeted, the available budget equates to \$200,000 per mile. Currently, a 1-inch mill and resurface for a two-lane undivided roadway costs about \$300,000 per mile, which exceeds the allocated funding.

The first step will be to **identify roadways in better condition where improvements can be deferred**, allowing resources to focus on segments requiring immediate attention. To optimize funding and achieve resiliency goals, a combination of rehabilitation methods should be considered based on roadway condition:

Overlay: Lower cost than full-depth reclamation; suitable for pavements with moderate distress.

Cold In-Place Recycling (CIR): Reuses existing materials; cost-effective for deeper structural issues.

Full Depth Reclamation (FDR): Ideal for severely distressed roads; highest cost but provides long-term durability.

Johnson Engineering brings extensive experience in both **designing and constructing** each of these rehabilitation methods, ensuring flexibility and efficiency in project delivery.



Challenge #5: Selecting a Pavement Rehabilitation Scheme to Achieve Desired Resiliency Improvements Within Grant Funding

The storm surge from **Hurricane Ian** inundated not only the roadways but also the associated drainage infrastructure. Field reviews identified several culverts requiring **end treatment repair, replacement, and/or desilting**. Addressing these ancillary improvements will be critical to restoring functionality and enhancing resiliency against future storm events.



TEAM QUALIFICATIONS



Johnson Engineering has provided consulting services in and around Sanibel since 1946. We have worked extensively with the City and served as engineering consultants for many of Sanibel's developments. Our familiarity with local utilities and regulatory agencies, including the South Florida Water Management District, Lee County Utilities, LCEC, Comcast, and Centurylink, positions us well for this project.

As a multi-discipline firm, we offer in-house capabilities in surveying, roadway design, drainage, construction engineering and inspection, and grant compliance. Our sole sub-consultant, Tierra Inc., will provide geotechnical support. Our teams have successfully collaborated on previous grant-funded projects.

We bring extensive expertise in federally funded design and permitting. Our experience spans the entire design development process—from planning and design to permitting and construction. We understand the complexities of federal funding and maintain strict compliance with HUD standards.

FDOT PREQUALIFICATION WORK GROUPS

FDOT Pre-Qualification	Johnson Engineering	Tierra
3.1 - Minor Highway Design	✓	
3.2 - Major Highway Design	✓	
3.3 - Controlled Access Highway Design		
4.1.1 - Miscellaneous Structures		
4.1.2 - Minor Bridge Design		
4.2.1 - Major Bridge Design - Concrete		
4.2.2 - Major Bridge Design - Steel		
4.3.1 - Complex Bridge Design - Concrete		
4.3.2 - Complex Bridge Design - Steel		
5.1 - Conventional Bridge Inspection		
5.2 - Moveable Bridge Inspection		
5.3 - Complex Bridge Inspection		
5.4 - Bridge Load Rating		
8.1 - Control Surveying	✓	
8.2 - Design, Right of Way Construction Surveying	✓	
8.4 - Right of Way Mapping	✓	
9.1 - Soil Exploration		✓
9.2 - Geotechnical Classification Lab Testing		✓
9.3 - Highway Material Testing		✓
9.4.1 - Standard Foundation Studies		✓
9.4.2 - Non-Redundant Drilled Shaft Bridge Foundation Studies		✓
9.5 - Geotechnical Specialty Lab Testing		✓
10.1 - Roadway CEI	✓	✓
10.3 - Construction Materials Inspection		✓
10.4 - Minor Bridge and Miscellaneous Structures CEI	✓	✓
10.5.1 - Major Bridge CEI - Concrete		
10.5.2 - Major Bridge CEI - Steel		

KEY STAFF &
STAFF ABILITY



MANAGEMENT



DESIGN

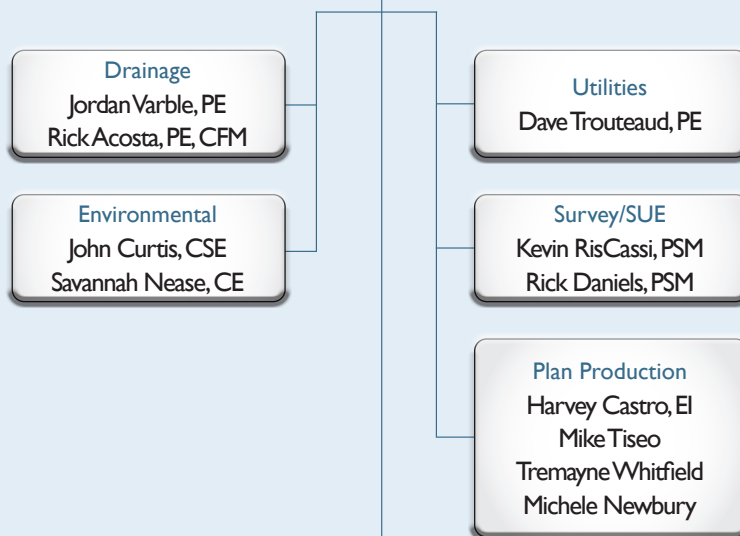

SUBCONSULTANTS



KEY TEAM BIOS

**John Glenn, PE - Project Manager**

John currently serves as a project manager working in both our design and CEI departments. With a primary focus on grant funded roadway and drainage projects throughout Southwest Florida, John understands that being mindful of budget constraints and efficient solutions to unforeseen issues are crucial to the success of these projects. Working as both a design project manager and CEI senior project engineer in Lee, Hendry, Glades, Hardee, DeSoto and Okeechobee Counties, John has a comprehensive understanding of both roadway and drainage design and construction. John recently served as the design project manager and provided service during construction for the Chamberlin Parkway Re-Alignment and drainage improvement project. During this project Johnson Engineering provided regional drainage improvements to the Skyplex area of RSW by improving outfall locations and increasing hydraulic connectivity throughout the property.

**Jordan Varble, PE - Drainage**

Jordan joined Johnson Engineering in 2015 and is a Professional Engineer in the company's Water Resources group. Jordan earned his Master of Science in Civil Engineering from Colorado State University in 2011 and Bachelor of Science in Civil Engineering from Missouri S&T in 2009. Jordan's experience as an engineer includes regional watershed modeling, surface water design, regulatory permitting, well design, groundwater modeling, data analysis, hydraulic pipe modeling, observation and analysis of geophysical logging programs, construction inspection, groundwater testing and analysis, water demand calculations, technical report writing, land surveying, agricultural irrigation system evaluation, engineering due diligence and expert witness engineering reports.

**Ryan Bell, PE, PTOE - Principal-In-Charge/ QA/QC**

Ryan serves as the director of the transportation group and has a degree in civil engineering from the University of Florida. He was born and raised in Southwest Florida, giving him a keen understanding and inherent appreciation for local transportation issues. Ryan has 27 years of experience in roadway design and construction providing him with a comprehensive understanding of the big picture as it pertains to transportation improvements. With a wide range of experience, he has a clear understanding of what it actually takes to get a project done, not just what the books and manuals require. Ryan understands that as a consultant our job is to take care of you, the client, and to help you meet your goals on your terms.

**Vee Lofton - Construction Project Administration**

Vee has 37 years of experience working on FDOT and county transportation projects located in District One, Four and Five, including five years combined with Florida Department of Transportation Maintenance and Construction. He has worked on a wide variety of transportation improvement projects with varying degrees of complexity as project administrator, contract support specialist and senior lead inspector. Vee currently holds, and is continuing to seek and renew, numerous certifications in the Construction Training Qualification Program (CTQP) qualifications as required by FDOT and FHWA. Vee is the director of the CEI team. His extensive experience extends through all facets of roadway and bridge construction, project administration, and inspection in both traditional design-bid-build and design-build. Vee specializes in document control for both quality assurance and quality control testing. His previous experience as a consultant program manager with the Florida Department of Transportation (FDOT) gives him a unique perspective of the bidding process, construction techniques utilized, as well as an understanding of the maintaining agency's needs.

**Charles Reed, II, EI - Construction Grant Compliance**

Charles is a project manager for Johnson Engineering. He has over 23 years of experience that includes integral involvement with Federally and State funded programs. Charles assists local municipalities throughout the state of Florida with administering these and other projects. His specific experience includes contract reviews on behalf of local program offices, managing the LAP Program for FDOT, LAP Compliance, project and contract management, stormwater and roadway design, and stakeholder coordination.

**Rick Acosta, PE, CFM - Drainage**

Rick joined Johnson Engineering in 2006. He is a project manager in the firm's surface water management department. He has designed and permitted surface water management systems for roadway, site development and assorted environmental projects through the South Florida and Southwest Florida Water Management Districts. Rick is a Certified Floodplain Manager and is accomplished in backwater profile modeling for adjustments to FEMA FIRMs. His modeling experience also analyzes water quality for treatment facilities related to municipalities achieving their obligations under the TMDL program.

**Dave Trouteaud, PE - Utilities**

Since joining Johnson Engineering in 2005, Dave has become specialized in hydraulic analysis for water, wastewater, and irrigation systems. Modeling has become an essential tool in predicting any effects of future infrastructure on existing facilities along with efficiently analyzing deficiencies within the existing system. In addition to modeling, his responsibilities include managing projects and designing utilities for various developments and municipalities in Southwest Florida, permitting of projects through local and state agencies, and overseeing projects throughout construction and closeout phases. Dave has considerable utility experience in Charlotte County.

**Kevin RisCassi, PSM - Survey/SUE**

Kevin joined Johnson Engineering in 2001 and is the firm's Director of Survey and Mapping services. He is responsible for the continued development of the field personnel, ensuring that fundamental knowledge and the latest technology is available and understood by his team. Kevin has more than 33 years of experience successfully providing both residential and commercial clients with control, boundary, topographic, route, and hydrographic surveys, as well as right of way mapping on transmission lines, and construction staking. He was instrumental in helping introduce and development of our current hydrographic and GPS capabilities and has performed numerous hydrographic surveys on local waterways.

**Rick Daniels, PSM - Survey/SUE**

Rick has 34 years of surveying experience, working in both the field and office. He joined Johnson Engineering as a survey technician in 2013 after 18 years of surveying in the public and private sector. He holds a General A.A. degree from Edison State College, a B.A. degree in Geography from the University of South Florida, and recently became a licensed Professional Surveyor and Mapper. He is highly proficient using AutoCAD Civil 3D through version 2020. During his time with Johnson Engineering, Rick has performed many services for our clients including ALTA/ACSM surveys, subsurface utility engineering surveys, right-of-way mapping, topographic surveys, preparation of easement and parcel descriptions, digital terrain modeling, preparation of subdivision plats, and preparation of construction calculations.

JOHN GLENN, PE

Transportation Engineer



jglenn@johnsoneng.com
239.461.2401

Years Experience

13 years

Education/Training

B.S. Civil Engineering (2013),
Florida Gulf Coast University

Licensing & Registration

Professional Engineer

FDOT Certifications

FDOT Advanced MOT

NRC Nuclear Gauge Safety

ACI Concrete Field Level I

Asphalt Paving Technician -
Level I & II

Earthwork - Level I & 2

Volunteer Opportunities

Fort Myers American
Little League

City of Fort Myers -
Adopt a Canal Program

Coastal Conservation
Association (CCA) - Banquet
Committee Member

John currently serves as a project administrator and design project engineer in our transportation group. John's experience includes both design and CEI on various projects throughout Lee, Hendry, DeSoto, Glades and Charlotte counties. Serving as design engineer and project administrator on many of these projects has given John an understanding of what it takes to successfully complete both the design and construction phases of a project.

Relevant Experience

- **Gasparilla Road Widening, Charlotte County** - John served as a design engineer for 2.7 miles of two to four-lane roadway reconstruction from Rotunda Boulevard to SR 776 in Charlotte County. In addition to roadway improvements the project included associated survey, utilities, landscaping, signalization, signing and marking, all related permitting and a new bridge over the Butterford Canal.
- **Rehabilitation of Roads and Chamberlin Parkway Re-Alignment, Lee County Port Authority** - John served as project manager for this project that encompassed over 10 miles of landside roadway at the Southwest Florida International Airport. This project included re-aligning and safety improvement to Chamberlin Parkway, construction of a large roundabout, landscaping and utility improvements. This project also consisted of developing a long term phased rehabilitation plan for the roadways. Phase I of this project has recently been constructed.
- **Fort Denaud Road Phase II, Hendry County** - Engineer of Record for approximately 2.5 miles of milling and resurfacing / full depth reclamation SCRAP funded project In Hendry County. John was responsible for all aspects of design including designing to the allotted budget and incorporating bid alternated for flexibility during bidding.
- **Alico Road, Lee County** - Team member for the design of approximately two miles of roadway widening from two to four lane urban roadway including all associated drainage, and permitting. This project is currently underway.
- **Helms Roadway Extension, Hendry County** - John served as both a design engineer and CEI project administrator for approximately three miles of new four-lane urban roadway improvements. His roles included overseeing roadway design efforts as well as soil density testing and sampling, concrete testing, review of pay requests, shop drawings and RFI's. This project includes the construction of four box culverts and one box culvert extension. John also served as a design team member on this project.
- **County Road 763, DeSoto County** - John recently served as the project administrator on this Milling and resurfacing SCOP and SCRAP funded project. His roles included; tracking quantity over and underruns to maximize available funding, coordinating change orders, conducting bi-weekly construction meetings, review of pay requests, shop drawings and RFI's.
- **County Road 661, DeSoto County** - John recently served as the project administrator on this Milling and resurfacing SCOP and SCRAP funded project. His roles included; tracking quantity over and underruns to maximize available funding, coordinating change orders, conducting bi-weekly construction meetings, review of pay requests, shop drawings and RFI's.
- **Birchwood Parkway, Glades County** - John recently served as the project administrator on this reconstructing and resurfacing SCOP funded project. His roles included; conducting bi-weekly construction meetings, review of pay requests, shop drawings and RFI's.
- **County Road 733, Glades County** - John participated in both the design and construction inspection for approximately two miles of roadway resurfacing and drainage improvements. This project was completed on time and on budget.
- **County Road 720, Glades County** - John participated in both the design and construction inspection for approximately two miles of roadway resurfacing and drainage improvements. This project was completed on time and on budget.
- **County Road 78 Phase III, Hendry County** - John served as both a design team member and inspector for the construction of approximately three miles of roadway widening, associated drainage and milling and resurfacing. This project has been completed.
- **County Road 78 Phase VI, Hendry County** - John served as both a design team member and Inspector for the construction of approximately one and a half miles of roadway widening, box culvert extension and milling and resurfacing. This project has been completed.

JORDAN VARBLE, P.E.
Water Resources

jvarble@johnsoneng.com
239.461.2431

Years Experience
14 years**Education/Training**
M.S. Civil Engineering
Colorado State University
(2011)

B.S. Civil Engineering
Magna Cum Laude
Missouri S&T
(2009)

Working Proficiency in Spanish

ArcGIS, AutoCAD, HEC-RAS
ICPR4, BMPTrains, and MS Office

Licensing & Registration
Professional Engineer
FL License No. 81414

Civic
Volunteer at
Harry Chapin Food Bank

Citizen Scientist for
CoCoRaHS Rain Network

Returned U.S. Peace Corps
Volunteer

Jordan joined Johnson Engineering in 2015 and is a Professional Engineer in the company's Water Resources group. Jordan earned his Master of Science in Civil Engineering from Colorado State University in 2011 and Bachelor of Science in Civil Engineering from Missouri S&T in 2009. Jordan's experience as an engineer includes regional watershed modeling, surface water design, regulatory permitting, well design, groundwater modeling, data analysis, hydraulic pipe modeling, observation and analysis of geophysical logging programs, construction inspection, groundwater testing and analysis, water demand calculations, technical report writing, land surveying, agricultural irrigation system evaluation, engineering due diligence and expert witness engineering reports.

Relevant Experience

- **HealthPark Florida ERP / Surface Water Management** - Obtained permit modifications associated with the development of Cypress Cove, Ronald McDonald House Expansion, and the new dog park.
- **Lee Health Regional Cancer Center Expansion ERP / Surface Water Management** - Obtained permit modifications associated with the expansion of Lee Health's Regional Cancer Center.
- **Environmental Resource Permitting (ERP) / Surface Water Management** - Named consultant on over 100 ERP applications submitted through SFWMD, FDEP, and SWFWMD for institutional, residential and commercial developments. Work included applications for major and minor ERP modifications through the preparation of stormwater management plans, ICPR & HEC-RAS models, and coordination with District staff. Clients include: FGCU, FSW, Cypress Lake Country Club, PRMRWSA, The Forum, Collier County, Lee Health, Shell Point, West Bay Club, Hendry County, The Brooks Club, FPL, Florida State Parks, Lee County (Utilities, Parks & Rec, Facilities, Port Authority), Verandah, Habitat for Humanity, the Harborage, Magnolia Landing and Bridgetown.
- **Southern Lee County Flood Mitigation Plan - Phase 3** - Developed regional conceptual projects to mitigate flooding problems highlighted by Hurricane Irma in 2017 for the south Fort Myers area of Lee County. Coauthored the final report that summarized the results from the regional hydrologic computer model for each conceptual project and recommended prioritized improvements. While the project focused primarily on flood mitigation, discussions were also included on water quality, wetland enhancement, recreation and water conservation. Also authored the local model section of the report, performing detailed hydrologic and hydraulic studies of three waterways to better refine the conceptual design and confirm the results of the regional model.
- **Southern Lee County Flood Mitigation Plan - Phase 2** - Member of the Phase II response team following Hurricane Irma in 2017 that identified short-term relief opportunities in major and secondary waterways in south Fort Myers. Work included detailed field investigations, mapping, historical permit research, and a comprehensive summary report.
- **Hendry County Canals Restoration & Mitigation** - The FEMA-funded project included hazard mitigation designs of the Austin Relief and Roy Brown Canals in northwest Hendry County. Authored hydrologic and hydraulic studies of the canals and currently designing and permitting improvements to the canals, including bank armoring, culvert replacement and a water control structure.
- **Surface Water Design** - Designed stormwater pipe networks for institutional, residential and commercial developments, including The Forum, Lee Health Regional Cancer Center, HealthPark Florida, FPL substations, FGCU, Magnolia Landing, Shell Point, Habitat for Humanity and LeeSar Regional Service Center.
- **Lee County Utilities Green Meadows Injection Well and Wellfield Expansion** - Field engineer for construction and testing of a Class I Industrial deep injection well (DIW), associated dual-zone monitor well system, and six PWS wells in Lee County, Florida. Project included testing and construction of a Lower Floridan aquifer DIW well completed to a depth of 3,300 feet bls, a dual zone monitor well system completed to 1,800 feet bls and six Upper Floridan PWS wells completed to depths up to 1,200 feet bls. Prepared the final completion report for the DIW project.

RYAN BELL, PE, PTOE**Director of Transportation**

rbell@johnsoneng.com
239.461.3310

Years Experience

27 years

Education/Training

B.S. Civil Engineering (1998),
University of Florida

Intermediate MOT

Advanced MOT

Asphalt Level I & II

QC Manager

Licensing & Registration

Florida Professional Engineer,
License No. 60010

Professional Traffic Operations
Engineer (PTOE)

Professional Affiliations

American Society of
Civil Engineers

National Society of
Professional Engineers

Florida Engineering Society

Ryan joined Johnson Engineering in 1998 and is the firm's director of transportation. He has worked on various projects throughout Southwest Florida and is familiar with the design and permitting procedures of the local municipalities as well as the Florida Department of Transportation (FDOT). Ryan's primary experience includes planning, traffic, design, permitting and construction engineering and inspection (CEI) of transportation improvement projects. He has served as design project manager as well as CEI project engineer on numerous projects. This range of experience provides him a firm understanding of the overall process involved with transportation improvement projects from inception to final completion.

Design Experience

- **Flamingo/Edgewater Improvements, Charlotte County** - Ryan is currently serving as project manager on this 4-mile, two to four-lane roadway reconstruction and realignment project in Charlotte County. The phased project is in the preliminary design stages and includes associated drainage, utilities, lighting, signing and marking and three bridges.
- **Alico Connector, Lee County** - Ryan is currently serving as project manager for this 10-mile new corridor design connecting Alico Rd and Sunshine Blvd in Lee County. This project includes extensive drainage and environmental considerations, lighting, signals, utilities, wetland creation and restoration, three wildlife crossings, a continuous Green-Tee and a Continuous Flow intersection.
- **Burnt Store Road South, Lee County** - Ryan served as project manager on this 2-mile, two to four-lane roadway reconstruction project in Lee County. The project is the final phase of a three-phase capacity project in Cape Coral and included associated drainage, utilities, lighting, signing and marking and a bridge.
- **Gasparilla Road (CR 771), Charlotte County** - Ryan served as project manager for 2.7 miles of two to four-lane roadway reconstruction from Rotunda Boulevard to SR 776 in Charlotte County. In addition to roadway improvements the project included associated survey, utilities, landscaping, signalization, signing and marking, all related permitting and a new bridge over the Butterford Canal.
- **Alico Road, Lee County** - Ryan served as project manager for this two to four-lane roadway reconstruction project from Ben Hill Griffin Parkway to Airport Haul Road in Lee County. In addition to roadway improvements the project included associated survey, utilities, landscaping, signalization and signing and marking and all related permitting.
- **CR 78, Hendry County** - Project manager for two miles of resurfacing, shoulder construction and drainage improvement design.
- **Helms Road, Hendry County** - Project manager for design of approximately three miles of new four-lane roadway in Hendry County including all associated drainage, permitting, signalization and signing and marking. This project is currently underway.
- **SR 739 (Michael G. Rippe Parkway), Lee County** - Project manager for three miles of new six-lane roadway including a bridge over a railroad.
- **Aqui Esta Drive, City of Punta Gorda** - Project manager for two miles of two-lane roadway reconstruction including bridge replacement over the Venice Canal.
- **Piper Road, Charlotte County** - Project manager for four miles of new four-lane roadway design.

CEI Experience

- **Helms Roadway Extension, Hendry County** - Ryan served as the Senior Project Engineer for three miles of new four-lane urban roadway improvements. Ryan also served as the Engineer of Record on this project
- **Colonial Boulevard Widening, Lee County** - CEI project engineer for three miles of four to six-lane roadway widening including widening of the bridge over Six Mile Cypress Slough
- **Three Oaks Imperial Parkway, City of Bonita Springs** - CEI project engineer for four miles of new four-lane roadway and one mile of four to six-lane widening construction including a 285-foot bridge, drainage and signalization.
- **Gasparilla Road (CR 771), Charlotte County** - Design EOR and CEI Senior PE for this CM at Risk project including 2.5 miles of 2 to 4 lane widening with associated utility relocation, drainage, signalization, street lighting and a new pre-fab deck span bridge over the Butterford Canal.
- **SR 739 (Old 41), Lee County** - Senior project engineer for nearly two miles of two to four lane widening. This FDOT construction project in North Fort Myers includes significant drainage, utility relocation and maintenance of traffic coordination.

JAMES "VEE" LOFTON

Director of CEI



jlofton@johnsoneng.com
239.461.2406

Years Experience

37 years

Licensing & Registration
Florida Certified
General Contractor,
License No. CGC 1517567

Education/Training
Edison Community College
(1997-1998)

Itawamba Community College
(1990-1992)

FDOT Advanced Work Zone
Traffic Control Course

Troxler Nuclear Gauge Safety
Certification RSO

ACI Concrete Field-Testing
Technician- Grade I

FDOT Asphalt Paving
Technician I-II

FDOT Density Earthwork
Inspection Training

FDOT Concrete Field
Technician- Level I

ACI Concrete Transportation
Construction Inspector Level II

CTQP: FDOT Qualified Grouting
Technician- Level I

Vee has 37 years of experience working on FDOT and county transportation projects located in District One, Four and Five, including five years combined with Florida Department of Transportation Maintenance and Construction. He has worked on a wide variety of transportation improvement projects with varying degrees of complexity as project administrator, contract support specialist and senior lead inspector. Vee currently holds, and is continuing to seek and renew, numerous certifications in the Construction Training Qualification Program (CTQP) qualifications as required by FDOT and FHWA. Vee is the director of the CEI team. His extensive experience extends through all facets of roadway and bridge construction, project administration, and inspection in both traditional design-bid-build and design-build. Vee specializes in document control for both quality assurance and quality control testing. His previous experience as a consultant program manager with the Florida Department of Transportation (FDOT) gives him a unique perspective of the bidding process, construction techniques utilized, as well as an understanding of the maintaining agency's needs.

Relevant Experience

- **Estero Boulevard, Lee County** - Vee is currently serving as project manager and CEI project administrator for 5 miles of roadway reconstruction. This project includes extensive drainage and utility infrastructure improvements, complex maintenance of traffic schemes, roadway reconstruction, and signalization improvements. Vee's roles include holding weekly construction meetings, coordinating verification testing operations, construction contract oversight, maintaining detailed logs of contract quantities and manpower and reviewing and approving all submitted pay applications.
- **Golden Gate Sidewalks at Various Locations (LAP - FPID No. 434990-1-38-01)** - Vee served as CEI project administrator for this sidewalk and drainage LAP funded improvement project in Collier County. Vee's roles include holding bi-weekly construction meetings, overseeing all aspects of LAP compliance, construction contract oversight, maintaining detailed logs of contract quantities and manpower and reviewing pay applications and contract change orders. Vee was also responsible for FDOT coordination on the project.
- **County Road 78, Hendry County** - Vee served as the project administrator for the construction of approximately one and a half miles of roadway widening, box culvert extension and milling and resurfacing. This project consisted of multiple phases, all funded by FDOT through their SCOP and SCRAP programs.
- **Immokalee Road Six-Lane, Collier County** - This project consists of new construction of a six-lane urban roadway traversing through existing populated subdivisions. This project also has a low-level critter crossing over the Cocohatchee Canal. This connects the residence of Naples to Immokalee Road for timely ingress and egress along Immokalee Road with turn lane movements, creating a new signalized intersections at Immokalee Road and Oil Well Road, Randall at Immokalee Road and Wilson at Immokalee Road. Vee is currently serving as project administrator.
- **Colonial Boulevard (CR 884) Six Laning from I-75 to SR-82 Capital Improvement Project** - This project consisted of 2.62 miles of roadway widening related construction activities, roadway, lighting, signing, and one bridge 500 lineal feet over six-mile slough.
- **Golden Gate Parkway Project, Naples** - This project consists of three new curved steel girder bridges designated as on/off ramps, widening of the existing Golden Gate Parkway Bridge over I-75 from four lanes to six lanes plus one ramp lane, resurfacing of I-75 and Golden Gate Parkway, constructing four each access frontage roads, lowering and reworking north and south bound lanes of I-75 to meet new Federal Standards for bridge clearance and constructing onsite mitigation and drainage systems including a noise wall along south bound I-75. Vee served as assistant project administrator and lead senior bridge and roadway inspector.
- **Peace River Bridge, Punta Gorda** - The I-75 Peace River Bridge Design- Build Project consisted of the construction of a new bridge structure between the existing bridges, replacement of the existing concrete bridge deck and removal of the Northbound I-75 bridge to its entirety, to widen the existing roadway to a six-lane facility. The project included widening of the existing bridge structure over Riverside Drive and Gulf Seminole Railway. Vee served as project administrator for FDOT and FHWA as this project was a pilot design build project with FHWA oversight.

CHARLES REED, II, EI

Project Manager



creed@johnsoneng.com
813.751.2656

Years Experience

23 years

Education/Training

B. S. Civil Engineering (2001),
Florida State University
Tallahassee, FL

M. S. Civil Engineering (2002),
Florida A&M University
Tallahassee, FL

FDOT Advanced MOT

FDOT Final Estimates Level I
LAP Contract Compliance
Specialist

Licensing & Registration

Engineering Intern, Florida,
No. 1100007651

Charles is a project manager for Johnson Engineering. He has over 20 years of experience that includes integral involvement with Federally and State funded programs. Charles assists local municipalities throughout the state of Florida with administering these and other projects. His specific experience includes contract reviews on behalf of local program offices, managing the LAP Program for FDOT, LAP Compliance, project and contract management, stormwater and roadway design, and stakeholder coordination.

Experience

- **Sun N Lakes Sidewalks (LAP Funded), Highlands County, FL** - Contract Compliance Specialist: Charles was responsible for the Equal Employment Opportunity (EEO) Compliance for this Federally funded sidewalk LAP project. His duties included verifying certified payrolls, jobsite bulletin board inspections, monitoring of EEO compliance and coordination with all stakeholders.
- **Four Corners Ditch Improvements Project (CDBG-DR Funded), Hendry County, FL** - Grant Manager: The scope of work involves providing and improving the drainage infrastructure for the Four Corners MSBU in Hendry County. The project will provide additional storage and conveyance for stormwater to the Caloosahatchee River during large storm events.
- **Richmond Ave. Pedestrian Bridge (CDBG Funded), Lee County, FL** - Grant Manager: Charles was the grant manager for the project that involved the design of a pedestrian bridge that will replace the existing pedestrian bridge that was damaged by a Hurricane. The new pedestrian bridge will be along Richmond Ave. over Able Canal.
- **Florida Department of Transportation, District Seven, Tampa, FL** - Project Manager: Charles was responsible for contract reviews of Federally and State funded projects on behalf of the FDOT Local Programs Office. His duties included initial contract reviews, identifying needed corrections, coordination with the Local Agencies and Department staff, final contract reviews, and recommendations for approval or rejection of contracts.
- **Florida Department of Transportation, District One, Bartow, FL** - Project Manager: Charles acted as an extension of the FDOT's Local Programs office, managing the Federally and State funded projects. His duties included managing the Local Agency Program (LAP), Small County Road Assistance Program (SCRAP), Small County Outreach Program (SCOP), County Incentive Grant Program (CIGP), Transportation Regional Incentive Program (TRIP), and Economic Development Transportation Fund Program (EDTF). Management of these programs involved administrative, design and construction components.
- **Florida Department of Transportation, District Three, Chipley, FL** - Project Manager: Charles supported the FDOT Local Agency Program (LAP) with project administration, design and construction. His duties included assisting Local Agencies with the administration of LAP projects, reviewing design plan submittals, and reviewing construction change orders on behalf of the Department.
- **Pasco County Government, Pasco County, FL** - Project Manager: Charles currently assists the County with managing various roadway and drainage projects, including design and post design services.

RICARDO ACOSTA, PE, CFM**Water Resource Engineer**

ra@johnsoneng.com
239.461.3324

Years Experience

23 years

Licensing & Registration

Florida Professional Engineer,
License No. 69121

Association of State
Floodplain Managers,
Certified Floodplain Manager,
Certificate No. US-13-Q7110

Education/Training

B.S. Civil Engineering (1998),
Universidad Nacional de Colombia

Rick joined Johnson Engineering in 2006. He is a project manager in the firm's surface water management department. He has designed and permitted surface water management systems for roadway, site development and assorted environmental projects through the South Florida and Southwest Florida Water Management Districts. Rick is a Certified Floodplain Manager and is accomplished in backwater profile modeling for adjustments to FEMA FIRMs. His modeling experience also analyzes water quality for treatment facilities related to municipalities achieving their obligations under the TMDL program.

Relevant Experience

- **McGregor Resurfacing** - Assisted in the environmental permitting for the resurfacing of approximately one mile of McGregor Blvd from Manuel's Branch to US-41 in Fort Myers. The proposed project included replacing or relining all drainage pipes in the right-of-way and the addition of filtering structures upstream of the existing outfall.
- **Big Carlos Pass** - Assisted in the design and permitting of Construction and Operation of the surface water management system for the demolition and replacement of the Big Carlos Pass Bridge. The project also includes construction of a parking area, pedestrian walkways, utilities, and roadway infrastructure.
- **Burnt Store Road Widening, Lee and Charlotte Counties** - Assisted in the design and permitting of the surface water management system for the expansion of approximately five miles of two segments of the existing road.
- **Three Oaks Drainage Conveyance** - Designed, permitted and provided post-design services for the improvements to the Three Oaks Parkway's east roadside ditch and to an existing structure connecting it to The Brooks pond system in order to increase the conveyance capacity into the South Branch of the Estero River up to 160 cfs. This project involved coordination with Lee County, The Brooks and FDOT. The design included expanding ditches, relocating weirs and retrofitting a existing structure to add telemetry control of remote gate operation capability.
- **State Road 31, Lee and Charlotte Counties** - Assisted in the design and permitting of the surface water management system for the approximately four-mile roadway expansion project
- **Spanish Creek Preserve Hydrologic Restoration** - Lee County - Analyzed hydrology and hydraulics within approximately 5,000 ac of land that serves as headwaters for a 243-acre parcel in Lee County. The goals were to determine the existing capacity of the Spanish Creek and the quantity of water that could be diverted into the Spanish Creek Preserve to improve the hydroperiod.
- **Middle School MM and Elementary School J** - Designed the surface water management system for the dual-school campus in Lehigh Acres, including extension of Sunrise Blvd and obtained Environmental Resource Permits through the South Florida Water Management District and approval from the Lehigh Acres Municipal Services Improvement District.
- **High School MMM** - Designed the surface water management system for the new High School in Gateway, including improvements to Griffin Dr and obtained Environmental Resource Permits through the South Florida Water Management District.
- **Brighton Valley Dispersed Water Management** - Designed the surface water management system for diverting up to 40,000 acre-feet of water per year for dispersed flow in Highlands County. The shallow wetlands created as part of this project will allow water to naturally infiltrate and reduce the concentrations of nutrients prior to being released via either the C-40 or C-41A Canals toward Lake Okeechobee.
- **Bonita Springs High School** - Designed the surface water management system for the school and obtained Environmental Resource Permit through the South Florida Water Management District.
- **North Fort Myers and Bonita Springs Libraries** - Designed the surface water management systems and obtained Environmental Resource Permit through the South Florida Water Management District for both sites. The North Fort Myers site required also a Drainage Connection Permit through the Florida Department of Transportation

DAVID TROUTEAUD, PE

Utility Project Engineer



dtrouteaud@johnsoneng.com
239.461.2438

Years' Experience

20 years

Education/Training

B.S. Civil Engineering (2005),
University of Cincinnati, Ohio

OSHA 10 Hour Certification

Licensing & Registration

Florida Professional Engineer,
License No. 69783

Professional Affiliations

Florida Engineering Society (Past
Member)

Young Professionals (Past
Member)

Coastal Conservation Association
(Past Member)

Dave joined Johnson Engineering in 2005 and manages various utility-related projects. As a project manager with 20 years of experience, he specializes in utility master planning, hydraulic modeling, design of water distribution systems, wastewater collection systems, and irrigation systems. Dave frequently works with Lee County staff, starting from the contract negotiation and continuing through construction and certification. Recent projects Dave has managed include 3rd & Alabama Force Main, Force Main & Reclaimed Main Replacement, & Bell Avenue Water Main. Other projects that Dave has been involved and are similar to this RFP include being an Engineer of Record (EOR) for City of Cape Coral's Southwest 6 & 7 Utility Extension Project, EOR for FGUA's Del Prado Reuse Main, and EOR for the City of Fort Myers' McGregor Area Waterlines.

Relevant Experience

- **Ben Hill Griffin/Alico Road 36-inch Potable Water Main, Lee County Utilities** (EOR and Project Manager) - This project included the design, permitting, bidding and approximately 10,050 linear feet of 36-inch water main. The water main was designed in conjunction with the Roadway Widening of Alico Road and is nearing completion. As of this submittal, all water mains have been cleared through the Department of Health and is anticipated to be placed in service in mid-2020.
- **Master Pump Station 7716, Lee County Utilities** (EOR and Project Manager) - This project consisted of designing and relocating a master pump station capable of conveying a peak flow of 1,700 gallons per minute (GPM) from various developments along Corkscrew and Three Oaks Parkway within Lee County. Unique challenges associated with this project include coordination with permitting agencies, working within a proposed development, and hydraulic modeling. Johnson Engineering provided the survey and design for this project. The contract also included permitting, bidding services, and construction phase services. This project is anticipated to be completed in August of 2020.
- **Pine Ridge Force Main, Lee County Utilities** (EOR and Project Manager) - This project consists of approximately 4,300 feet of force main with sizes varying from 20- to 30-inches. The force main will replace the existing ductile iron pipe force main that has reached its usable life. This project included design, hydraulic modeling, permitting, bidding and is currently being constructed. Key challenges include a directional drill design under an LCDOT congested road (Summerlin Road), coordination with Lee Tran, and considerations for shutdowns during connections. This project was completed in January 2021.
- **Del Prado Reuse Transmission Main, FGUA** (EOR and Project Manager) - This project included survey, route analysis, design, permitting, bidding assistance, and construction administration services for approximately 11,500 feet of 16-inch and 20-inch reuse water mains. This project included nine directional drills to avoid impacts to wetlands and roadways. Permitting included an FDOT permit to cross US-41, City of Cape Coral SDP, FDEP Environmental Resource Permit, and coordination with FPL and LCEC. This project was completed in June 2019.
- **Southwest 6 and 7, Utility Extension Project, City of Cape Coral** (EOR and Project Manager) - Dave was EOR for Areas 1 and 2 and the inspection team's project manager for Areas 1, 2, 9 and 10. Combined, the four areas included installation of approximately 16.2 miles of gravity sewer, 17.4 miles of water main, 18.7 miles of irrigation main, 3.7 miles of force main, and replacing 2.4 miles of storm culverts. This project was funded using a State Revolving Fund (SRF) loan. Construction of this project required ongoing compliance with SRF rules and regulations.
- **Palm Tree Boulevard Potable Water Main, Storage and Re-Pumping Facility Improvements, City of Cape Coral** (EOR and Project Manager) - This project included route analysis, design, and permitting of water main improvements that serve south Cape Coral. The goal of this project was to maximize the use of the existing Palm Tree Storage Facility. Phase 1 consisted of the design, permitting and construction of approximately 9,000 feet of 20-inch water main directed to the storage tank. Phases 2 and 3 consist of approximately 13,400 feet of 12-inch water main for water distribution. Johnson Engineering was responsible for the environmental permitting and species management for all three phases. In addition, a review of the existing onsite pumps, valves, and instrumentation was performed and recommendations for upgrades were made.

KEVIN RISCASSI, PSM**Director of Surveying & Mapping**

kriscassi@johnsoneng.com
239.461.2410

Years Experience

33 years

Licensing & Registration

Florida Professional Surveyor &
Mapper, License No. LS6433
License Acquired: 7/28/03

MOT Certification

Education/Training

B.A. Economics (1992),
Trinity College

Professional Affiliations

Florida Surveying and
Mapping Society

Kevin joined Johnson Engineering in 2001 and has 33 years of surveying experience, including control, boundary, topographic, route, hydrographic, construction, GPS, elevation certificates and mortgage surveys. He has six years of field experience as a survey crew chief, three years as a survey technician and has been licensed as a professional surveyor since 2003. Kevin serves as project manager on hydrographic, boundary, design and construction projects.

Relevant Experience

- **Kitson & Partners, Babcock Ranch Community Phase IA, Town Square, and Phase IBI Surveys** – Kevin led the surveying services to complete the platting of Babcock Ranch Community Phase IA & Town Square in 2012 and is currently in the process of platting Babcock Ranch Community Phase IBI. He has performed hydrographic surveys on several of the lakes, prepared topographic surveys for design and quantity analysis, construction staking on the Earthsource Relocation Site and prepared tree surveys for permitting applications.
- **Clam Pass, Collier County, FL** - Kevin was responsible for control survey, beach cross sections, profile data and hydrographic mapping on four cuts flowing to the pass.
- **Gasparilla Island Bride Authority Toll Bridge, Gasparilla Island, FL** - Kevin was responsible for control and mapping hydrographic data necessary in dredging and design analysis for the construction of new bridges.
- **Ding Darling, Sanibel, FL** - Kevin was responsible for vertical control, obtaining cross sections on drainage creeks and topographic data collection on approximately 230 acres mangrove vegetated land for runoff and restoration studies.
- **South Fork East CDD Amenity Center Expansion, Riverview, FL** - Kevin was responsible for the topographic and boundary survey data necessary to prepare concept alternatives and site design for a community activity area and building expansion at this public facility within the South Fork East Community Development District.
- **U.S. Navy Turning Basin at Key West Bight, Key West, FL** - Kevin played an instrumental role in the hydrographic survey of an existing basin for design.
- **United States Sugar Corporation, Hendry, Glades & Palm Beach County, FL** - Kevin was one of five professional Johnson Engineering employees in charge of control, title review and boundary work associated with 80,000 acres of USSC property.
- **Windham/Magnolia Landing, Lee County FL** - Kevin was responsible for producing a 983-acre boundary survey. Kevin is currently working on boundaries associated with future planned development within existing boundary.
- **Magnolia Landing Unit One, Lee County, FL** - Kevin is the surveyor of record for the plat.
- **Florida Power & Light, Alico/Orange River #3, Lee & Collier County, FL** - Kevin was responsible for the aerial control, record drawings for design, right of way survey, construction staking of new transmission line and as-builts on new improvements.

RICK DANIELS, PSM**Professional Surveyor & Mapper**

rdaniels@johnsoneng.com
239.461.2465

Years Experience

34 years

Licensing & Registration

Florida Professional Surveyor & Mapper, License No. LS7229
License Acquired: 3/13/2019

Education/Training

B.A. Geography
University of South
Florida

A.A. Edison State
College

U.S. Army Engineer School
Construction Survey Course

Autocad Civil 3D

NSPS/ACSM Sponsored Certified
Survey Technician,
Levels II, III

Rick joined Johnson Engineering as a survey technician in 2013 after 18 years of surveying in the public and private sector, working in the field and office. He started in the U.S. Army as a construction surveyor. He is currently a certified survey technician, Level III and proficient in AutoCad. He has earned a General A.A. degree from Edison State College, a B.A. degree in Geography from the University of South Florida, and recently became a licensed Professional Surveyor and Mapper. During his time with Johnson Engineering, Rick has performed many services for our clients including: ALTA/ACSM surveys, subsurface utility engineering surveys, right-of-way mapping, topographic surveys, preparation of easement and parcel descriptions, digital terrain modeling, preparation of subdivision plats, and preparation of construction calculations.

Relevant Experience

- **Orangetree Utility Site, Collier County** - Rick was responsible for preparing a boundary and topographic survey for the site with subsurface utility engineering data and prepared legal descriptions for the boundary and a well easement to the south.
- **Southwest Florida International Airport, Lee County** - Rick was responsible for overseeing and preparing base maps from field locations, and digital terrain models for 10+ miles of roadway throughout the airport complex.
- **Corkscrew Road, Lee County** - Rick was responsible for creating a base map from field locations, preparing a digital terrain model, and boundary survey for 4+ miles of roadway.
- **University Plaza West, Lee County** - Rick was responsible for preparing construction layout calculation drawings, computing field stake out points and preparing various sketch and descriptions for the project.
- **Bridgetown, Lee County** - Rick was responsible for preparing construction layout calculation drawings, computing field stake out points, preparing various sketch and descriptions, and preparing subdivision plats for the project.
- **Hopedelagee Ranch, Hendry County** - Rick was responsible for preparing a boundary survey for a 7,800 acre parcel.
- **SE Renewable Fuels, Hendry County** - Rick was responsible for creating a base map from field locations and preparing a digital terrain model for the site.
- **Hilliard Parcel, Hendry County** - Rick prepared a 300+ acre boundary survey including the preparation of several easement sketch and descriptions.
- **Florida Power & Light Company Right-of-Way Acquisition, Charlotte & Lee County** - Rick was responsible for preparing right-of-way parcel maps of 70+ miles of transmission lines for acquisition by the client.
- **Micco Bluff Road, Okeechobee County** - Rick was responsible for creating a base map from field locations and preparing a digital terrain model for 2.4+ miles of roadway.

STEVEN TROMBLEY**Construction Observer**

strombley@johnsoneng.com
813.909.8099

Years Experience

32 years

Education/Training

A.I. Prince Technical School,
Hartford, CT (1990)

E.C. Goodwin Technical School,
New Britain, CT (1986)

New England Technical Institute,
New Britain, CT (1985)

Certifications

Nuclear Gauge

Hazmat

CTQP Asphalt Paving I

CTQP Earthwork I

Advanced Work Zone Traffic
Control (AATSA)

DEP-Stormwater Management
Inspector

Vehicle Mounted Aerial Lift

CPR/First Aid

NUCA Excavation Safety

OSHA Hazard Communication
Standard

Steve is an inspector for Johnson Engineering. Steve has served as an inspector on several FDOT grant funded projects. Prior to Johnson Engineering Steve worked for several construction companies and has hands on experience as a contractor constructing site, roadway and utility infrastructure. His background in construction allows Steve to thoroughly understand the importance of proper project sequencing.

Experience

- **Helms Roadway Extension, Hendry County** - Steve served as an inspector for approximately three miles of new four-lane urban roadway improvements. His roles include soil density testing and sampling, concrete testing, roadway base subgrade and base inspections and tracking of quantities. This project includes the construction of four box culverts and one box culvert extension. This project included widening and turn lane improvement to SR 29. Steve worked closely with FDOT permit staff to ensure all project specifications and permit requirements were met. This project was grant funded through FDOT's CIGP program.
- **County Road 733, Glades County** - Steve served as the senior inspector for nearly 3.5 miles of roadway milling and resurfacing, drainage improvements and signing and pavement marking. This project was grant funded through FDOT's SCOP and SCRAP grant program. Steve's roles include soil density testing and sampling, concrete testing, paving inspection and tracking of contract quantities. Steve performed all QC testing required on this project.
- **County Road 720, Glades County** - Steve served as the senior inspector for 2 miles of roadway milling and resurfacing, drainage improvements and signing and pavement marking. This project was grant funded through FDOT's SCOP and SCRAP grant program. Steve's roles include soil density testing and sampling, concrete testing, paving inspection and tracking of contract quantities.
- **CR 771, Charlotte County** - Steve served as an inspector for approximately three miles of new four-lane urban roadway improvements. His roles include soil density testing and sampling, concrete testing, roadway base subgrade and base inspections and tracking of quantities. This project includes the construction of four box culverts and one box culvert extension.
- **Estero Boulevard, Lee County** - Steve is currently serving as an inspector for 1.25 miles of roadway reconstruction. This project includes extensive drainage and utility infrastructure improvements, complex maintenance of traffic schemes, roadway reconstruction, and signalization improvements. Steve's roles include soil density testing and sampling, concrete testing, paving inspection and tracking of contract quantities.
- **Pospiech Contracting Inc., Inverness, FL** - Steve worked as a foreman on Rampart Boulevard roadway improvements.
- **Clary's Site Development, Inc., Fort Myers, FL** - As supervisor of site development, Steve worked on Kohl's/Wal-Mart, SR-78, Nicholas Boulevard, Siesta Lakes Condominiums, Sun Sports, S.R. 884, Cemex, Corkscrew Boulevard, ST Wooten, and Alico Road.
- **WestWind Contracting, Inc., Pembroke Park, FL** - As supervisor on S.R. 78 improvements, Steve was responsible for traffic control, NPDES, road construction, curbing and sidewalk construction, retention, detention and liner pond construction, and conducting safety meetings. Steve also worked closely with the inspectors, engineers, surveyors and subcontractors.

JOHN CURTIS, CSE**Certified Senior Ecologist**

jcurtis@johnsoneng.com
239.461.2462

Years Experience
28 years
Education/Certifications

B.A. Biology (1994),
Rollins College

Certified Senior Ecologist,
Ecological Society of America

FAA Qualified Airport Wildlife
Biologist (FAA A/C 150-5200-
36A)

Crested Caracara Qualified
Observer, USFWS

Florida Bonneted Bat Qualified
Acoustic/Roost Surveyor, USFWS

Authorized Gopher Tortoise
Agent, FWC (GTA-09-00137)

Burrowing Owl Registered Agent,
FWC (RAG-18-00073)

Florida Forest Service
S-130 & S-190 Training

Professional Affiliations

Florida Association of
Environmental Professionals
(Past Treasurer)

Ecological Society of America

Estero Bay Agency on Bay
Management

John joined Johnson Engineering in 1997 as an ecologist. His duties include all aspects of state, federal and local environmental resource permitting, wetland determinations, environmental impact surveys and assessments, mitigation plan design and construction oversight, wildlife surveys, endangered species relocation, expert witness testimony, avian flight pattern monitoring, habitat mapping, FDOT biological assessments, and protected species and mitigation monitoring reports. John is an Authorized Gopher Tortoise Agent by the Florida Fish and Wildlife Conservation Commission.

In June 2013, John met the qualifications established by the Board of Professional Certification of the Ecological Society of America to become a Certified Senior Ecologist. In May 2016, John also met the education, training and experience requirements as stipulated under Federal Aviation Administration (FAA) Advisory Circular 150/5200-36A to be classified as a Qualified Airport Wildlife Biologist.

Relevant Experience

- **Helms Road Extension, Hendry County** - Served as lead ecologist, overseeing gopher tortoise surveys, permitting and relocation for over 50 burrows. Conducted surveys, prepared management plan, and obtained Incidental Take Permit from FWC for Big Cypress fox squirrel.
- **Airport Sears MSBU Drainage Improvements, Hendry County** - Served as lead ecologist for the project, which required SFWMD and USACE permitting, Section 7 consultation with USFWS and coordination with FWC staff on multiple state and federal listed species. Wildlife surveys entailed gopher tortoise surveys per FWC Guidelines and four (4) seasons of crested caracara nesting season surveys to date in accordance with USFWS protocols.
- **County Road 78, Hendry County** - Conducted caracara surveys and environmental permitting with state and federal permitting agencies. Close coordination was required with USFWS and subsequent monitoring to allow construction activities to occur within the primary zone of an active crested caracara nest during nesting season.
- **Babcock Ranch, Lee & Charlotte Counties** - Protected species surveys, wetland jurisdictional determinations, multiple gopher tortoise relocations, caracara surveys.
- **Gasparilla Island Water Authority, Charlotte County** - Performed wetland delineation, habitat mapping, protected species surveys, environmental permitting, wood stork prey base assessment, mitigation assessment for the installation of a new 12-inch water main in Gasparilla Sound via subaqueous directional drill to avoid impacts to mangroves and sea grasses. The project also affected a federal navigation channel, requiring Section 408 permitting by the Army Corps of Engineers Jacksonville office.
- **Tippen Bay Water Storage Facility, Charlotte and Desoto Counties** - Conducted habitat mapping, wetland and protected species assessment and wetland impact and mitigation analysis using UMAM for a potential ±20,000 acre, 15MGD water storage facility. The site was also evaluated for its potential to provide regional wetland mitigation credits and listed species conservation banking opportunities.
- **Lee County Port Authority Airport Mitigation Park, Lee County** - Conducted listed species surveys, hydrologic monitoring, wildlife monitoring, habitat mapping, wetland delineations, and state and federal regulatory agency coordination during permitting.
- **City of Cape Coral Southwest 6&7 Utilities Expansion Project, Cape Coral** - Performed all environmental and threatened/endangered species permitting required for the Southwest 6&7 Utilities Extension Project. This project involved preparation of management plans to allow work within five different bald eagle nest management zones, relocating gopher tortoises, securing a Migratory Bird Nest Removal Permit for burrowing owls, bald eagle monitoring, and state/federal wetland permitting to allow for multiple aerial utility crossings.
- **Florida Gulf Coast University, South Entrance Road and Recreation Facility, Lee County** - State and Federal environmental resource permitting, pre-construction surveys, listed species surveys, gopher tortoise FWC permitting and relocations, Florida bonneted bat surveys, mitigation monitoring, water level monitoring, eastern indigo snake surveys, permit compliance services.

SAVANNAH NEASE, CE

Ecologist I



snease@johnsoneng.com
239.672.0005

Years Experience

9 years

Education/Training

B.S. Biology (2013),
University of Florida

Certified Ecologist, ESA

FAA Remote Pilot Certificate

Certified Prescribed Burn Manager
(20205126)

Commercial Applicator License
(CM26423)

38 Hour Army Corps of Engineers
Wetland Delineation Course

Professional Affiliations

Ecological Society of America

Florida Association of
Environmental Professionals

Conservation Land Acquisition and
Stewardship Advisory Committee
(Lee County)

Savannah joined the firm in the summer of 2020. As a native Floridian, she is familiar with the flora, fauna, and local ecological history that make Southwest Florida unique. As an ecologist at Johnson Engineering, her duties include protected species surveys, wetland jurisdictional determinations, mitigation monitoring, vegetation and habitat mapping, GIS analysis, species-specific monitoring and surveys, including gopher tortoises, burrowing owls, crested caracara and bald eagles, in addition to state and federal environmental resource permitting.

Prior to joining the team, Savannah worked in environmental consulting for several years before she took a position with the Babcock Ranch Community. While there, she provided general oversight for 12,000+ acres of mitigation activities on-site and offsite in addition to managing wetland creation and exotic vegetation removal projects. She is a Certified Ecologist by the Ecological Society of America (ESA), a licensed drone pilot, a Certified Prescribed Burn Manager, and has her Commercial Applicator's License in Natural Areas Weed Management and Aquatic Areas.

Relevant Experience

- **Kitson & Partners, Babcock Ranch Community** – Conducted listed species surveys, wildlife monitoring, mitigation monitoring and reports, GIS analysis, and assisted with new state and federal permitting efforts with updates to the mitigation plan. Performed caracara surveys throughout the nesting season and assisted in a tag and capture of an adult caracara with Dr. Joan Morrison.
- **SFWMD Reservoir Projects** - Monitoring of caracaras on the C-43 and C-139 reservoir projects.
- **SFWMD Caloosahatchee River Tape Grass Restoration Project** - Assisted with tape grass monitoring and fish sampling for a program aimed at restoring native grass beds in the Caloosahatchee River.
- **Drone Flights** – Conducted drone flights for updated aerial mapping, aerial photography for marketing, and aerial surveys to assist with habitat mapping and wildlife surveys/monitoring.
- **City of Cape Coral** – Assisted with species surveys, burrowing owl monitoring and peeping, collapsing and setting up starter burrows.
- **City of Clewiston** – Assisted with state environmental resource and 404 permitting for utility placements.
- **Florida Bonneted Bat Surveys** – Assisted with roost surveys, emergence surveys and acoustic monitoring for various projects.
- **Lee County Utilities Wellfields**- Assisted with fish and macroinvertebrate sampling and analysis, water level monitoring, and vegetation monitoring.
- **City of Fort Myers** - Assisted with listed species surveys and Florida bonneted bat roost surveys.
- **Water Quality Monitoring** – Conducted water quality and turbidity monitoring via boat on coastal projects.
- **Mangrove Regulations** – Assisted with mangrove monitoring and mangrove trimming project permitting as well as GIS analysis.
- **Shorebird Monitoring and Reporting** – Qualified as a bird monitor to perform shorebird surveys and monitoring during beach renourishment projects.
- **Land Management** – Assisted in conducting prescribed burns, exotic removal, and native plantings for habitat restoration and mitigation.
- **Environmental Outreach** – Presented to the public on various occasions on the topics of prescribed burns, native vegetation, native landscaping, and pollinators.

HARVEY CASTRO, EI**Inspector/
CAD Technician**hcastro@johnsoneng.com
239.461.2426**Years Experience**

3 years

Education/TrainingBachelor of Science
in Civil Engineering,
Florida Gulf Coast University,
2022

FDOT Asphalt Paving I & II

FDOT Earthwork I&II

FDOT Intermediate Work Zone
Traffic Control

After completing a summer and fall internship at Johnson Engineering, Harvey graduated from FGCU with a BSC in Engineering in 2022. With his internship experience, Harvey joined the transportation group full time as an Engineering Intern and Microstation Technician. In his first two years at Johnson Engineering, Harvey led the design effort for the Crescent Avenue SCRAP funded resurfacing project in Glades County. Harvey has also served as project engineer on a number of projects in Hendry, Lee and DeSoto Counties. Harvey continues to excel and expand his knowledge in roadway design and plan production and is proficient in 3D modeling of roadway improvements utilizing OpenRoads designer.

Relevant Experience

- **County Road 835 Resurfacing (Hendry County)** – Harvey served as a design team member for this project which includes approximately three miles of roadway which is to undergo milling and resurfacing. The design is still underway.
- **County Road 760A (Desoto County)** - Harvey served as a design team member for this project which included approximately half a mile of new sidewalk along the existing road. The design is complete and awaiting construction.
- **S.W. Welles Avenue (Desoto County)** - Harvey served as a design team member for this project which included approximately half a mile of new sidewalk along the existing road. This project design also included milling and resurfacing. Design is complete and awaiting construction.
- **Gateway and Griffin Roundabout (Lee County)** - Harvey served as inspector for this intersection improvement project consisting of construction of a two by one roundabout. This project included the construction of drainage, utilities, roadway, sidewalk, and lighting facilities.
- **S.W. Hull Avenue Resurfacing (DeSoto County)** - Harvey served as an inspector for this 5-mile SCOP and SCRAP funded resurfacing project. Work duties included drainage inspection and verification testing.
- **Stoney Brook Resurfacing** - Harvey served as inspector for this 9-mile-long resurfacing and ADA improvement project.
- **Crescent Avenue Intersection Improvement** - Harvey assisted in the inspection of this signal and intersection improvement project.
- **Alico Connector** - Harvey served as a design team member for Phases I & 2. Harvey is responsible for drainage modeling on both phases and modeling of the intersection for Phase I. This project is currently underway.
- **Crescent Avenue SW** - Harvey is a design team member for milling and resurfacing of a mile of roadway in Labelle.
- **Golden Gate Parkway Bridge** - Harvey served as a design team member for Golden Gate Parkway bridge replacement and its adjacent roadway approaches.
- **Burnt Store Road South** - Harvey is a design team member for road located in Lee County, handling the record drawings.
- **Eden Park Elementary** - Harvey is a design team member for 4,000 feet of roadway located in Immokalee. Mainly handled adjustments suggested/requested from small comments on work from other techs.

MICHAEL TISEO
Designer

mtiseo@johnsoneng.com
239.461.3390

Years Experience
25 years

Education/Training
A.A. Oakland Community College

AutoCAD Civil 3D

Mike joined Johnson Engineering as a survey technician in 2006 and has worked on large scale projects including the United States Sugar Corporation boundary survey, United States Sugar Railroad corridor map, Cape Coral Utility expansion project, and a variety of projects for Florida Power & Light. He has provided clients with various surveys including boundary, topographic, hydrographic and bathymetric along with providing legal descriptions, area & volume calculations, performed deed research and establish right of ways. He has done design work on a wide range of utility and construction projects in Lee County including Daniels Force Main Extension and Green Meadows Proposed Roadway & Utility Design. Mike also coordinated the data collection and completed the Corkscrew and Pinewood Well Field Catalog Books for Lee County Utilities. Mike has also worked on bridge, sidewalk and utility replacement projects in Charlotte County that include construction plans for utilities for Gasparilla Island Bridge Authority, Year 3 Sidewalks and box culvert design and replacement plans along County Road 74 (Bermont Road).

Design Experience

- **91st & 92nd Water Main Replacement, Naples** - As designer, Mike worked on the replacement of approximately 10,000 linear feet of 12" and 8" water main in Collier County along 91st and 92nd Street located within the Naples Park area. Key design elements included identifying an alignment within congested rights of way that would accomplish project goals while minimizing impacts to the existing residents and allow the existing asbestos cement water main to remain in service during construction. Design also included provisions to remove the entire AC water main once the new system was in service.
- **Cape Coral Utility Expansion Project, Lee County** - Mike was responsible for topographic data collection of existing roadway conditions over approximately 150 miles, organizing deliverable 3D Cad drawing, field data and schedule field crews, recreating plats and established right-of-ways based upon field located monumentation and geo-referenced entire project to state plane coordinates.
- **Priority I Water Main Replacement, Bonita Springs Utilities** - As designer, Mike worked on the replacement of approximately 24,000 linear feet of 12", 8" and 4" water main in Bonita Springs along various streets located in between Bonita Beach Road and the Imperial River. Key design elements included identifying an alignment within congested rights of way that would accomplish project goals while minimizing impacts to the existing residents and allow the existing asbestos cement and class pipe water mains to remain in service during construction. Design also included several directional drills to cross creeks and other environmentally sensitive areas. Project also required close coordination with the City of Bonita Springs who owned and maintained the road rights of way. Johnson Engineering provided the survey, design, and permitting, bidding service and construction administration for this project.
- **Wiggins Pass Water Main Replacement, Collier County** - As designer, Mike worked on the replacement of approximately 8,000 linear feet of 12", 8" and 4" water main in Collier County along Wiggins Pass road and residential side streets in between Vanderbilt Drive and US41. Key design elements included identifying an alignment within the congested Wiggins Pass right of way and residential rights of way to minimize impacts to the existing residents and would allow for the community sidewalk to remain open during construction. Design included several directional drills to cross Vanderbilt Drive and other environmentally sensitive areas and to minimize sidewalk closures. Johnson Engineering provided the survey, design, directional drill calculations, permitting, bidding service and construction administration for this project.
- **Hickory Boulevard Water Main for Bonita Springs Utilities, Inc, Bonita Springs** - As designer, Mike worked on the design for replacing approximately 12,500 linear feet of 16" water main along Hickory Boulevard in Bonita Springs. Johnson Engineering provided the survey, design, permitting, bidding services and construction phase services. Johnson Engineering also assisted BSU with public awareness by holding block meetings to discuss construction activities and responding to resident concerns.

TREMAINE WHITFIELD
CAD Technician

twhitfield@johnsoneng.com
813.751.2657

Years' Experience
24 years

Education/Training
B.S. Computer Visualization
Technology (2001),
ITT Technical Institute

Tremayne joined Johnson Engineering in 2004 and works in the transportation group as a designer III. Tremayne has 24 years of experience and training in roadway design utilizing FDOT standardization. Along with his experience, he possesses excellent organizational skills, highly motivated, creative and commended for being a hard and resourceful employee. His skills include an array of software for not only roadway design, but also computer visualization.

Tremayne is also responsible for the preparation of driveway connection permit application packages for site development connection to state highways. His projects include sites requiring additional turn lanes and modifications of roadway signs on state highways. He also analyzes the traffic data and traffic reports in order to prepare recommendations for entrance design.

Design Experience

- **Hardin Combee Road Sidewalk, Polk County** – Tremayne was the lead design technician for this sidewalk project in Lakeland that included drainage improvements, right-of-way constraints, and a crossing at a 4-way stop intersection.
- **Idlewild Street Sidewalk, Polk County** – Tremayne was the lead design technician on this sidewalk project that included a significant amount of drainage modifications and grading issues that needed to be accommodated within a constrained right-of-way. This project also included bus stops which needed to be considered as part of the design.
- **Griffin Avenue Drainage Improvements, Polk County** – The purpose of this drainage project in Lakeland was to alleviate roadway ponding issues. The design consisted of the restoration of historical drainage in order to convey surface runoff to an existing wetland. Tremayne was the lead design technician on this project.
- **Gordonville Sidewalk, Polk County** – Tremayne was the lead design technician for this nearly 1-mile long multi-phase sidewalk project in the Gordonville area. This sidewalk design included areas with minimal and significant conflicts along the frontages of property owned by the County as well as privately-owned residential properties. The sidewalk was designed to meet Americans with Disabilities Act (ADA) requirements.
- **Congress Street Sidewalk, Pasco County** – Tremayne was the lead design technician for this three-quarter mile long meandering sidewalk in New Port Richey. Design elements that were part of the project included drainage modifications and utility adjustments within a partially constrained right-of-way.
- **Bell Lake Road Safety Improvements, Pasco County** - The Bell Lake Road project from east of U.S. Highway 41 to Alpine Road consisted of a road widening, new sidewalk, watermain adjustments and drainage improvements within a constrained right-of-way. Tremayne was the lead design technician responsible for roadway, drainage, and utility plan production.
- **U.S. 301 and County Road 54 Intersection Improvements, Pasco County** - The U.S. 301 and County Road 54 project consists of adding left turn lanes to County Road 54 on both sides of U.S. 301, a dedicated westbound right turn lane on the east side of U.S. 301 and the redesign of the existing traffic signal as a result of the additional lanes. Tremayne is the lead design technician responsible for roadway, signal, and drainage plan production.
- **10th Street Sidewalk, Dade City** – Tremayne was the lead design technician of this half mile long sidewalk meeting Americans with Disabilities Act (ADA) requirements. Challenges related to this project through an established residential area included (existing) steep driveways and a significant amount of existing fences and landscaping in conflict with the design.
- **7th Street Complete Streets/Alternatives Analysis, Dade City** – Tremayne was the lead design technician who prepared the color concept alternatives depicting the complete streets alternatives analysis for the 7th Street corridor between Florida Avenue and Pond Avenue through downtown Dade City. Concept alternatives included the consideration of bicycle lanes, landscaped improvements and other modifications in an effort to provide safe, convenient and comfortable travel and access for users of all ages and abilities regardless of their mode of transportation.

MICHELE NEWBURY

Technician 6



mnewbury@johnsoneng.com
239.461.2428

Years Experience
19 years

Education/Training
Three Years at Lee County High
Tech Drafting and Design
Program

Michele has been with Johnson Engineering for 19 years as a Technician 6 for the transportation department and has worked on various projects throughout Southwest Florida. Michele is familiar with FDOT Plan Preparation Assembly and the FDOT Design Criteria and Processes necessary to complete projects. Michele has several years of experience and familiar with multiple CAD platforms and software, including AutoCad and Microstation/Geopak, to make production of our plans as efficient as possible, utilizing FDOT Roadway Design Standardizations, FDOT CAD Standards, AASHTO Standards, FDOT Greenbook Standards, and the MUTCD Design Standards.

Relevant Experience

- **North Naples Sidewalks, Collier County** - Design team member for this sidewalk improvement project. Improvements included sidewalk, associated drainage and driveway reconstruction. This project was Federally Funded through FDOT's LAP program.
- **S.R. 84, Collier County** - Design team member for the Utility Work by Highway Contractor Agreement Plans in placement and relocation of one mile of utilities. Design team member for the UWHCA Dewatering Plans, and also Post-Construction Record Drawings for the UWHCA utilities.
- **S.R. 90/U.S. 41, Collier County** - Design team member for of Utility Work by Highway Contractor Agreement Plans in the placement and relocation of four miles of utility work along the State Road's corridor.
- **Helms Road, Hendry County** - Design team member of approximately three miles of new four-lane roadway in Hendry County including all associated drainage
- **Old CR 78 Sidewalks, Hendry County** - Lead designer for this LAP funded sidewalk project. This project consisted of design of 0.5 miles of sidewalk along a two-lane undivided rural roadway.
- **C.R. 78, Phases 1-5 Design, Hendry County** - Design team member for two miles of FDOT funded sidewalks along the C.R. 78 Corridor that includes resurfacing roadway, shoulder, and construction and drainage improvements. This project is currently underway.
- **Turner Intersection, DeSoto County** - Design team member for this intersection improvement project in DeSoto County. Improvements included the addition of turn lanes, sidewalk reconstruction, signalization and milling and resurfacing. This project was Federally Funded through FDOT's LAP program.
- **Six Mile Cypress Parkway, Lee County** - Design team member for design of three miles of two to four-lane roadway widening and drainage and utility improvements.
- **S.R. 739 (Metro Parkway), Lee County** - Design team member for three miles of new six-lane roadway including a bridge over a railroad.
- **S.R. 31, Lee County** - Design team member for four miles of two to four lane roadway widening including conveyance drainage adjacent to Babcock Ranch in Lee and Charlotte County.
- **The Brooks, North Outfall Conveyance, Lee County** - Design team member for the design of Lee County's LAP consisting of the re-design of one mile of conveyance parallel to U.S. 41 between Corkscrew Road and Williams Road. This project is currently underway.
- **Aqui Esta Drive, Charlotte County** - Design team member for two miles of two-lane roadway reconstruction including utility relocation and bridge replacement of the Venice Canal, and design team member of plans and record drawings for one mile of sidewalk constructed parallel to Aqui Esta Drive.
- **Del Prado Boulevard, City of Cape Coral** - Design team member for two miles of four to six-lane roadway widening including drainage and multiple bridges. Including utility relocation plans.
- **Three Oaks Imperial Parkway, City of Bonita Springs** - Design team member for four miles of new four-lane roadway and one mile of four to six-lane widening construction including a 285 foot bridge, drainage and signalization. Including utility relocation and as-built plans.
- **Piper Road, Charlotte County** - Design team member for four miles of new four-lane roadway design.
- , permitting, signalization and signing and marking. This project is currently underway.
- **S.R. 45, Charlotte County, City of Punta Gorda** - Design them member for four miles of multi-use recreational trail parallel to State Road 45/US 41.

MICHAEL GIARDULLO, P.E.

DIRECTOR OF CIVIL ENGINEERING

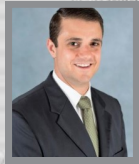
**ROLE**

PROJECT MANAGER

EDUCATION

BACHELOR OF SCIENCE

CIVIL ENGINEERING

LOYOLA MARYMOUNT UNIVERSITY

MASTER OF SCIENCE

CIVIL ENGINEERING

COLORADO STATE UNIVERSITY

LICENSURE

FLORIDA LICENSED

PROFESSIONAL ENGINEER

#70676

ADVANCED MAINTENANCE

OF TRAFFIC QUALIFICATION

FDEP QUALIFIED

STORMWATER MANAGEMENT

INSPECTOR #14470

LEED ACCREDITED PROFESSIONAL

CONTACT INFORMATION

201 W. MARION AVENUE

SUITE 1306

PUNTA GORDA, FL 33950

(941) 505-1700

MGIARDULLO@WEILERENGINEERING.ORG

RELEVANT EXPERIENCE

Mr. Giardullo has been with Weiler Engineering (WEC) for over 17 years and currently serves as the Director of Civil Engineering. Under his responsible charge, Weiler Engineering has designed, permitted, and supervised construction for numerous projects in South and Southwest Florida. Mr. Giardullo has performed design, permitting, and project management services for many municipalities and has worked very closely with FDOT, FDEP, and the SWFWMD.

REPRESENTATIVE PROJECTS**HARBORWALK AND SEAWALLS, CITY OF PUNTA GORDA, FLORIDA**

Mr. Giardullo served as project manager for this waterfront infrastructure and linear park project. The Harborwalk involves 3.3 miles of prime harbor frontage owned by the City of Punta Gorda. In addition to the design and permitting of a multi-use recreational trail which ranges in width from 10-ft to 30-ft, he was responsible for numerous park improvements including, restroom facilities, gazebos, picnic pavilions, a play ground, bocce courts, beach clean up, a small sailboat launching facility, seawall replacement parking areas, 8 separate stormwater management systems using retention treatment, roadway improvements, and pedestrian bridges. **5 Phases of this project involved the analysis of different types of seawalls and the engineering of repairs and replacement.** Mike was responsible for the permitting of these improvements through the FDOT, the SWFWMD, the ACOE, the Charlotte Harbor Aquatic Preserve and FWC. In addition to providing regular updates to the Punta Gorda City Council, Mr. Giardullo also hosted public forum meetings to gain input from the general public.

Harbor Heights Park & Boat Ramp Replacement-Punta Gorda, FL

Mr. Giardullo served the County as the Engineering of Record for this park upgrade project which was completed in numerous phases. Phases included the initial park and parking area improvements including: sport court upgrades, ADA compliant accesses and sidewalks, stormwater, site furniture and landscaping and irrigation for the whole park. Subsequent phases included expansion of sidewalks and pavilions and the replacement of the double wide boat ramp with ADA complaint access and docking. WEC has recently completed the design and permitting of the replacement of the 2 day dock piers and construction is anticipated to be complete in February of 2019. WEC is also providing CEI services for this construction as was provided in the past phases. **Currently Mr. Giardullo is working on the Harbor Heights Seawall Replacement.** This project is nearly complete and is awaiting the completion of an Archeology evaluation in order for the USACE permit to be issued.

Ponce De Leon Seawall and Boardwalk Structural Assessment and Construction Documents– City of Punta Gorda

Weiler Engineering completed a full assessment of the existing seawall and provided a detailed report of the existing seawall conditions with recommendations for repairing, determining replacement of one segment, and extending the seawall length, based on the final assessment. The report included preliminary cost estimates for any proposed repairs and for full replacement. The report also included seawall / cap repair/ replacement details, site plan showing limits of seawall and location of fishing pier, connection details of the fishing pier to the new and repaired seawall caps, and ADA compliant upgrades of the fishing pier at the transition from land. The deliverable included Engineer's Cost Estimate & Technical Specifications. Final design was included as part of additional phases. WEC delivered 100% Construction Plans and Final Construction Documents in June 2020. Currently, WEC is engaged in the construction oversight of the seawall including RFI, submittals, pay-app approvals, consulting to the City, and site visit inspections.

Weiler Engineering completed a full assessment of the existing boardwalks and fishing piers. A detailed report of the existing boardwalks and fishing piers conditions with recommendations for repairing, including options for replacement within the existing footprint, were included with the final assessment. The report also included preliminary cost estimate for proposed repairs or full replacement.

Lettuce Lake Boat Ramp-Arcadia, FL

Mr. Giardullo served as the engineer of record and project manager for the design and permitting of this boat ramp park. The design involved a double wide boat ramp, a picnic area, accommodations for a future playground, a restroom facility and parking area. The design also included a complete stormwater system involving catch basins, a dry retention area and side drains for this site along the Peace River. Timing of the permitting through the SWFWMD and ACOE was crucial due to deadlines of grant funding through the Florida Fish and Wildlife Conservation Commission.

Thomas E. Musgrave, P.E.*Geotechnical Engineer***Summary of Capabilities**

Geotechnical Engineering
 Structural Engineering
 Structural Damage Evaluations
 Structural and Geotechnical Analysis
 Project Management
 Numerical Modeling of Soft Soil Embankments
 Numerical Modeling of Soil-Structure Interaction

Years of Experience

With Tierra: 6 Years
 With Other Firms: 1 Year

Education

B.S., Civil Engineering, University of South Florida, 2011

Professional Organizations/Registrations/Awards

American Society of Civil Engineers
 American Concrete Institute
 Phi Beta Kappa Honor Society

Mr. Musgrave has worked in the field of Structural and Geotechnical Engineering for more than seven years, starting as an intern and gaining experience in structural damage assessment, structural analysis, ground subsidence, water intrusion, roof inspection, cause and origin forensic investigation, and soils and materials testing. His experience includes working on structural forensic investigations as well as FDOT roadway projects, subsidence investigations, structural bridge analysis, pavement evaluation, MSE wall analysis, corrosion testing and research. He has performed FDOT projects for Districts I, V, VII and the Florida's Turnpike Enterprise. Mr. Musgrave also has extensive experience in structural testing including GPR evaluation of concrete and steel reinforcement.

Relevant Project Experience

Collier Sheriff Operations Substation, Marco Island, Collier County
 Tiger IX Grant (Immokalee Complete Streets) Design Criteria, Collier County
 Culvert Crossing of Canal along SR 29 into the Kaicasa Development, Collier County
 Alico Road Widening from East of Ben Hill Griffin Parkway to Airport Haul Road, Lee County
 Corkscrew Road Widening from Ben Hill Griffin Parkway to Alico Road, Lee County
 North Lee County Wellfield Expansion, Lee County
 Big Carlos Pass PD&E, Lee County

FDOT District I

Districtwide Scour Evaluation for Bridges with Unknown Foundations Contract
 Districtwide Bridge Engineering Contract
 I-75 (SR 93) Widening from SR 951 to North of Golden Gate Parkway, Collier County
 SR 29 from SR 82 to Hendry County Line, Collier County
 Vanderbilt Beach Road (CR 862) Bicycle Lane Improvements, Collier County
 Sunshine Boulevard from 17th Avenue SW to Green Boulevard, Collier County
 I-75 (SR 93) Widening over the Manatee River from US-301 to SR 64, Manatee County
 I-75 (SR 93) Widening at SR 70 Interchange, Manatee County
 I-75 (SR 93) at SR 72 (Clark Road), Sarasota County
 SR 64 (Manatee Avenue) from SR 789 to Perico Bay Boulevard, Manatee County
 CR 720 (Canal Road) from SR 78 to Dead End, Glades County
 CR 733 (3rd Street/Main Street) from US 27 to US 27, Glades County
 Alico Road Widening from East of Ben Hill Griffin Parkway to Airport Haul Road, Lee County
 Metro Parkway from Winkler Avenue to North of S.R. 82, Lee County
 SR 82 from Lee C/L to Collier C/L, Hendry County
 Francisco Street from Sonora Avenue to US 27, Hendry County
 SR 82 from Homestead Rd. to Hendry C/L, Lee County
 Central Polk Parkway (Segment 4), Polk County
 Transportation Improvement Plan Projects Seminole Tribe of Florida Roadways, Hendry County

SUBCONSULTANT
COMMITMENT LETTER

TIERRA

November 12, 2025

Mr. John Glenn, PE
Johnson Engineering, LLC
2122 Johnson Street
Fort Myers, Florida 33901

RE: Letter of Commitment - City of Sanibel - Engineering Services for Sanibel Roads Reconstruction Project, CCNA-PW-1-2026/BS

Mr. Glenn:

This letter confirms that Tierra, Inc. is committed to working with Johnson Engineering, LLC. on the *City of Sanibel, Engineering Services for Sanibel Roads Reconstruction* project. We understand our role will be providing geotechnical services.

We look forward to the opportunity to work with you on this project. If additional information is needed, please contact me.

Respectfully Submitted,

TIERRA, INC.

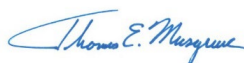

Thomas E. Musgrave, P.E.
Geotechnical Engineer

7351 Temple Terrace Highway • Tampa, FL 33637
Phone (813) 989-1354



EB-6656 – ENGINEERING SERVICES INCLUDE CIVIL | LAND DEVELOPMENT | WATERFRONT
RESORTS | UTILITIES | MUNICIPAL GOVERNMENT | STRUCTURAL | MINING | GIS - GPS

November 13, 2025

Johnson Engineering, LLC.
2122 Johnson Street
Fort Myers, Florida 33901

**Re: Letter of Commitment - City of Sanibel - Engineering Services for Sanibel Roads Reconstruction
Project, CCNA-PW-I-2026/BS**

To Whom It May Concern:

This letter confirms that Weiler Engineering Corporation is committed to working with Johnson Engineering, LLC. on the *City of Sanibel, Engineering Services for Sanibel Roads Reconstruction* project. We understand our role will be providing structural services.

We look forward to the opportunity to work with you on this project. If additional information is needed, please contact me.

Sincerely,

Weiler Engineering Corporation
Michael J. Giardullo
Director of Civil Engineering

PUNTA GORDA OFFICE: 201 WEST MARION AVENUE- SUITE 1306 | PUNTA GORDA | FL 33950 | TEL 941-505-1700 | FAX 941-505-1702
MARATHON OFFICE: 6805 OVERSEAS HIGHWAY | MARATHON | FL 33050 | TEL 305-289-4161 | FAX 305-289-4162
WE INVITE YOU TO VISIT OUR WEB SITE AT WWW.WEILERENGINEERING.ORG OR EMAIL US AT INFO@WEILERENGINEERING.ORG

BUSINESS &
PROFESSIONAL LICENSESState of Florida
Department of State

I certify from the records of this office that JOHNSON ENGINEERING, LLC is a Delaware limited liability company authorized to transact business in the State of Florida, qualified on August 29, 2024.

The document number of this limited liability company is M24000011226.

I further certify that said limited liability company has paid all fees due this office through December 31, 2025, that its most recent annual report was filed on February 6, 2025, and that its status is active.

I further certify that said limited liability company has not filed a Certificate of Withdrawal.

Given under my hand and the Great Seal of the State of Florida at Tallahassee, the Capital, this the Twelfth day of September, 2025



[Signature]
Secretary of State

Tracking Number: 0731071562CU

To authenticate this certificate, visit the following site, enter this number, and then follow the instructions displayed.
<https://services.sunbiz.org/Filing/CertificateOfStatus/CertificateAuthentication>

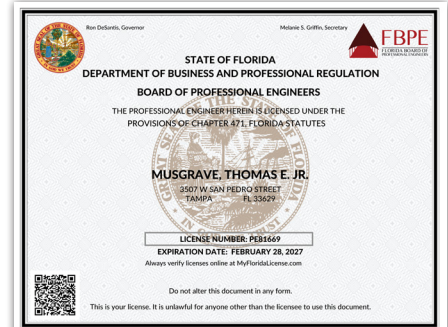
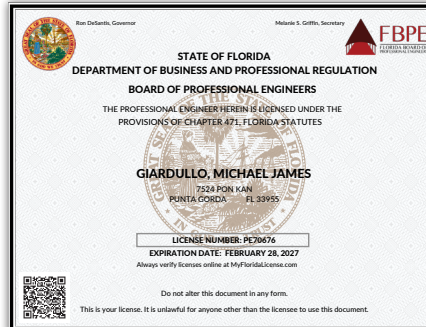
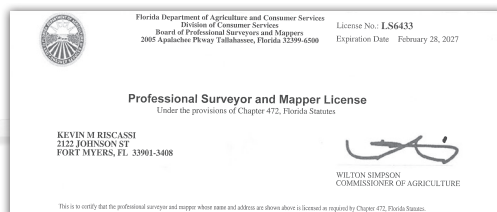
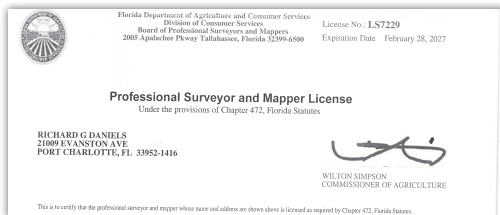
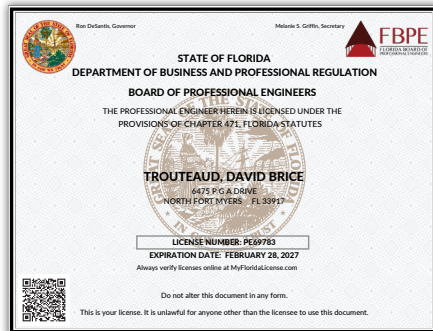
2025-2026
LEE COUNTY BUSINESS TAX RECEIPT

Account Number: 1020520
Receipt Number: 1005736
State License Number: 1b642

Account Expires: September 30, 2026

Location:
2122 JOHNSON ST
FT MYERS, FL 33901

JOHNSON ENGINEERING LLC
JOHNSON ENGINEERING LLC
2122 JOHNSON ST
FT MYERS, FL 33901

May engage in the business of:
ENGINEERING FIRM (101-0090)

THIS BUSINESS TAX RECEIPT IS NON REGULATORY

Payment Information:

PAID 09/30/2025
\$50.00

3. Experience of the Firm



JOHNSON
ENGINEERING
— An Apex Company —

CITY OF SANIBEL

2024-2025 Surface Water Management Master Plan

Project Dates:

5/2024 - Ongoing

Reference:

Mr. Scott Krawczuk
800 Dunlop Road
Sanibel, FL 33957
(239) 472-6397

scott.krawczuk@mysanibel.com



Following the storm surge impacts of Hurricane Ian (2022), Johnson Engineering is updating the Surface Water Management Master Plan for the City of Sanibel. The master plan will serve as a guide for future City actions by establishing long-range strategies focuses on flood mitigation, resiliency, and sea level rise. The updated plan will include a review of past studies and maps, public workshops, a review of the City's weir operation policy, changes to the City's stormwater management system due to the hurricane, monitoring data collection and review, and identification of repairs needed to the City's surface water management system. Johnson Engineering installed water level monitoring equipment throughout the island to capture how the water levels vary across the island and respond to rainfall and tropical storm surge events. Mapping of the City's drainage system was updated to include individual driveway culverts which were not included in past mapping efforts, resulting in an addition of 820 culverts and 2,220 swales to the maps. Rigorous field inspections of the system identified repairs that were needed at 658 drainage structures, 19,400 linear feet (3.33 miles) of culverts, and 24,200 linear feet (4.58 miles) of roadside swales.



HENDRY COUNTY

Tangent Area Safety Improvements (CR 835, CR 833, CR 846)

Project Dates:

1/2022 - 1/2023

Reference:

Hendry County
Mr. Shane Parker
PO Box 1607
LaBelle, FL 33975
(863) 675-5222
sparker@hendryfla.net



Johnson Engineering was selected to provide comprehensive design services for a federally funded resurfacing and safety improvement project encompassing **over 40 miles of rural roadways**. This initiative was delivered under the **Florida Department of Transportation's Local Agency Program (LAP)**, which requires strict adherence to federal and state design standards, documentation protocols, and quality assurance measures to ensure eligibility for 100% federal funding.

Design Process & Compliance

As part of the LAP requirements, Johnson Engineering implemented a rigorous design process that included:

- Traffic and Geotechnical Data Collection: Gathering and analyzing roadway conditions and subsurface data to establish accurate pavement designs.
- Crash History Analysis: Reviewing historical crash data to identify high-risk areas and prioritize safety enhancements.
- Clear Zone and Canal Hazard Evaluation: Assessing roadside conditions and waterway proximity to meet FDOT and AASHTO safety criteria.
- Pavement Design & Resurfacing Schemes: Developing cost-effective, durable pavement solutions tailored to rural roadway conditions.
- Bid Alternatives: Incorporating multiple bid options to provide flexibility and optimize final contract pricing.

Safety Improvements

Proposed safety enhancements included:

- Installation of guardrails and rigid barriers at bridges and culverts.
- Paved shoulders and superelevation cross-slope corrections to improve roadway geometry.
- Headwall extensions for hydraulic and structural integrity.
- Upgraded signing and pavement markings for improved visibility and compliance.
- This project demonstrates Johnson Engineering's ability to deliver **federally funded transportation projects** under LAP, balancing safety, cost efficiency, and regulatory compliance while improving critical rural infrastructure.

LEE COUNTY PORT AUTHORITY (LCPA)

Rehabilitation of Laneside Roads and Chamberlin Re-Alignment

Project Dates:

Planning Phase -
4/2016 - 2/2017

Design Phase -
1/2018 - 4/2019

Construction Phase -
1/2023 - 7/2024

Design Schedule & Completion Dates: 7/2024

Reference:

Lee County Port Authority
Mr. David Morris, PE
11000 Terminal Access Road
Suite 8671
Fort Myers FL 33913
(239) 590-4608
drmorris@flylcpa.com

Johnson Engineering was contracted by the Lee County Port Authority (LCPA) to deliver a comprehensive roadway rehabilitation program for all landside roadways within Southwest Florida International Airport (RSW). The project encompassed nearly **20 miles of roadway improvements**, including a complete redesign of the **Chamberlin Parkway Corridor**.

Project Highlights

- **Flood Resiliency:** Chamberlin Parkway, from Daniels Parkway to Regional Lane, historically experienced flooding during major rain events and hurricanes. Johnson Engineering conducted a **600-acre basin analysis** to determine peak stages and improve cross-drain hydraulics. Low-lying areas were raised, significantly enhancing roadway resiliency.
- **Safety & Development:** Chamberlin Parkway from Regional Lane to Paul J. Doherty Parkway was **re-aligned** to improve traffic safety and maximize development opportunities. Originally designed as a circulator for the old terminal, the new alignment supports future growth and operational efficiency.
- **Comprehensive Design Services:** The project included design for **landscaping, irrigation, utilities, lighting, and drainage**, ensuring functionality and aesthetics throughout the corridor.
- **Pavement Management:** Over **20 miles of resurfacing plans** were developed for internal roadways within LCPA property. A preliminary planning phase included alignment analysis and a **long-term pavement management plan** for each rehabilitation segment.



LEE COUNTY Corkscrew Road Phases 1 & 2

Project Dates:

2020 - Ongoing

Reference:

Lee County
Mr. David Murphy
PO Box 398
Fort Myers, FL 33902
(239) 533-8578
dmurphy@leegov.com

Johnson Engineering provided comprehensive design and permitting services for the Corkscrew Road widening project in Lee County. This multi-phase initiative incorporated pavement restoration, drainage enhancements, environmental accommodations, utility upgrades, landscape design, and signalization improvements.

Phase 1

Originally permitted and partially constructed, Phase 1 required modifications to the existing permit to accommodate an ultimate six-lane typical section. The western portion of the corridor was designed for an initial full six-lane construction, while the eastern segment was built as a four-lane facility with infrastructure provisions for future expansion. This phase encompassed more than two miles of roadway, multiple box culverts, a wildlife crossing bridge, and all associated drainage and utility systems. Phase 1 has been successfully completed.

Phase 2

Phase 2 extends the improvements by widening an additional 1.5 miles from two to four lanes. It includes construction of stormwater facilities, utility upgrades, and installation of a traffic signal at the Alico Road and Corkscrew Road intersection. Additionally, regional drainage accommodations at the eastern limits are being implemented to improve hydraulic connectivity throughout the area.

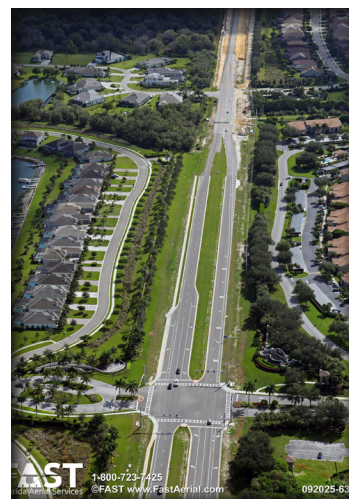

4. Capacity of Firm





Johnson Engineering has built strong, collaborative relationships with the City of Sanibel over many years, developing a deep understanding of your goals and expectations. Our priority is to provide responsive, dependable service that meets the high standards Sanibel's residents and staff expect. We are fully staffed with experienced professionals and have the financial strength and technical capacity to meet deadlines, maintain quality, and manage concurrent municipal projects without additional hires. This project will be managed through our Fort Myers office, with key project managers and field personnel maintaining a consistent presence in Sanibel. Local oversight ensures prompt decision-making and hands-on leadership throughout each phase. While our team is engaged in other municipal assignments, we have allocated resources to prioritize the City's projects without interruption. Clear communication and reporting protocols will support transparency and accountability. Our proven track record with the City reflects our commitment to quality service, and we look forward to continuing that partnership.



Following our recent merger with the Apex family of companies, our resources have expanded to nearly 1,800 professionals. For this project, we have partnered with Weiler Engineering, an Apex division with extensive CDBG and roadway experience, to provide additional expertise for the accelerated schedule if needed.

Team Selection

Each project is staffed with specialists selected for their expertise in the specific scope of work. Jordan will lead the team selection process, ensuring continuity and collaboration among professionals who have successfully worked together on past assignments. Regular team meetings will address updates, challenges, and schedule adjustments as needed.

Communication

We implement a proactive communication plan to keep City staff informed throughout every phase. If issues arise, the City's project manager will be notified immediately along with a proposed solution. Direct and consistent communication between our project manager and City staff will ensure alignment on progress, strategies, and deliverables.



TEAM WORKLOAD

All key team members have sufficient availability and are prepared to dedicate the necessary time and effort for this project. We also have flexibility and considerable additional resources to accommodate the City's schedule. A summary of the firm's availability for the next year is below.

Current percentage of recent, current and projected workload of the proposing firm.

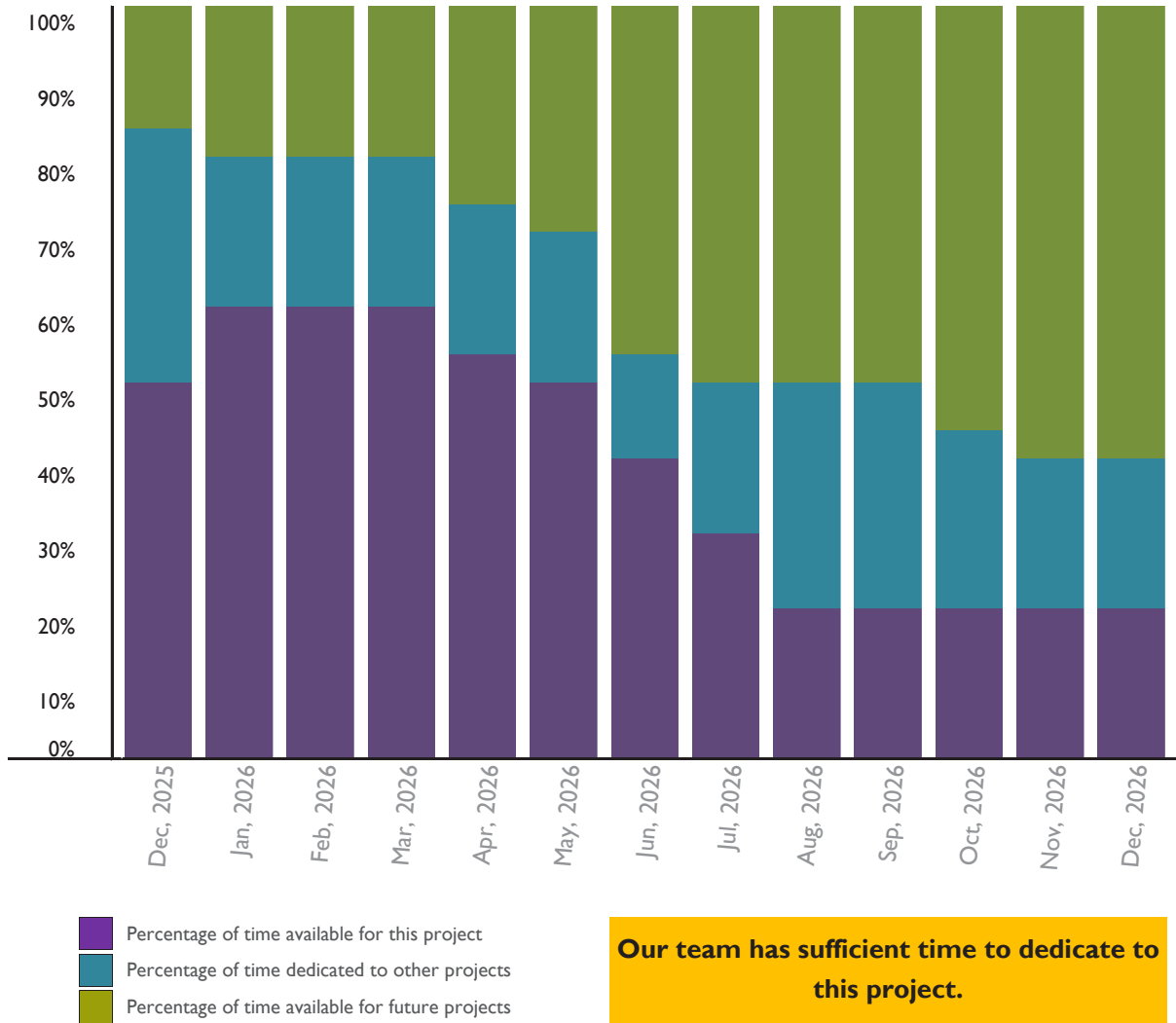

5. Required Forms



REFERENCES
REFERENCE INFORMATION MUST BE COMPLETED AND RETURNED WITH PROPOSAL
Please use this form or a reasonable facsimile.

PROVIDE AT LEAST THREE REFERENCES FOR WHOM YOUR COMPANY HAS PROVIDED SAME OR SIMILAR SERVICES WITHIN THE LAST 8 YEARS.

COMPANY NAME: Hendry County

ADDRESS: P. O. Box 963, LaBelle, FL 33975

TELEPHONE: (863) 675-5222

CONTACT PERSON: Shane Parker, PE

COMPANY NAME: Lee County

ADDRESS: 1500 Monroe Street, Fort Myers, FL 33901

TELEPHONE: (239) 533-8577

CONTACT PERSON: Vince Miller, PE

COMPANY NAME: Charlotte County

ADDRESS: 410 Taylor Street, Unit 104, Punta Gorda FL 33950

TELEPHONE: (941) 575-3609

CONTACT PERSON: Zach Patchell

**AFFIDAVIT OF COMPLIANCE WITH SECTIONS 287.138 and 787.06,
FLORIDA STATUTES**

Before me, the undersigned authority, personally appeared (Name of affiant),
Lonnie V. Howard who, after being first duly sworn, deposes and

1. Affiant is the (Title) Vice President of (Business Name)
Johnson Engineering, LLC. which does
business in the State of Florida, hereinafter called the "Vendor."
2. Vendor, pursuant to Section 287.138, Florida Statutes, certifies that (1) Vendor is not owned by a government of a foreign country of concern; (2) a government of a foreign country of concern does not have a "controlling interest" in Vendor, as defined by Section 287.138(1)(a), Florida Statutes; and (3) Vendor is not organized under the law of nor has its principal place of business in a foreign country of concern. For the purposes of this affidavit, foreign country of concern means the People's Republic of China, the Russian Federation, the Islamic Republic of Iran, the Democratic People's Republic of Korea, the Republic of Cuba, the Venezuelan regime of Nicolás Maduro, or the Syrian Arab Republic, including any agency of or any other entity of significant control of such foreign country of concern, as defined in Section 287.138(1)(c), Florida Statutes, as amended from time to time.
3. Vendor, pursuant to Section 787.06, Florida Statutes, certifies that Vendor does not use coercion for labor or services as defined in Section 787.06, Florida Statutes, as amended from time to time.
4. This Affidavit is executed by the Vendor in accordance with Section 287.138, Florida Statutes, for the purposes of preventing the City from entering contracts with foreign entities of concern which would provide Vendor access to an individual's personal identifying information.
5. This Affidavit is executed by the Vendor in accordance with Section 787.06, Florida Statutes.

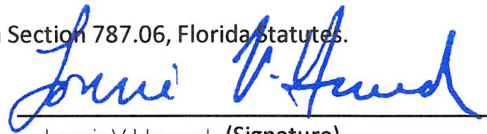

Lonnie V. Howard (Signature)

November 13, 2025

(Date)

STATE OF Florida

COUNTY OF Hendry

Sworn to (or affirmed) and subscribed before me, by means of ☒ physical presence or ☐ online notarization,
this 13th day of November 20 25, by Lonnie V. Howard who ~~has produced~~ is
(Print or Type Name)

personally known as identification.
(Type of Identification)

[Signature]
Notary Public Signature

Michelle F. Colindres
Printed Name of Notary Public

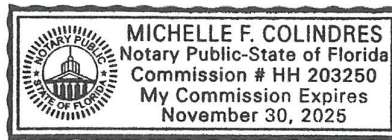

HH 203250 / November 30, 2025
Notary Commission Number/Expiration



City of Sanibel

ADDENDUM NO. 1
October 30, 2025

RE: Engineering services for Sanibel Roads Reconstruction Project (CCNA-PW-1-2026/BS)
Proposal due date: November 13, 2025 @ 2:30PM

FROM: City of Sanibel
800 Dunlop Road
Sanibel, FL 33957

TO: Prospective Bidders and Others Concerned

This addendum is hereby incorporated into the bid documents of the project referenced above. The following items are clarifications, corrections, additions, deletions, and/or revisions to and shall take precedence over the original document.

A. Questions and Answers

Question No. 1: If known, what is the anticipated schedule for bidding and construction of this project?

Response No. 1: Please see the timeline included in the bid:
SELECTION PROCESS AND SCHEDULE
Issue RFQ.....October 13, 2025
Proposals Due to City.....November 13, 2025, 2:30
Public Meeting Evaluation Committee Review of Proposals....Week of December 01, 2025
Public Meeting with the top three ranked firms and Final Recommendation to City CouncilWeek of December 15, 2025
City Council Meeting to Approve RecommendationJanuary 13, 2026

A. ACKNOWLEDGEMENT OF ADDENDA

- a. The Bidder shall acknowledge receipt of this addendum by completing the applicable section in the solicitation or by completion of the acknowledgement information on the addendum. Either form of acknowledgement must be completed and returned not later than the date and time for receipt of bid.
- b. All other terms, conditions and specifications of CCNA-PW-1-2026/BS remain the same.
- c. Receipt acknowledged by:

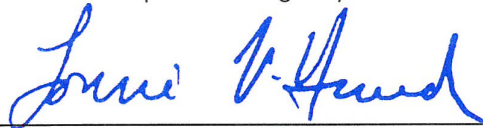

November 13, 2025

Authorized Signature & Date Signed Lonnie V. Howard

Vice President

Title

Johnson Engineering, LLC.

Name of Firm

INSURANCE CERTIFICATE

ACORD®		CERTIFICATE OF LIABILITY INSURANCE		DATE (MM/DD/YYYY) 11/11/2025			
<p>THIS CERTIFICATE IS ISSUED AS A MATTER OF INFORMATION ONLY AND CONFERS NO RIGHTS UPON THE CERTIFICATE HOLDER. THIS CERTIFICATE DOES NOT AFFIRMATIVELY OR NEGATIVELY AMEND, EXTEND OR ALTER THE COVERAGE AFFORDED BY THE POLICIES BELOW. THIS CERTIFICATE OF INSURANCE DOES NOT CONSTITUTE A CONTRACT BETWEEN THE ISSUING INSURER(S), AUTHORIZED REPRESENTATIVE OR PRODUCER, AND THE CERTIFICATE HOLDER.</p> <p>IMPORTANT: If the certificate holder is an ADDITIONAL INSURED, the policy(ies) must have ADDITIONAL INSURED provisions or be endorsed. If SUBROGATION IS WAIVED, subject to the terms and conditions of the policy, certain policies may require an endorsement. A statement on this certificate does not confer rights to the certificate holder in lieu of such endorsement(s).</p>							
PRODUCER Graham Company, a Marsh & McLennan Agency, LLC company 30 S 15th Street, 20th Floor Philadelphia PA 19102			CONTACT NAME: John Kilgariff/Brianne Sullivan PHONE (A/C, No, Ext): 215-701-5440 FAX (A/C, No): E-MAIL ADDRESS: MMAEastGrahamKilgariffUnit@MarshMMA.com				
INSURED Johnson Engineering, LLC. 2122 Johnson Street Fort Myers, FL 33901-3408			APEXCOM-01		INSURER(S) AFFORDING COVERAGE		
			INSURER A : Starr Surplus Lines Insurance Company		NAIC #		
			INSURER B : Tokio Marine America Insurance Company		13604		
			INSURER C : Zurich-American Insurance Company		10945		
			INSURER D :		16535		
			INSURER E :				
INSURER F :							
COVERAGES CERTIFICATE NUMBER: 413329396 REVISION NUMBER:							
<p>THIS IS TO CERTIFY THAT THE POLICIES OF INSURANCE LISTED BELOW HAVE BEEN ISSUED TO THE INSURED NAMED ABOVE FOR THE POLICY PERIOD INDICATED. NOTWITHSTANDING ANY REQUIREMENT, TERM OR CONDITION OF ANY CONTRACT OR OTHER DOCUMENT WITH RESPECT TO WHICH THIS CERTIFICATE MAY BE ISSUED OR MAY PERTAIN, THE INSURANCE AFFORDED BY THE POLICIES DESCRIBED HEREIN IS SUBJECT TO ALL THE TERMS, EXCLUSIONS AND CONDITIONS OF SUCH POLICIES. LIMITS SHOWN MAY HAVE BEEN REDUCED BY PAID CLAIMS.</p>							
INSR LTR	TYPE OF INSURANCE	ADDL INSR	SUBR WVD	POLICY NUMBER	POLICY EFF (MM/DD/YYYY)	POLICY EXP (MM/DD/YYYY)	LIMITS
A	<input checked="" type="checkbox"/> COMMERCIAL GENERAL LIABILITY <input type="checkbox"/> CLAIMS-MADE <input checked="" type="checkbox"/> OCCUR GEN'L AGGREGATE LIMIT APPLIES PER: <input type="checkbox"/> POLICY <input checked="" type="checkbox"/> PRO-JECT <input checked="" type="checkbox"/> LOC <input type="checkbox"/> OTHER:	Y		1000065707251	7/31/2025	7/31/2026	EACH OCCURRENCE \$ 1,000,000 DAMAGE TO RENTED PREMISES (Ea occurrence) \$ 300,000 MED EXP (Any one person) \$ 25,000 PERSONAL & ADV INJURY \$ 1,000,000 GENERAL AGGREGATE \$ 2,000,000 PRODUCTS - COMP/OP AGG \$ 2,000,000 \$
C	AUTOMOBILE LIABILITY <input checked="" type="checkbox"/> ANY AUTO <input type="checkbox"/> OWNED AUTOS ONLY <input type="checkbox"/> SCHEDULED AUTOS <input type="checkbox"/> HIRED AUTOS ONLY <input type="checkbox"/> NON-OWNED AUTOS ONLY <input checked="" type="checkbox"/> \$10,000 Comp <input checked="" type="checkbox"/> \$10,000 Coll			BAP-6393348-01	7/31/2025	7/31/2026	COMBINED SINGLE LIMIT (Ea accident) \$ 1,000,000 BODILY INJURY (Per person) \$ BODILY INJURY (Per accident) \$ PROPERTY DAMAGE (Per accident) \$ \$
A	<input checked="" type="checkbox"/> UMBRELLA LIAB <input checked="" type="checkbox"/> OCCUR <input checked="" type="checkbox"/> EXCESS LIAB <input type="checkbox"/> CLAIMS-MADE DED RETENTION \$			1000336571251	7/31/2025	7/31/2026	EACH OCCURRENCE \$ 10,000,000 AGGREGATE \$ 10,000,000 \$
C	WORKERS COMPENSATION AND EMPLOYERS' LIABILITY ANY PROPRIETOR/PARTNER/EXECUTIVE OFFICER/MEMBER EXCLUDED? (Mandatory in NH) If yes, describe under DESCRIPTION OF OPERATIONS below	Y/N N	N/A	WC-6393347-01	7/31/2025	7/31/2026	<input checked="" type="checkbox"/> PER STATUTE <input type="checkbox"/> OTH-ER E.L. EACH ACCIDENT \$ 1,000,000 E.L. DISEASE - EA EMPLOYEE \$ 1,000,000 E.L. DISEASE - POLICY LIMIT \$ 1,000,000
A A B	Professional Liability Pollution Liability Contractors Equipment			1000065707251 1000065707251 CPP6411631-03	7/31/2025 7/31/2025 7/31/2025	7/31/2026 7/31/2026 7/31/2026	Per Claim / Agg \$1M / \$2M Per Occ / Agg \$1M / \$2M Leased/Rented Equip \$325,000
DESCRIPTION OF OPERATIONS / LOCATIONS / VEHICLES (ACORD 101, Additional Remarks Schedule, may be attached if more space is required) Property Policy - Tokio Marine America Insurance Company Policy #CPP6411631-03 ; Policy Period 7/31/2025 - 7/31/2026 Excess Policy - Nautilus Insurance Co. Policy #FFX2047705-10; \$10,000,000 per occurrence/Aggregate; Policy Period 7/31/2025 - 7/31/2026 Excess Policy - Ironshore Specialty Ins. Co. Policy #XSCUW0033575200; \$5,000,000 per occurrence/Aggregate; Policy Period 7/31/2025 - 7/31/2026 RE: City of Sanibel – Engineering Services for Sanibel Roads Reconstruction, CCNA-PW-1-2026/BS City of Sanibel are additional insureds on the above General Liability Policy, and coverage shall apply on a Primary and Non-Contributory basis if required by written contract. See Attached...							
CERTIFICATE HOLDER				CANCELLATION			
The City of Sanibel 800 Dunlop Road Sanibel FL 33957				SHOULD ANY OF THE ABOVE DESCRIBED POLICIES BE CANCELLED BEFORE THE EXPIRATION DATE THEREOF, NOTICE WILL BE DELIVERED IN ACCORDANCE WITH THE POLICY PROVISIONS.			
				AUTHORIZED REPRESENTATIVE 			
© 1988-2015 ACORD CORPORATION. All rights reserved. ACORD 25 (2016/03) The ACORD name and logo are registered marks of ACORD							

Last updated by lonnie howard on Mar 27, 2025 at 03:39 PM



JOHNSON ENGINEERING, LLC

Unique Entity ID E5YAS5CSVHM7	CAGE / NCAGE 119A8	Purpose of Registration All Awards
Registration Status Active Registration	Expiration Date Mar 27, 2026	
Physical Address 2101 Galtier RD STE 500 Rockville, Maryland 20850-4068 United States	Mailing Address 2101 Galtier RD STE 500 Rockville, Maryland 20850-4068 United States	

Business Information

Doing Business as (blank)	Division Name (blank)	Division Number (blank)
Congressional District Maryland 08	State / Country of Incorporation Delaware / United States	URL (blank)

Registration Dates

Activation Date Apr 8, 2025	Submission Date Mar 27, 2025	Initial Registration Date Mar 25, 2025
---------------------------------------	--	--

Entity Dates

Entity Start Date Aug 28, 2024	Fiscal Year End Close Date Dec 31
--	---

Immediate Owner

CAGE 0D3Z8	Legal Business Name APEX COMPANIES, LLC
----------------------	---

Highest Level Owner

CAGE (blank)	Legal Business Name (blank)
------------------------	---------------------------------------

Executive Compensation

Registrants in the System for Award Management (SAM) respond to the Executive Compensation questions in accordance with P.L. 110-252, amending the Federal Funding Accountability and Transparency Act (P.L. 109-282). This information is sent to USAspending.gov for display in association with an eligible award. Maintaining an active registration in SAM.gov demonstrates the registrant responded to the questions.

Proceedings Questions

Registrants in the System for Award Management (SAM.gov) respond to proceedings questions in accordance with or 2. C.F.R. 200 Appendix XII. Their responses are displayed in the responsibility/qualification section of SAM.gov registration in SAM.gov demonstrates the registrant responded to the proceedings questions.

Exclusion Summary

Active Exclusions Records?

No

SAM Search Authorization

I authorize my entity's non-sensitive information to be displayed in SAM public search results:

Yes

Entity Types

Business Types	Entity Type
Entity Structure Corporate Entity (Not Tax Exempt)	Business or Organization
Profit Structure For Profit Organization	

Sep 24, 2025 10:51:54 PM GMT
<https://sam.gov/entity/E5YAS5CSVHM7/coreData?status=null>

JOHNSON ENGINEERING, LLC

Last updated by lonnie howard on Mar 27, 2025 at 03:39 PM

Socio-Economic Types

Check the registrant's Reps & Certs, if present, under FAR 52.212-3 or FAR 52.219-1 to determine if the entity is an SBA-certified HUBZone small business concern. Additional small business information may be found in the SBA's Dynamic Small Business Search if the entity completed the SBA supplemental pages during registration.

Financial Information

Accepts Credit Card Payments No	Debt Subject To Offset No
EFT Indicator 0000	CAGE Code 119A8

Points of Contact

Electronic Business

Lonnie V. Howard	2122 Johnson Street Fort Myers, Florida 33901 United States
Lonnie V. Howard	2122 Johnson Street Fort Myers, Florida 33901 United States

Government Business

Lonnie V. Howard	2122 Johnson Street Fort Myers, Florida 33901 United States
Lonnie V. Howard	2122 Johnson Street Fort Myers, Florida 33901 United States

Past Performance

Lonnie V. Howard	2122 Johnson Street Fort Myers, Florida 33901 United States
Lonnie V. Howard	2122 Johnson Street Fort Myers, Florida 33901 United States

Service Classifications

NAICS Codes	NAICS Codes	NAICS Title
Primary Yes	541330	Engineering Services
	541370	Surveying And Mapping (Except Geophysical) Services

Disaster Response

This entity does not appear in the disaster response registry.

Sep 24, 2025 10:51:54 PM GMT
<https://sam.gov/entity/E5YAS5CSVHM7/coreData?status=null>

Page 2 of 2

Company ID Number: 46959
Client Company ID Number: 345924

Company Name: JOHNSON ENGINEERING, INC.

Company Facility Address: 2122 JOHNSON ST

FORT MYERS, FL 33902

County or Parish: LEE

Employer Identification

Number: 591173834

North American Industry
Classification Systems

Code: 541

Parent Company:

Number of Employees: 100 to 499

Page 15 of 15 | E-Verify MOU for Employer (Client) using a Designated Agent | Revision Date 09/01/09