



City of Sanibel

**ADDENDUM NO. 5  
May 19, 2026**

RE: Fishing Pier Temporary Repairs Project (ITB-BP-0-2026/JH) Proposal due date: May 28, 2026 @ 2:30PM

FROM: City of Sanibel  
800 Dunlop Road  
Sanibel, FL 33957

TO: Prospective Bidders and Others Concerned

This addendum is hereby incorporated into the bid documents of the project referenced above. The following items are clarifications, corrections, additions, deletions, and/or revisions to and shall take precedence over the original document.

- A. Revised Plans**
- B. Revised Bid Tabulation**

**A. ACKNOWLEDGEMENT OF ADDENDA**

- a. The Bidder shall acknowledge receipt of this addendum by completing the applicable section in the solicitation or by completion of the acknowledgement information on the addendum. Either form of acknowledgement must be completed and returned not later than the date and time for receipt of bid.
- b. All other terms, conditions and specifications of ITB-BP-0-2026/JH remain the same.
- c. Receipt acknowledged by:

---

Authorized Signature & Date Signed

---

Title

---

Name of Firm

**STRUCTURAL INFORMATION:**

1. **DESIGN CODE DATA:**
  - A. 2020-2021 INTERNATIONAL BUILDING CODE
  - B. 2023 FLORIDA BUILDING CODE, BUILDING
  - C. ASCE 7.22: MINIMUM DESIGN LOADS FOR BUILDINGS AND OTHER STRUCTURES
  - D. ANSI/APA NDS 2005: NATIONAL DESIGN SPECIFICATION FOR WOOD STRUCTURES
2. **DESIGN LOADS:**
  - A. **DEAD LOADS:**
    - DOCK: 20 PSF
  - LIVELOADS:**
    - DOCK: 100 PSF
  - B. **WIND DESIGN CRITERIA:**
    - WIND SPEED: 170 MPH (ULT)
    - WIND SPEED: 132 MPH (NOMINAL)
    - EXPOSURE: D
    - RISK CATEGORY: II
    - ENCLOSURE CLASSIFICATION: OPEN
    - INTERNAL PRESSURE COEFFICIENT: 0.00
3. **MAXIMUM ALLOWABLE DEFLECTION CRITERIA:**
  - DECK: L/360 LIVE LOAD; L/240 TOTAL LOAD

# 144 PERIWINKLE WAY

## FISHING PIER TEMPORARY REPAIRS PENDING FULL REPLACEMENT

### LEE COUNTY

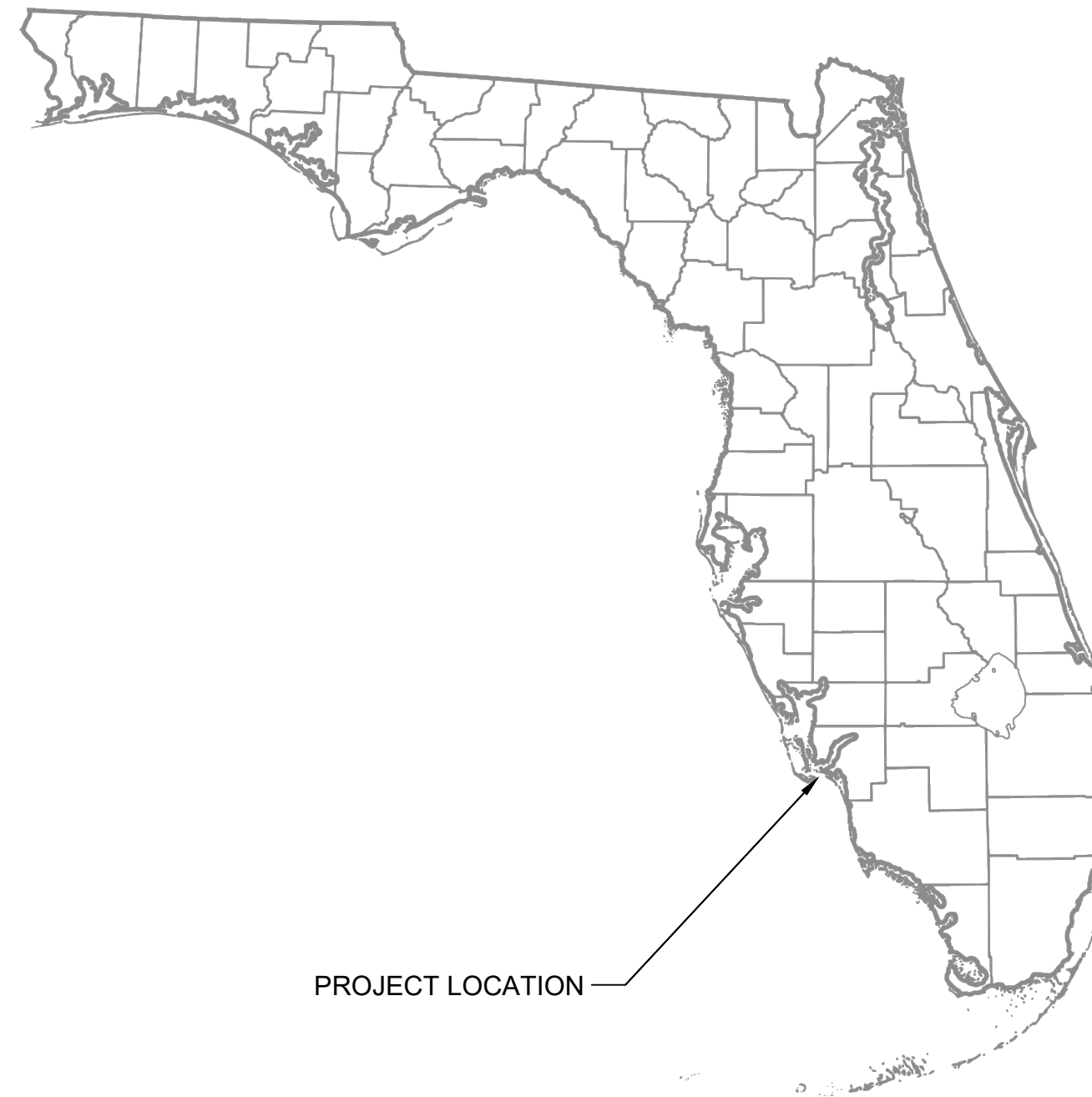

**SUBJECT PROPERTY:**

CITY OF SANIBEL  
144 PERIWINKLE WAY  
SANIBEL, FL 33957

PARCEL NUMBER: 1-46-23-T2-00038.0000  
LAT/LONG: 26°27'17.01"N 82° 0'55.88"W  
WATERWAY: SAN CARLOS BAY

**DESIGN INFORMATION:**

MEAN HIGH WATER (MHW) NAVD88: +0.18'  
MEAN LOW WATER (MLW) NAVD88: -1.5'

**SHEET INDEX**

- S-1 COVER SHEET
- S-2 PLAN & PROFILE
- S-3 DETAILS 1
- S-4 DETAILS 2

**REVISION DATES:**

- R1 5/7/2026
- R2 5/17/2026

**ADDENDUM NO. 5**

THIS ITEM HAS BEEN DIGITALLY SIGNED AND SEALED BY CLAY MCCOY P.E., ON THE DATE ADJACENT TO THE SEAL.

SIGNATURE MUST BE VERIFIED ON ANY ELECTRONIC COPIES.

5/17/2026

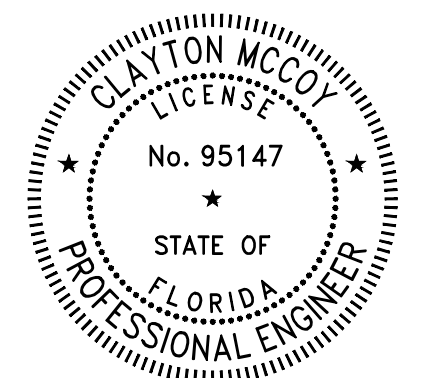

FISHING PIER TEMPORARY REPAIRS PENDING FULL REPLACEMENT

**COVER SHEET**

DRAWN BY:  
CLAYTON MCCOY, PE

CHECKED BY:  
ASA HUNT, PE

EOR:  
CLAYTON MCCOY, PE

NO.	DESCRIPTION	DATE



CLAYTON MCCOY, PE  
PE LICENSE NO 95147  
25 W CEDAR ST, SUITE 140  
PENSACOLA, FL 32502

SUBJECT PROPERTY:  
CITY OF SANIBEL  
144 PERIWINKLE WAY  
SANIBEL, FL 33957

PROJECT NO. FL-2026-090	SHEET <b>S-1</b>
DATE 5/17/2026	
SCALE N/A	

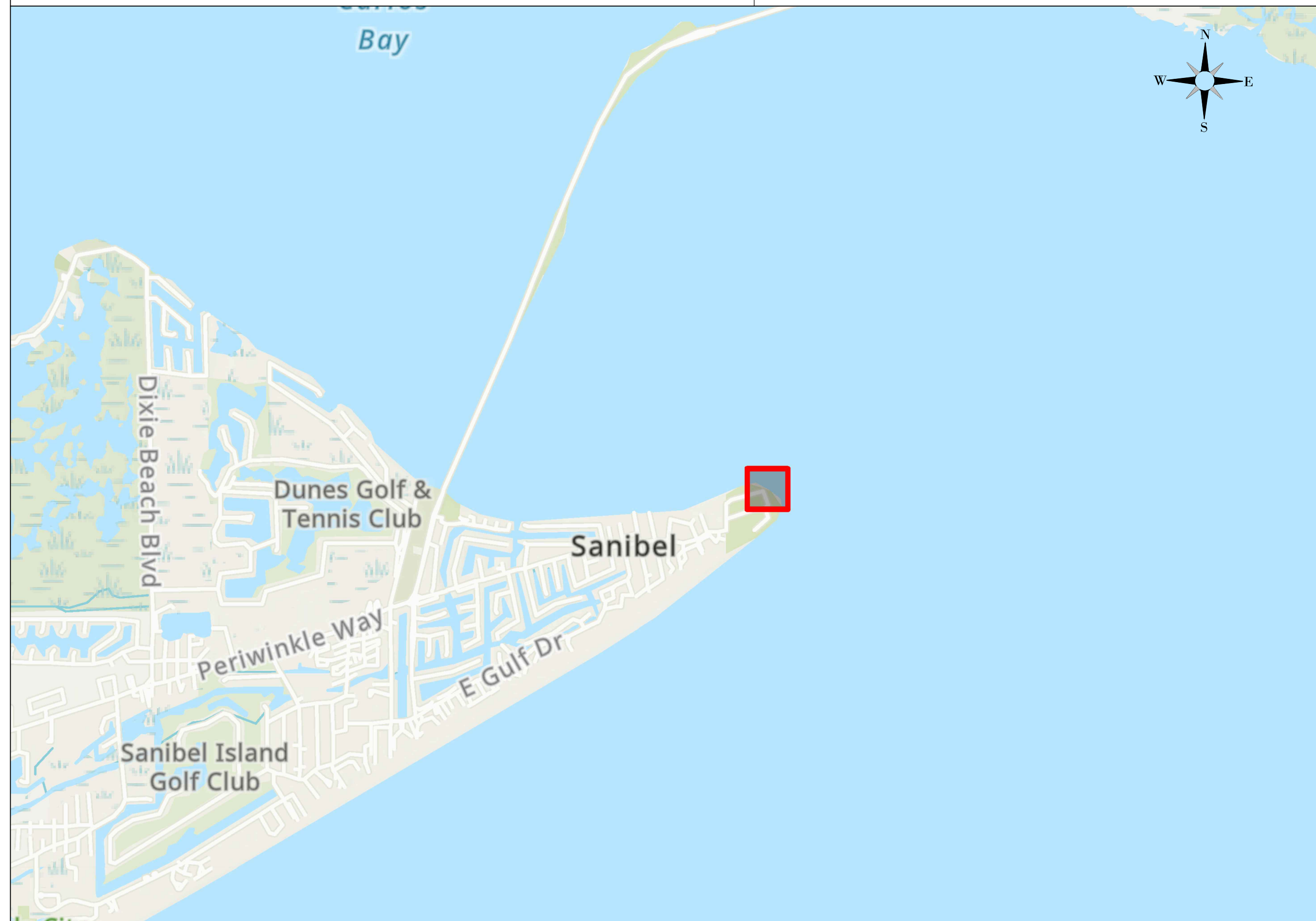

# FISHING PIER TEMPORARY REPAIRS PENDING FULL REPLACEMENT

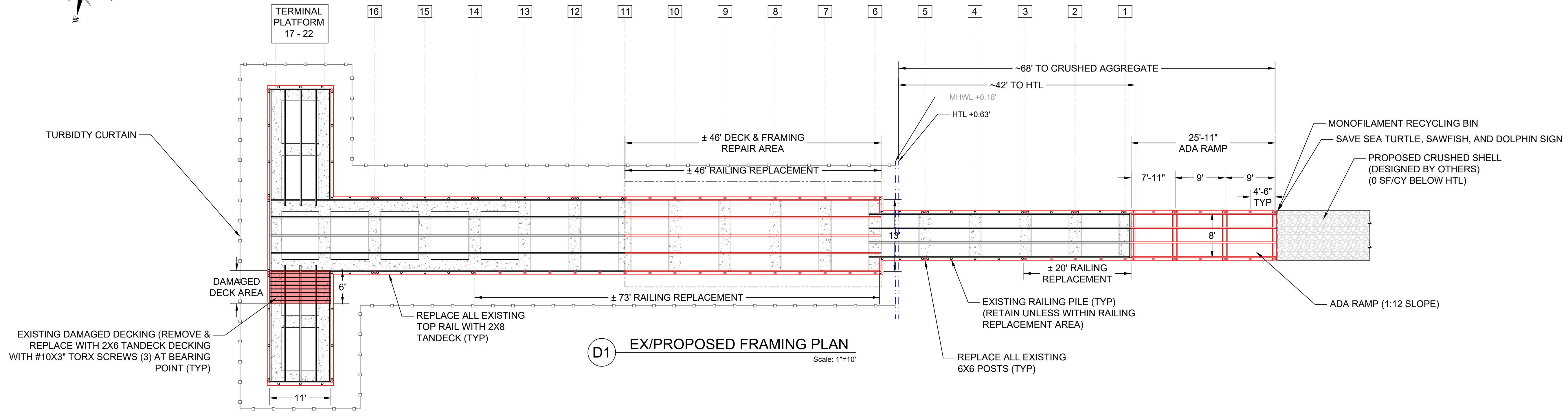
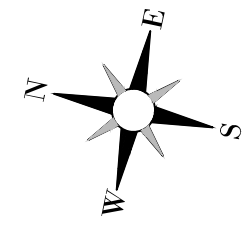

**D1 EX/PROPOSED FRAMING PLAN**  
Scale: 1"=10'

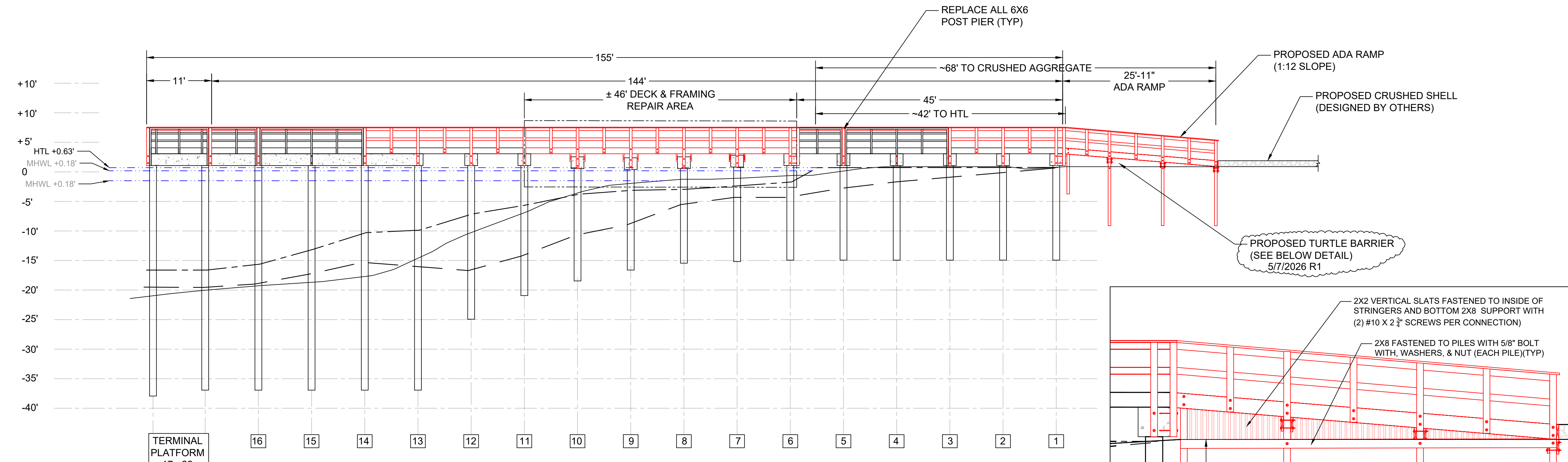

**D2 EX/PROPOSED PROFILE**  
Scale: 1"=10'

**WATER BOTTOM LEGEND:**

—	ORIGINAL DESIGN
- - -	12/16/2023 STANTEC
- · - · -	2/6/2026 SHORELINE ENGINEERING

**EXISTING DOCK REPAIR LEGEND:**

—	EXISTING (RETAIN)
—	PROPOSED WORK

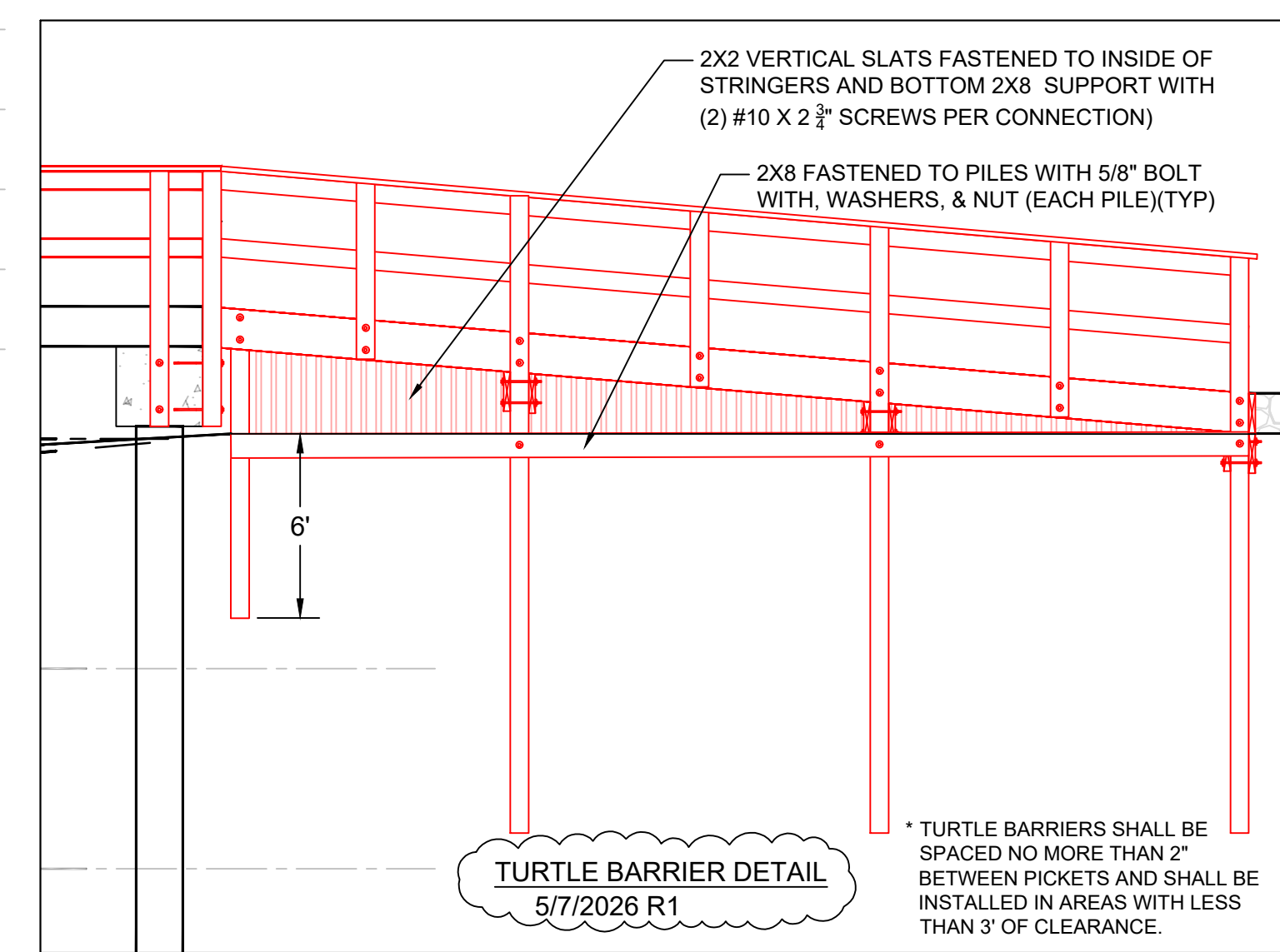

**TURTLE BARRIER DETAIL**  
5/7/2026 R1

\* TURTLE BARRIERS SHALL BE SPACED NO MORE THAN 2' BETWEEN PICKETS AND SHALL BE INSTALLED IN AREAS WITH LESS THAN 3' OF CLEARANCE.

- REVISIONS:**
- 5/7/2026 - ADDED TURTLE BARRIER DETAIL

FISHING PIER TEMPORARY REPAIRS PENDING FULL REPLACEMENT

PLAN & PROFILE

DRAWN BY:  
CLAYTON MCCOY, PE

CHECKED BY:  
ASA HUNT, PE

EOR:  
CLAYTON MCCOY, PE

NO.	DESCRIPTION	DATE

**SHORELINE ENGINEERING**  
CLAYTON MCCOY, PE  
PE LICENSE NO 95147  
25 W CEDAR ST, SUITE 140  
PENSACOLA, FL 32502

SUBJECT PROPERTY:  
CITY OF SANIBEL  
144 PERIWINKLE WAY  
SANIBEL, FL 33957

PROJECT NO. FL-2026-090	SHEET <b>S-2</b>
DATE 5/17/2026	
1"=10' 22X34	1"=20' 11X17

# FISHING PIER TEMPORARY REPAIRS PENDING FULL REPLACEMENT

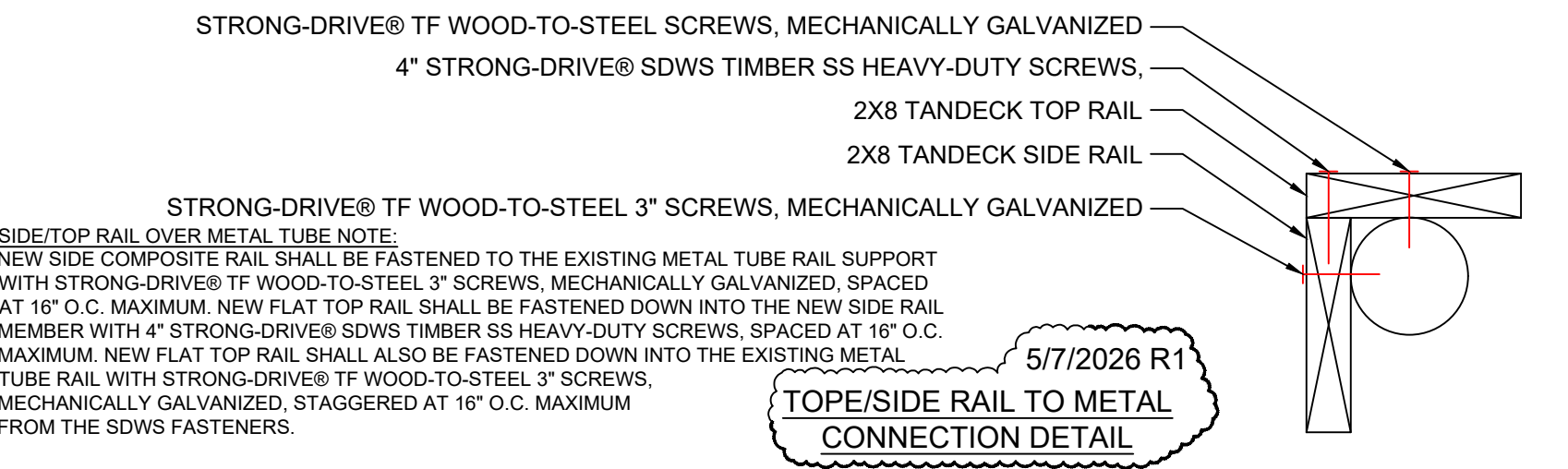
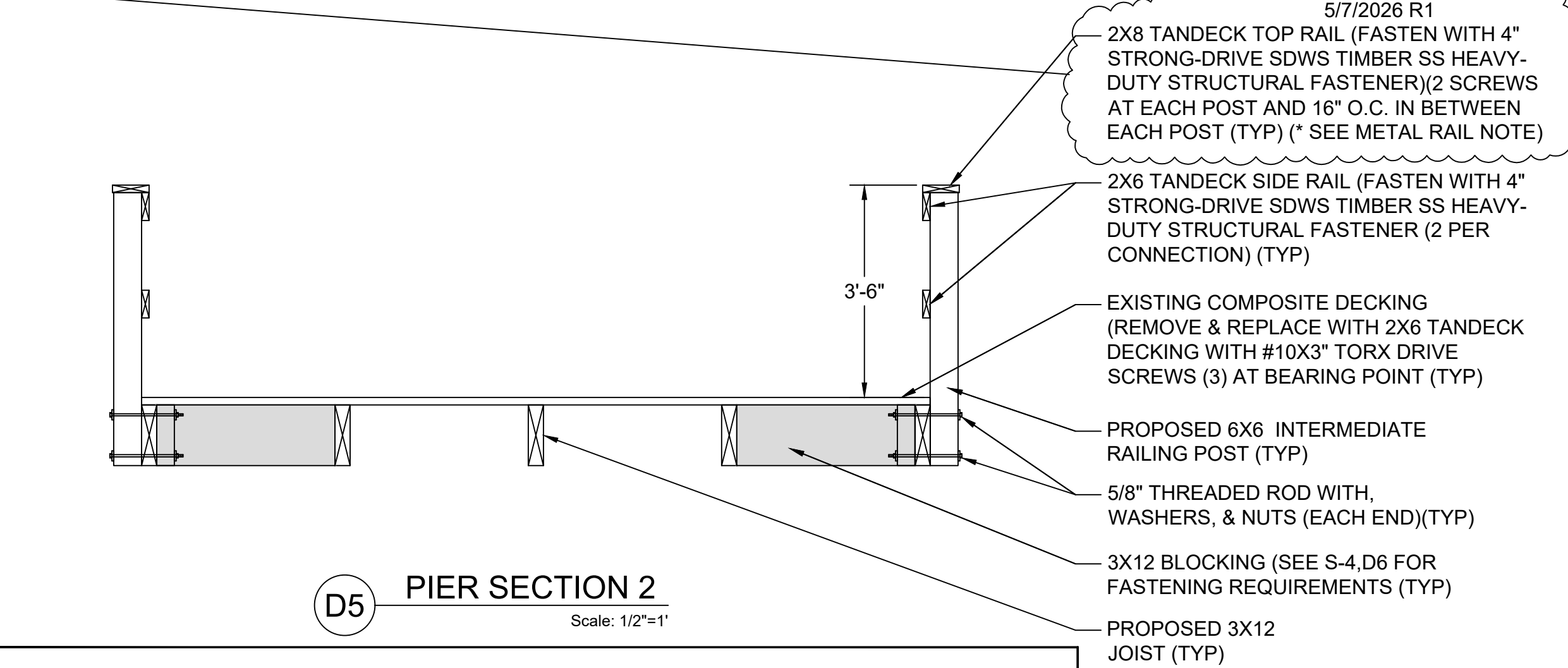
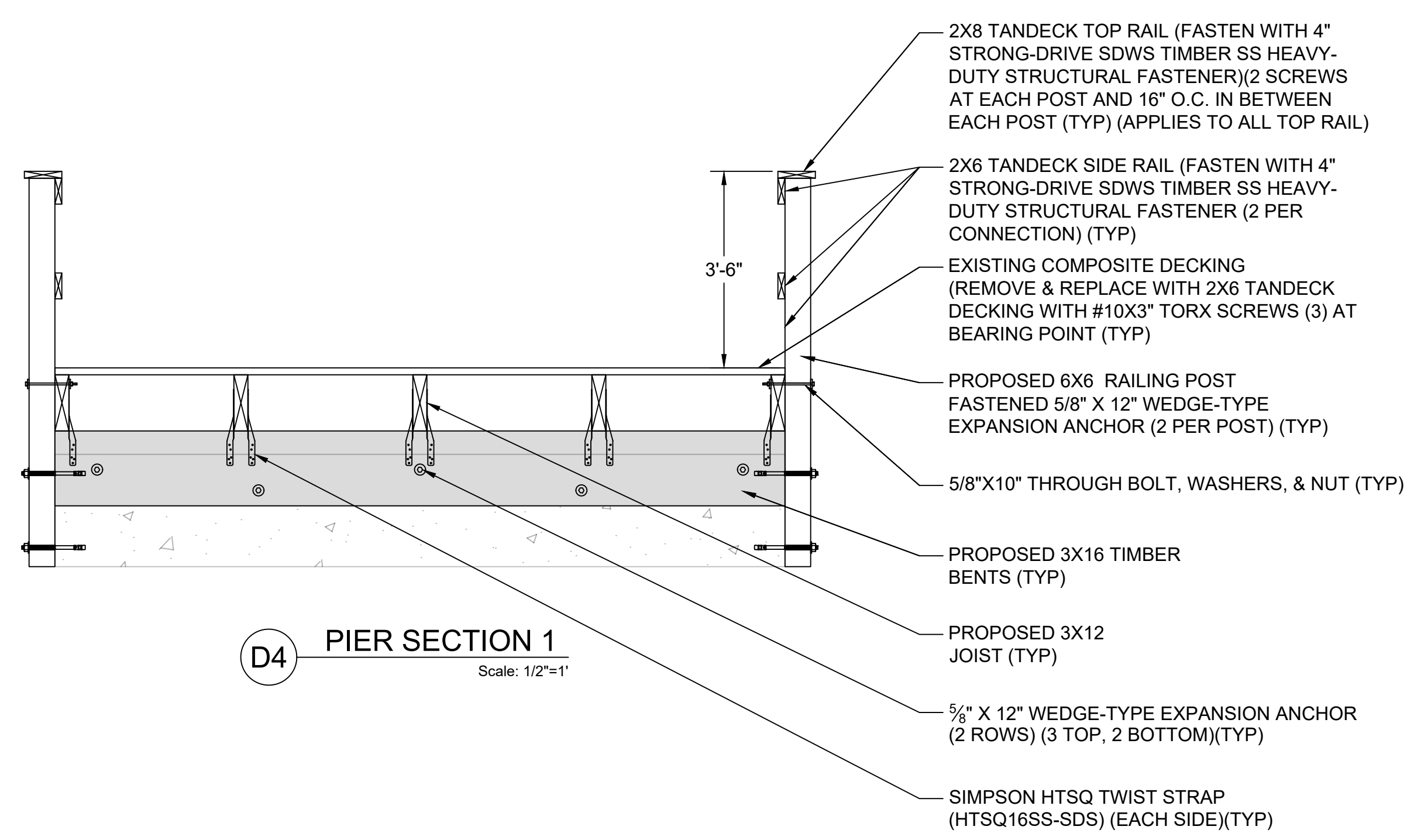
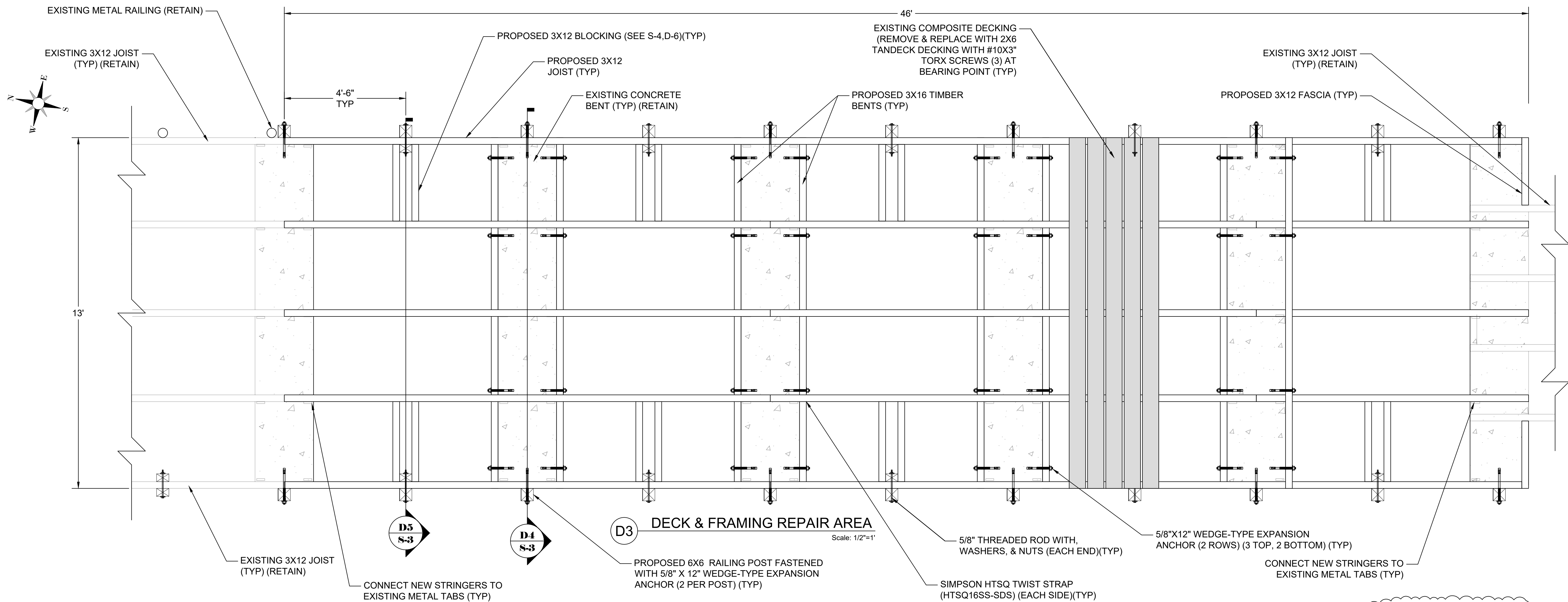

REVISIONS:  
R1 - 5/7/2026 - ADDED CONNECTION DETAIL FOR SIDE AND TOP RAIL TO METAL TUBE.

THIS ITEM HAS BEEN DIGITALLY SIGNED AND SEALED BY CLAY MCCOY P.E. ON THE DATE ADJACENT TO THE SEAL.

SIGNATURE MUST BE VERIFIED ON ANY ELECTRONIC COPIES.

5/17/2026

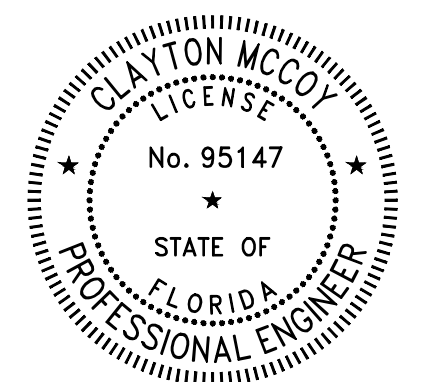

FISHING PIER TEMPORARY REPAIRS PENDING FULL REPLACEMENT

## DETAILS 1

DRAWN BY:  
CLAYTON MCCOY, PE

CHECKED BY:  
ASA HUNT, PE

EOR:  
CLAYTON MCCOY, PE

NO.	DESCRIPTION	DATE



CLAYTON MCCOY, PE  
PE LICENSE NO 95147  
25 W CEDAR ST, SUITE 140  
PENSACOLA, FL 32502

SUBJECT PROPERTY:  
CITY OF SANIBEL  
144 PERIWINKLE WAY  
SANIBEL, FL 33957

PROJECT NO. FL-2026-090	SHEET S-3
DATE 5/17/2026	
1/2"=1' 22x34	
1"=4' 11x17	

# FISHING PIER TEMPORARY REPAIRS PENDING FULL REPLACEMENT

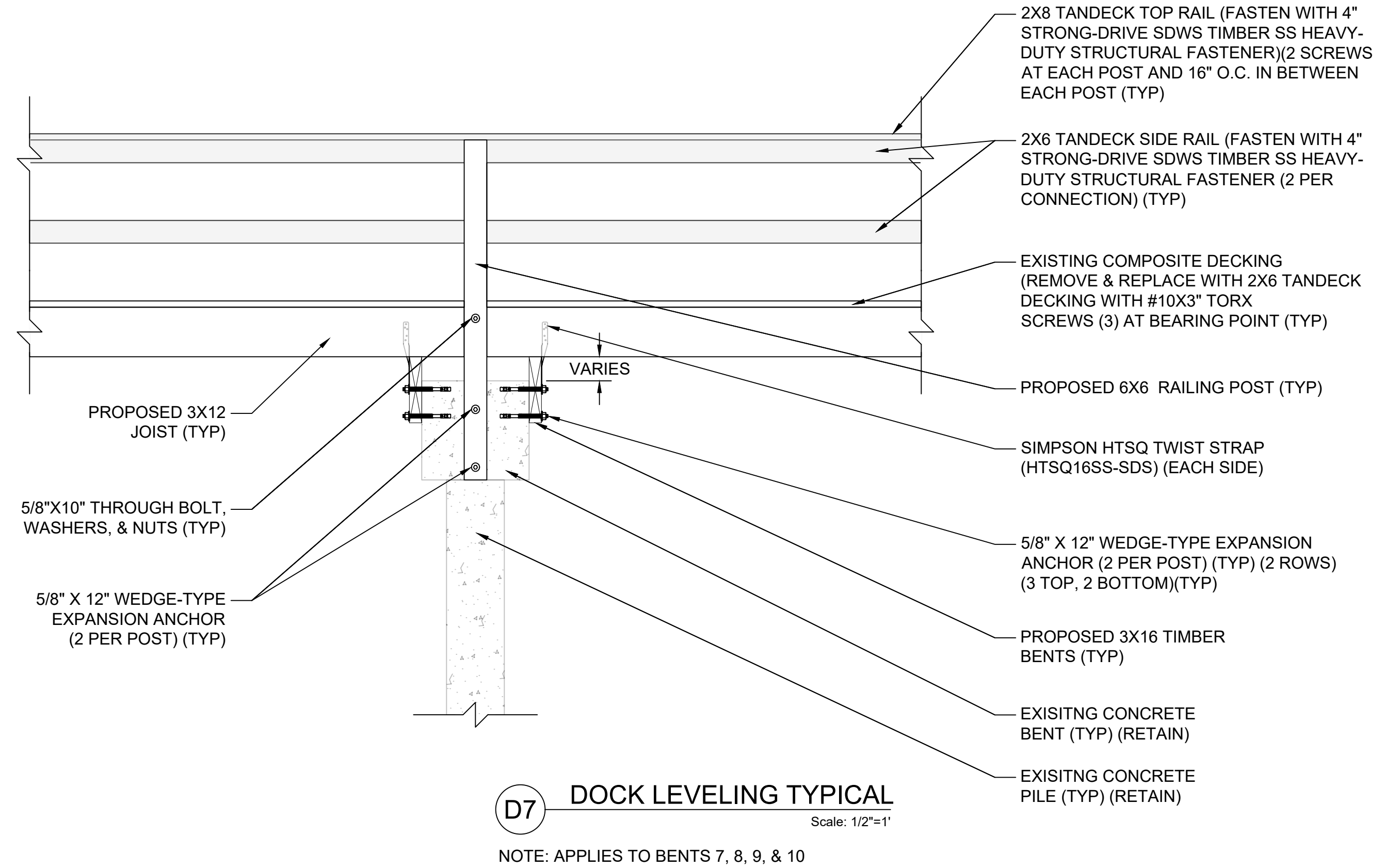
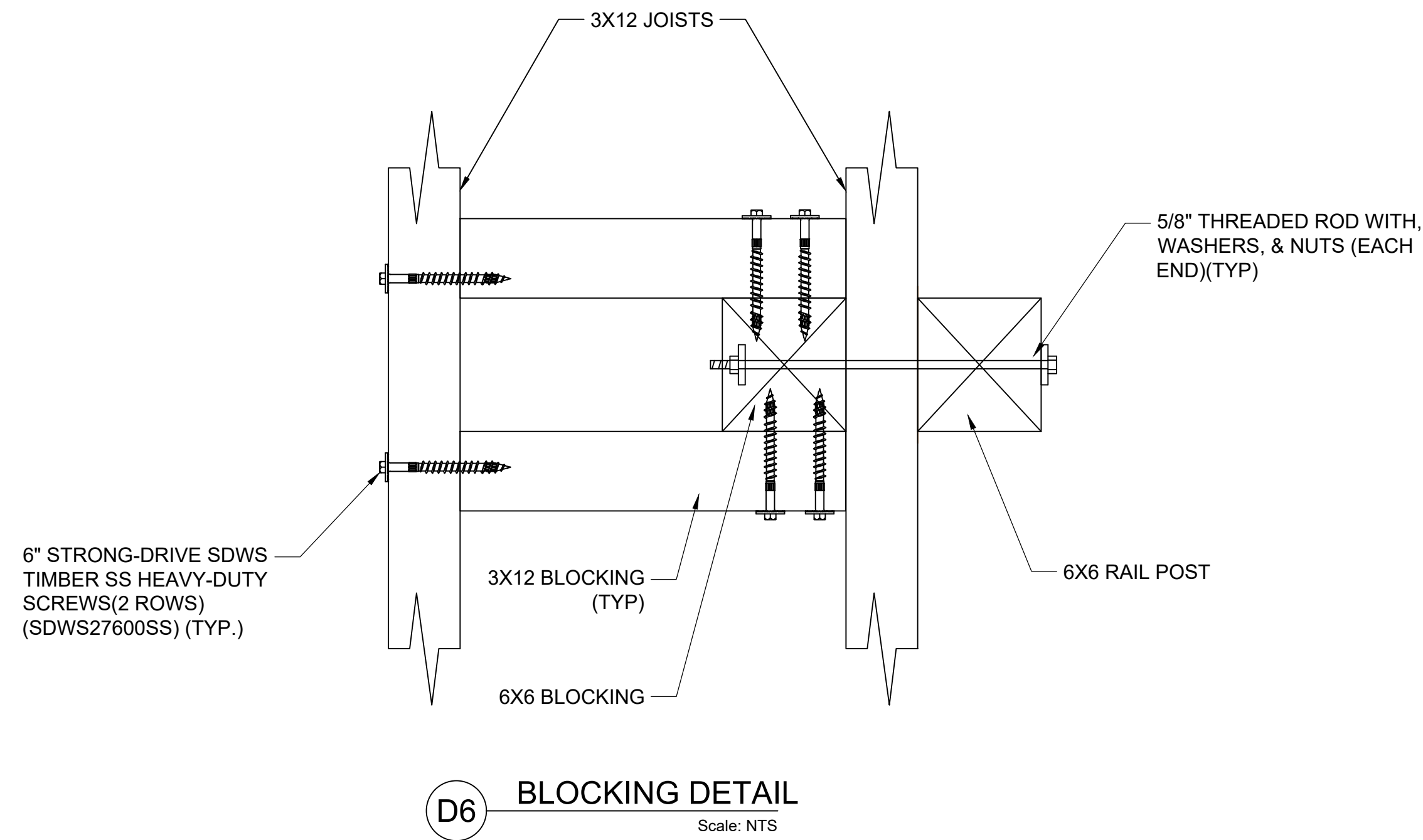

**PROJECT DESCRIPTION:**

THE PROJECT CONSISTS OF REMOVING THE DAMAGED ALUMINUM RAILING AND REPLACING IT WITH A NEW WOOD RAILING SYSTEM. THE EXISTING WOOD SUBSTRUCTURE AND DECKING BETWEEN BENTS 6 THROUGH 11 WILL BE REMOVED AND REPLACED. ALL EXISTING 6X6 POSTS WITHIN THE PROJECT LIMITS SHALL BE REMOVED AND REPLACED WITH NEW TREATED TIMBER POSTS. A NEW ADA-COMPLIANT WOOD ACCESS RAMP WILL BE CONSTRUCTED TO PROVIDE ACCESS TO THE ELEVATION OF THE EXISTING PIER. IN ADDITION, DAMAGED DECKING ON THE TERMINAL PLATFORM WILL BE REPLACED. THE PROJECT ALSO INCLUDES A COMPREHENSIVE INSPECTION OF ALL EXISTING HARDWARE, WITH TIGHTENING OR ADJUSTMENT PERFORMED AS NECESSARY TO ENSURE OVERALL STRUCTURAL INTEGRITY.

**PROJECT NOTES:**

1. THE CONTRACTOR SHALL PROMPTLY NOTIFY THE ENGINEER OF ANY DISCREPANCIES BETWEEN THE DRAWINGS AND SITE CONDITIONS. NO WORK SHOULD PROCEED IF DISCREPANCIES OR OMISSIONS ARE DISCOVERED WITHOUT CONSULTING THE ENGINEER.
2. THE CONTRACTOR IS RESPONSIBLE FOR PROTECTING ADJACENT PROPERTIES, SURFACES, AND PUBLIC AREAS FROM DAMAGE DURING CONSTRUCTION. APPROPRIATE SEDIMENT AND EROSION CONTROL MEASURES MUST BE IMPLEMENTED TO SAFEGUARD THE SURROUNDING ENVIRONMENT, AS REQUIRED BY LOCAL AND STATE REGULATIONS.
3. TURBIDITY BARRIERS SHALL BE PLACED BEFORE CONSTRUCTION BEGINS AND SHALL ONLY BE REMOVED UNTIL AFTER CONSTRUCTION HAS BEEN COMPLETED AND SEDIMENT LOADS RETURN TO AMBIENT LEVELS.
4. NO REVISIONS OR ALTERATIONS MAY BE MADE TO THESE PLANS WITHOUT WRITTEN AUTHORIZATION FROM THE ENGINEER OF RECORD.
5. THE CONTRACTOR SHALL VERIFY ALL DIMENSIONS, DETAILS AND JOB SITE CONDITIONS PRIOR TO COMMENCING WORK AND NOTIFY THE ENGINEER OF RECORD FOR ANY DISCREPANCIES.
6. THE CONTRACTOR SHALL PROVIDE ALL MEASURES NECESSARY TO PROTECT THE STRUCTURE, WORKMEN, AND ALL OTHER PERSONS DURING CONSTRUCTION.
7. THE ENGINEER IS RESPONSIBLE FOR THE STRUCTURAL ITEMS IN THESE PLANS ONLY. SHOULD ANY CHANGES BE MADE FROM THE DESIGN AS SPECIFIED IN THE CALCULATIONS WITHOUT APPROVAL FROM THE ENGINEER (I.E. ALTERATIONS TO THE STRUCTURAL SYSTEM OR ADDITION OF CONSTRUCTION MATERIALS OR LOADS), THE ENGINEER WILL ASSUME NO RESPONSIBILITY FOR ANY ELEMENT OR SYSTEM OF THE STRUCTURE.
8. THE ENGINEER IS RESPONSIBLE FOR THE STRUCTURAL ITEMS IN THESE PLANS ONLY. SHOULD ANY CHANGES BE MADE FROM THE DESIGN AS SPECIFIED IN THE CALCULATIONS WITHOUT APPROVAL FROM THE ENGINEER (I.E. ALTERATIONS TO THE STRUCTURAL SYSTEM OR ADDITION OF CONSTRUCTION MATERIALS OR LOADS), THE ENGINEER WILL ASSUME NO RESPONSIBILITY FOR ANY ELEMENT OR SYSTEM OF THE STRUCTURE.

**SPECIFICATIONS:**

**HARDWARE:**

5/6/2026 R1

1. ALL HARDWARE SHALL BE 316 STAINLESS STEEL UNLESS OTHERWISE NOTED.
2. ALTERNATE BRANDS MAY BE USED IN PLACE OF THOSE LISTED WITHIN THE PLANS, PROVIDED THEY MEET OR EXCEED THE SPECIFIED MINIMUM REQUIREMENTS/SPECIFICATIONS.
3. CONTRACTOR TO INSPECT ALL EXISTING HARDWARE AND TIGHTEN ALL NUTS AND BOLTS ON EXISTING RAILING.
4. ALL METAL CONNECTIONS SHALL COMPLY WITH AISC SPECIFICATIONS AND SHALL BE INSTALLED IN STRICT ACCORDANCE WITH MANUFACTURER'S SPECIFICATIONS AND RECOMMENDATIONS AND THESE DRAWINGS.
5. EXISTING HARDWARE SHALL NOT BE REUSED.
6. ALL ABANDONED OR UNUSED DRILLED HOLES IN EXISTING CONCRETE SHALL BE THOROUGHLY CLEANED OF DUST, DEBRIS, AND LOOSE MATERIAL USING COMPRESSED AIR AND/OR BRUSHING. HOLES SHALL BE FILLED FLUSH WITH THE SURROUNDING SURFACE USING A STRUCTURAL EPOXY ADHESIVE OR EPOXY PATCHING COMPOUND SUITABLE FOR MARINE ENVIRONMENTS. SURFACE PREPARATION SHALL ACHIEVE A MINIMUM ICR CONCRETE SURFACE PROFILE (CSP) OF 3 TO 5, OR AS REQUIRED BY THE EPOXY MANUFACTURER. EPOXY SHALL BE INSTALLED IN STRICT ACCORDANCE WITH THE MANUFACTURER'S RECOMMENDATIONS TO ENSURE A WATER-TIGHT SEAL AND ADEQUATE BOND TO THE EXISTING CONCRETE.
7. ALL ABANDONED OR UNUSED DRILLED HOLES IN EXISTING CONCRETE SHALL BE THOROUGHLY CLEANED OF DUST, DEBRIS, AND LOOSE MATERIAL USING COMPRESSED AIR AND/OR BRUSHING. HOLES SHALL BE FILLED FLUSH WITH THE SURROUNDING SURFACE USING A STRUCTURAL EPOXY ADHESIVE OR EPOXY PATCHING COMPOUND SUITABLE FOR MARINE ENVIRONMENTS. SURFACE PREPARATION SHALL ACHIEVE A MINIMUM ICR CONCRETE SURFACE PROFILE (CSP) OF 3 TO 5, OR AS REQUIRED BY THE EPOXY MANUFACTURER. EPOXY SHALL BE INSTALLED IN STRICT ACCORDANCE WITH THE MANUFACTURER'S RECOMMENDATIONS TO ENSURE A WATER-TIGHT SEAL AND ADEQUATE BOND TO THE EXISTING CONCRETE.

**WOOD TREATMENT LEVEL:**

1. ALL LUMBER SHALL BE PRESSURE TREATED SOUTHERN YELLOW PINE.
2. PILE BENTS & STRINGERS SHALL BE TREATED TO 2.5 CHROMATED COPPER ARSENATE (CCA)
3. RAILING SHALL BE TREATED TO 0.60 COPPER QUAT (ACQ).

**LUMBER SPECIFICATIONS:**

1. ALL PILE BENTS AND STRINGERS SHALL BE ROUGH CUT.
2. RAILING POSTS SHALL BE DIMENSIONAL.
3. RAILING POSTS (6X6) SHALL BE CENTERED ON EACH CONCRETE BENT WITH INTERMEDIATE POSTS (6X6) CENTERED BETWEEN EACH PILE BENT.
4. SPLICES IN BEAMS AND JOISTS ARE NOT ALLOWED BETWEEN SUPPORTS.
5. ALL STRUCTURAL LUMBER SHALL BE #1 GRADE

**DECKING:**

1. DECKING TO BE 2X6 (1-1/2" X 5-1/2") TANDECK COMPOSITE MANUFACTURED BY TANGENT TECHNOLOGIES, LLC. COLOR TO BE SELECTED BY THE CITY.

**UTILITIES:**

1. THE CONTRACTOR MUST VERIFY THE LOCATION OF EXISTING UTILITIES BEFORE BEGINNING ANY EXCAVATION OR CONSTRUCTION ACTIVITIES.
2. ELECTRICAL AND PLUMBING IF REQUIRED TO BE DESIGNED BY OTHERS.

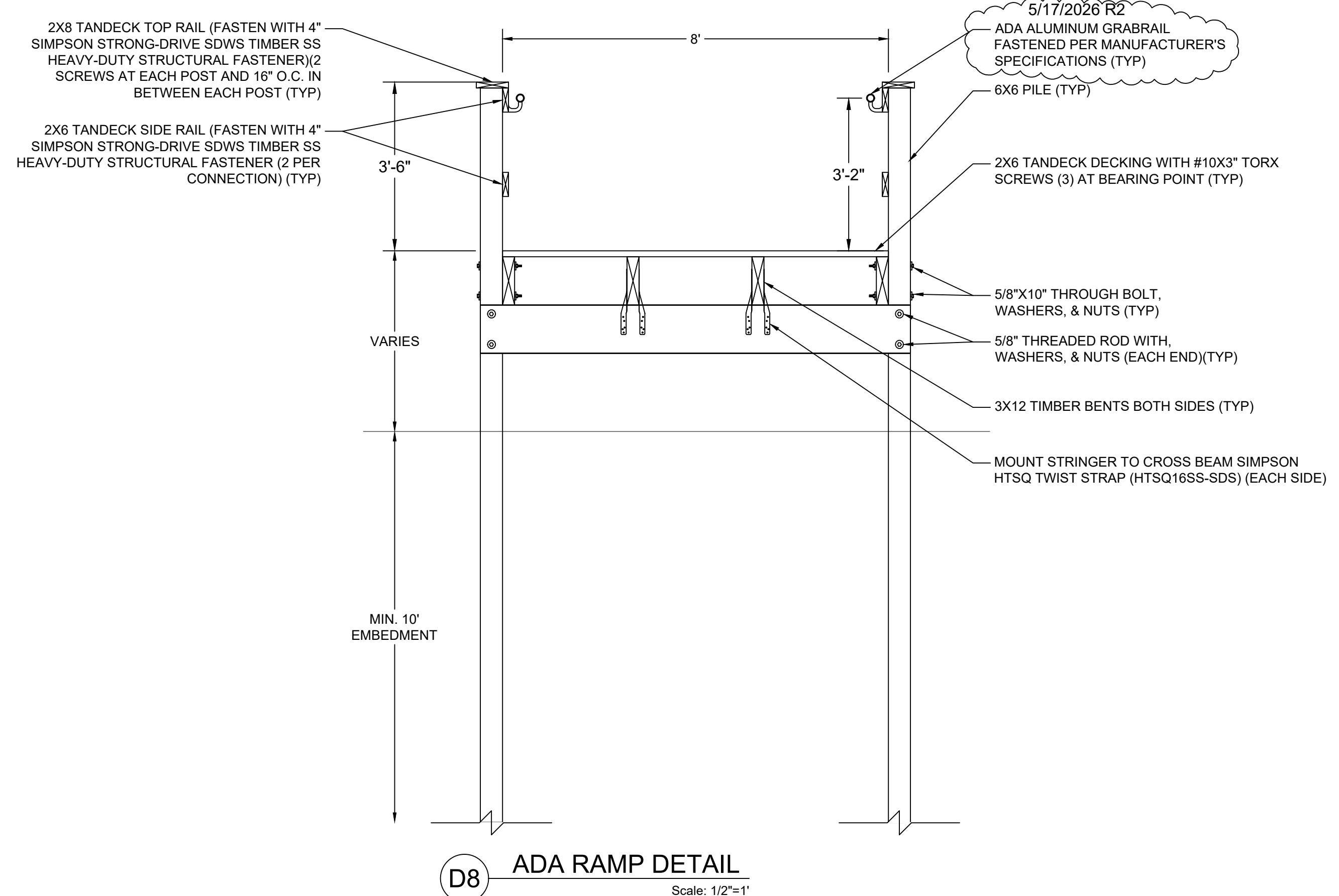

**REVISIONS:**

R1 - 5/7/2026 - CHANGED NOTE

THIS ITEM HAS BEEN DIGITALLY SIGNED AND SEALED BY CLAYTON MCCOY P.E., ON THE DATE ADJACENT TO THE SEAL.

SIGNATURE MUST BE VERIFIED ON ANY ELECTRONIC COPIES.

5/17/2026

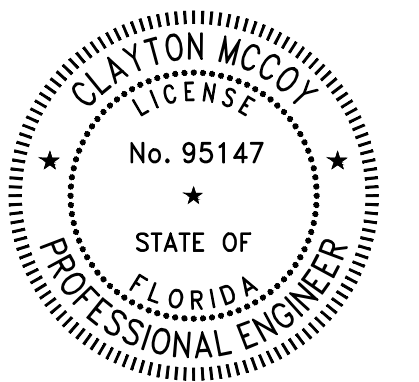

FISHING PIER TEMPORARY REPAIRS PENDING FULL REPLACEMENT

**DETAILS 2**

DRAWN BY:  
CLAYTON MCCOY, PE

CHECKED BY:  
ASA HUNT, PE

EOR:  
CLAYTON MCCOY, PE

NO.	DESCRIPTION	DATE



CLAYTON MCCOY, PE  
PE LICENSE NO 95147  
25 W CEDAR ST, SUITE 140  
PENSACOLA, FL 32502

SUBJECT PROPERTY:  
CITY OF SANIBEL  
144 PERIWINKLE WAY  
SANIBEL, FL 33957

PROJECT NO.  
FL-2026-090

DATE  
5/17/2026

SCALE  
SEE SHEET

SHEET

S-4



CITY OF SANIBEL

FISHING PIER TEMPORARY REPAIRS  
PENDING FULL REPLACEMENT

**BID OPENING**

May 28, 2026 @ 2:30 P.M.

<b>PAY ITEMS</b>						
Item No.	Quantity	Unit	Description	Unit Price (Words)	Unit Price \$ (Figures)	Extended Price \$ (Figures)
1	1	LS	Mobilization/Demobilization (Max 5%)		\$	\$
2	664	SF	Deck Demolition		\$	\$
3	398	LF	Pressure Treated Lumber 3" x 12" 2.5 PCF CCA (Rough Cut)		\$	\$
4	104	LF	Pressure Treated Lumber 3" x 16" 2.5 PCF CCA (Rough Cut)		\$	\$
5	427	LF	6" X 6" Posts/Piles 0.60 PCF ACQ (Dimensional)		\$	\$
6	872	SF	Tandek 2x6 Decking		\$	\$
7	465	LF	Tandek 2X8 Top Rail		\$	\$
8	612	LF	Tandek 2X6 Side Railing		\$	\$
9	1	LS	Existing Railing Hardware Inspection & Tighten All Hardware		\$	\$
10	1	LS	Existing Hardware Replacement		\$	\$
11	1	LS	Materials (Fasteners, Straps, Bolts, Screws, etc.. - 316 Stainless Steel)		\$	\$
12	1	LS	Owner's Contingency		\$ 25,000.00	\$ 25,000.00
13	32	LF	Pressure Treated Lumber "2x8" 2.5 PCF		\$	\$
14	51	LF	Aluminum Grabrail		\$	\$
<b>PROJECT TOTAL</b>						\$