

WATERWAY
10' VINYL REPAIR
w/ CAP

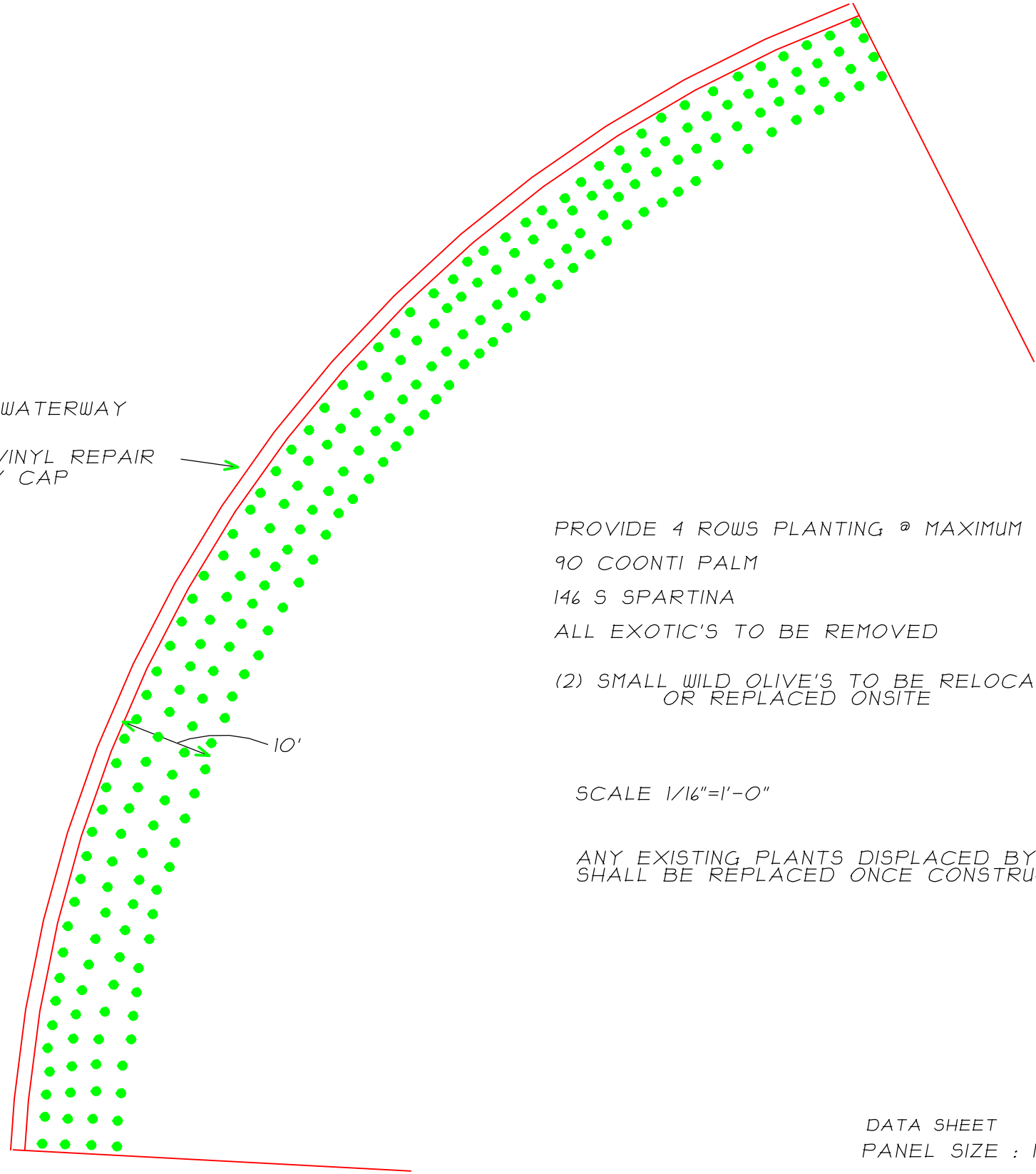

PROVIDE 4 ROWS PLANTING @ MAXIMUM 36" oc
90 COONTI PALM
146 S SPARTINA
ALL EXOTIC'S TO BE REMOVED
(2) SMALL WILD OLIVE'S TO BE RELOCATED
OR REPLACED ONSITE

SCALE 1/16"=1'-0"

ANY EXISTING PLANTS DISPLACED BY CONSTRUCTION
SHALL BE REPLACED ONCE CONSTRUCTION IS COMPLETED

DATA SHEET
PANEL SIZE : 10' VINYL REPAIR
CANAL: "SALTWATER"
1209 ISABEL DR
SANIBEL, FL. 33957
Strap# 18-46-23-T3-00300.022B
SANIBEL HARBOURS Lts 22-23

10/18/2024

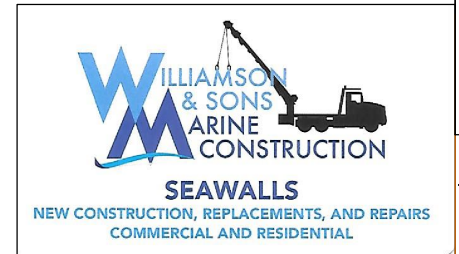

Environmental Enhancement Plan

ENGINEERING & DESIGN CONSULTANTS, INC. P.O.Box 100521 Cape Coral, FL. 33910		3/3
jim@engineeringdesign1.com 239-410-0105		
© Copyright 2021 CA#6178		