

F:\Projects\24_301_2401281_000_Riverview_Chr_at_1517_Periwinkle_Way\FL_GA\Fort Myers\06-CAD\Plans\C4.0_SITE_PLAN.dwg Plotted: Oct 20, 2025 12:22pm by stehhaber

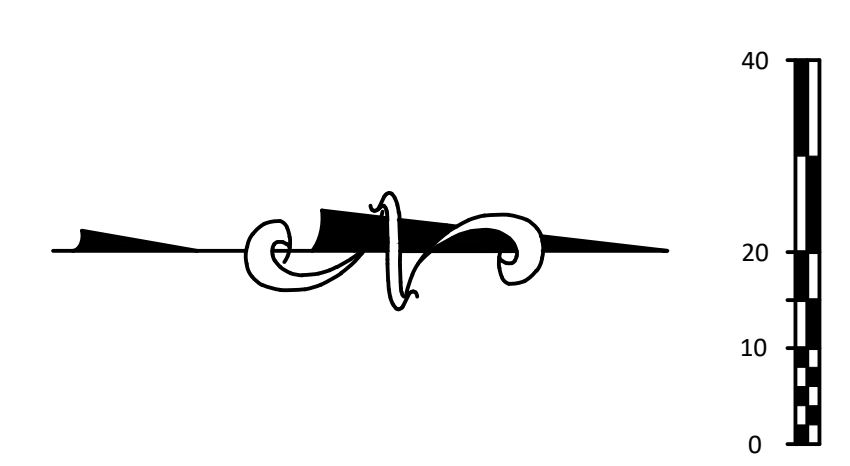
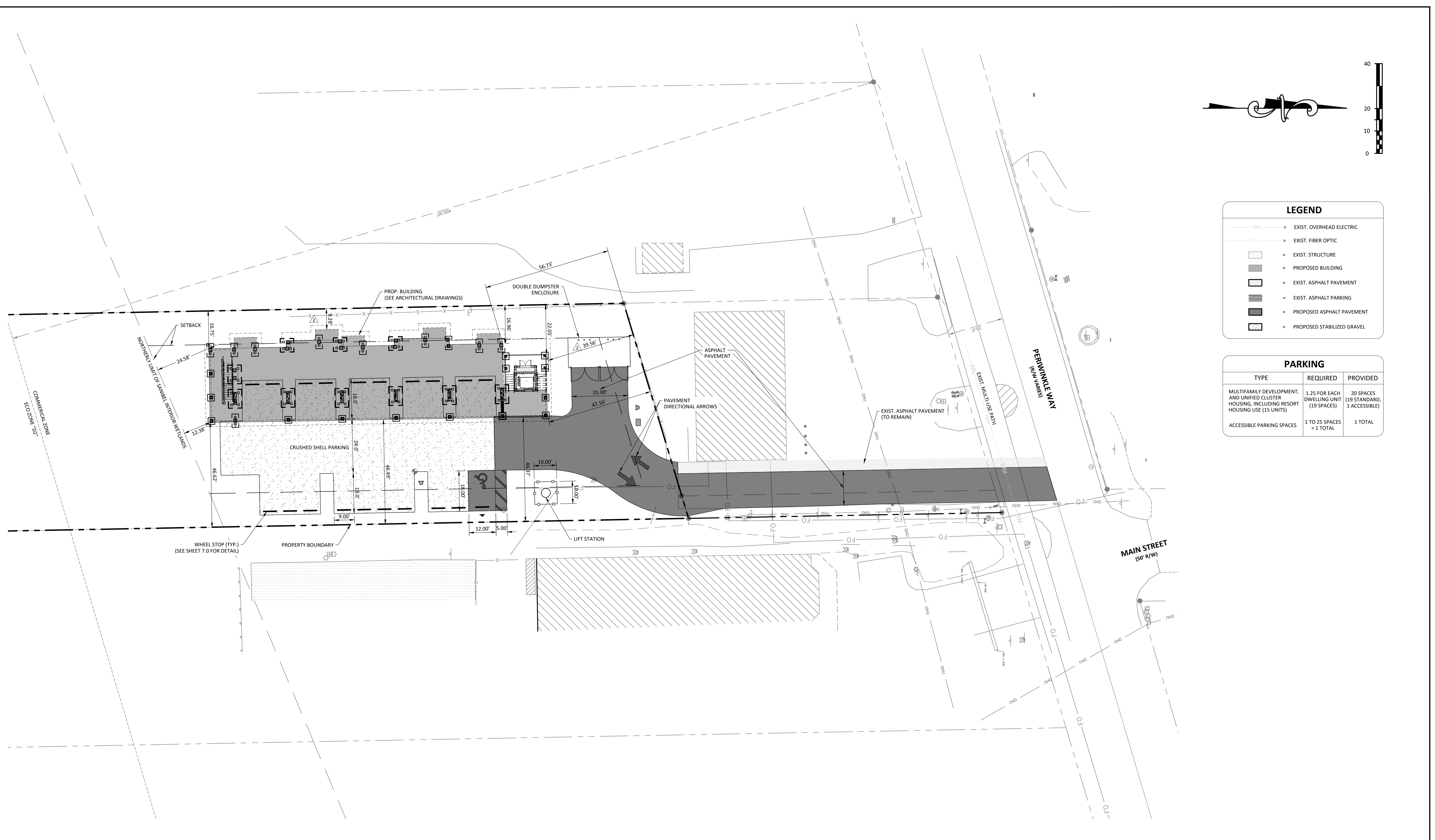

| LEGEND | |
|--------|------------------------------|
| | = EXIST. OVERHEAD ELECTRIC |
| | = EXIST. FIBER OPTIC |
| | = EXIST. STRUCTURE |
| | = PROPOSED BUILDING |
| | = EXIST. ASPHALT PAVEMENT |
| | = EXIST. ASPHALT PARKING |
| | = PROPOSED ASPHALT PAVEMENT |
| | = PROPOSED STABILIZED GRAVEL |

| PARKING | | |
|---|---|---------------------------------------|
| TYPE | REQUIRED | PROVIDED |
| MULTIFAMILY DEVELOPMENT, AND UNIFIED CLUSTER HOUSING, INCLUDING RESORT HOUSING USE (15 UNITS) | 1.25 FOR EACH DWELLING UNIT (19 SPACES) | 20 SPACES (19 STANDARD, 1 ACCESSIBLE) |
| ACCESSIBLE PARKING SPACES | 1 TO 25 SPACES = 1 TOTAL | 1 TOTAL |

| NO. | REVISIONS | DATE | APPROVED BY | SCF |
|-----|--|------------|-------------|-----|
| 1 | REVISED BUILDING FOUNDATION PILE LOCATIONS | 10/20/2025 | | |
| 2 | REVISED BUILDING FOUNDATION PILE LOCATIONS | 09/25/2025 | | |
| 3 | REVISED BUILDING FOUNDATION PILE LOCATIONS | 09/18/2025 | | |

| | |
|-------------|-----|
| DESIGNED BY | SCF |
| DRAWN BY | DZ |
| CHECKED BY | SF |
| APPROVED BY | SCF |

OWNER / DEVELOPER:
COMMUNITY HOUSING AND RESOURCES, INC.
 2340 PERIWINKLE WAY, SUITE K-2
 SANIBEL, FL 33957

DRMP

ENGINEERS • SURVEYORS • PLANNERS • SCIENTISTS

1404 Dean Street Suite 101 - Fort. Myers, Florida 33901
Phone: 239.206.5093 WWW.DRMP.COM

CONSTRUCTION PLANS FOR
RIVERVIEW CHR AT 1517 PERIWINKLE WAY
 LEE COUNTY, FLORIDA
DO NOT SCALE THIS DRAWING - DIMENSIONS AND NOTES TAKE PREFERENCE

SITE PLAN

| | |
|-------------|-----------------|
| PROJECT NO: | 301.2401281.000 |
| DATE: | JANUARY 2025 |
| SCALE: | 1" = 20' |
| SHEET: | C4.0 |

Stephen C. Fehhaber, PE
 Florida P.E. No. 98609