

2330 PALM RIDGE ROAD SITE PLAN SANIBEL, FL

SUITE 1	2627 sq. ft.
SUITE 2	832 sq. ft.
SUITES 3 & 4	1910 sq. ft.
SUITE 5	795 sq. ft.
SUITE 6	1043 sq. ft.
SUITES 7 & 8	2305 sq. ft.
SUITE 9	1321 sq. ft.
SUITES 10 & 11	1400 & 913
SUITES 12, 13, & 14	3025 sq. ft.
SUITE 15	932 sq. ft.
SUITE 16	1545 sq. ft.
SUITE 17	1018 sq. ft.
SUITE 18	1034 sq. ft.

TOTAL AREA 20700 sq. ft.

Prepared exclusively for WT Pearson, Pearson Commercial Real Estate Services, LLC
 ©2018 Precision Floorplans, Inc. This document is the copyright property of Precision Floorplans, Inc.
 Any other user may not copy, modify, reproduce, republish, distribute, display, or transmit for commercial, nonprofit or public purposes all or any portion of this document except to the extent authorized by Precision Floorplans, Inc. (239) 598-9411 precisionfloorplans@earthlink.net
 Copyright infringement (Title 17 Chapter 5 Section 501) in the U.S. Federal Court.
 ALL INFORMATION IS DEEMED RELIABLE NOT GUARANTEED

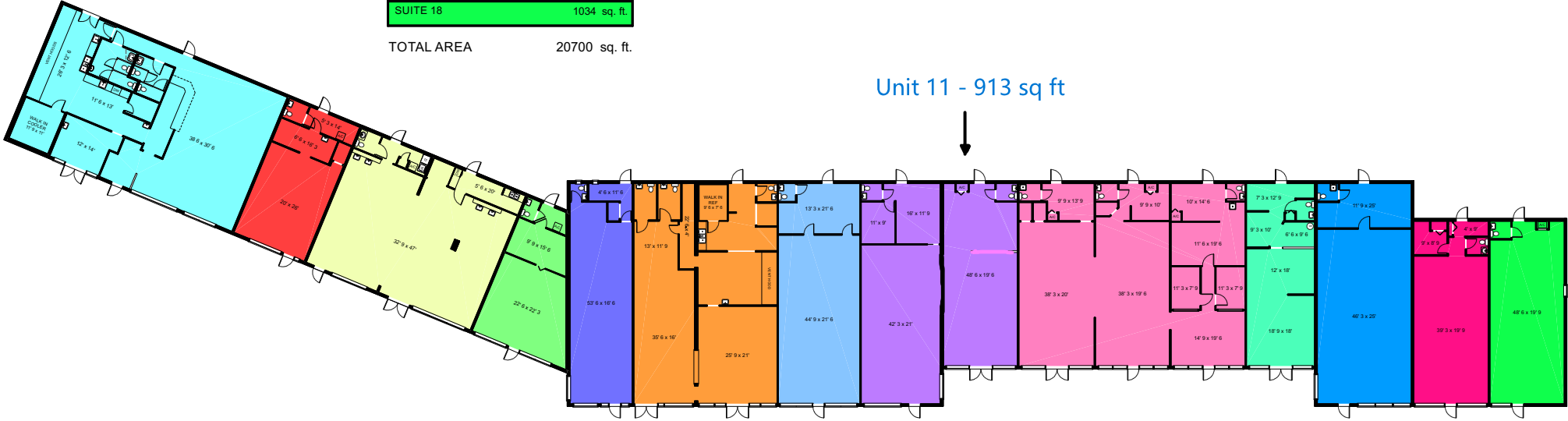

Unit 11 - 913 sq ft